

TITLE: SPECIFICATION CONTROL DRAWING

PART IDENTIFIER: HRMXXXXXXXXWIS

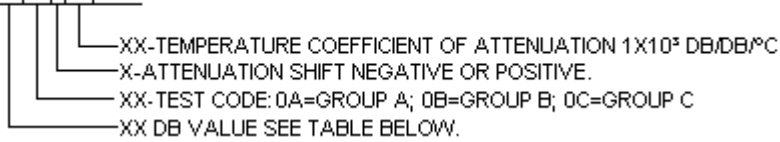

SHIFT (NEG)	DB VALUE	SHIFT (POS)	DB VALUE
-003	1, 2, 3, 4, 5, 6, 7, 8, 10	.003	1, 3, 6
-004	3, 4, 5, 6, 7	.005	1, 3, 6
-005	1,2, 3, 4, 5, 6, 7	.006	1
-006	2, 3, 4, 5, 6	.007	1, 2, 3, 6
-007	1, 2, 3, 4, 5, 6		

DESCRIPTION: TEMPERATURE VARIABLE CHIP ATTENUATOR WITH HIGH RELIABILITY TESTING.

NOTE: SINGLE LOT AND DATE CODE AVAILABLE UPON REQUEST.

ASSEMBLY DWG: N/A

1.0 SPECIFICATIONS:

- 1.1 ELECTRICAL:
 - 1.1.1 IMPEDANCE: 50 OHMS NOMINAL.
 - 1.1.2 OPERATING FREQUENCY RANGE: DC - 12.4GHZ.
 - 1.1.3 ATTENUATION VALUES AVAILABLE: SEE TABLE ABOVE.
 - 1.1.4 ATTENUATION ACCURACY AT 25°C: ±0.5DB @ 1 GHZ.
 - 1.1.5 VSWR: 1.30:1 MAX. @ 1GHZ.
 - 1.1.6 INPUT POWER: 200 MILLIWATTS CW.
 - 1.1.6.1 FULL RATED POWER TO 125°C, DERATED LINEARLY TO 0 WATTS AT 150°C.
 - 1.1.7 TEMPERATURE COEFFICIENT OVER OPERATING TEMPERATURE RANGE: SEE TABLE ABOVE, TEMPERATURE COEFFICIENT TOLERANCE: ±0.001 DB/DB/°C.
- 1.2 MECHANICAL:
 - 1.2.1 OUTLINE DWG: SEE SHEET 2.
 - 1.2.2 WORKMANSHIP: PER MIL-PRF-55342.
- 1.3 ENVIRONMENTAL:
 - 1.3.1 OPERATING TEMPERATURE RANGE: -55°C TO +150°C

2.0 UNIT MARKING: NONE

3.0 QUALITY ASSURANCE:

- 3.1 VERIFY 100% VISUAL PRE-CAP INSPECTION PERFORMED. PER TP-8965.
- 3.2 PERFORM GROUP A, B AND/OR C TESTING AS INDICATED BY THE PART NUMBER PER TP-8965.
- 3.3 TEST DATA REQUIREMENTS:
 - 3.3.1 TEST DATA REQUIRED FOR CUSTOMER - SEE PARAGRAPH 5.0 OF TP-8965.
 - 3.3.2 DATA RETENTION - 24 MONTHS.
 - 3.3.3 TEST SAMPLES REQUIRED FOR CUSTOMER - SEE PARAGRAPH 5.0 OF TP-8965.

4.0 PACKAGING: STANDARD PACK PER 755W002. (SERIALIZED WAFFLE PACK)

EMC TECHNOLOGY 8851 SW OLD KANSAS AVE. STUART, FL 34997	CAGE CODE # 24602		DWG #	1009825000
	CHANGE NOTICE	EN 09-E0458	REV LVL	D
			SHEET	1 <u>OF</u> 2

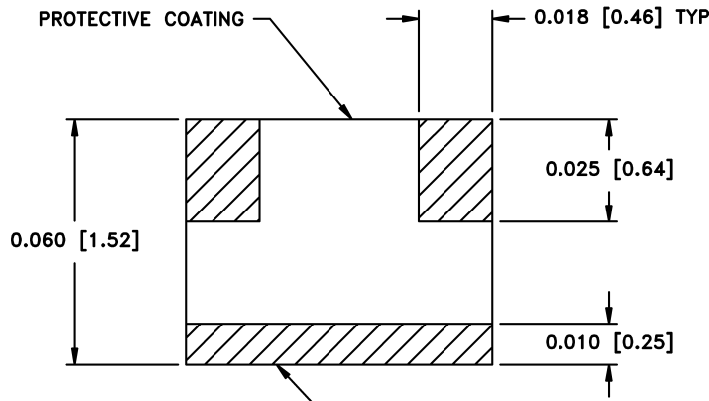

HATCHED AREA REPRESENTS METALIZATION

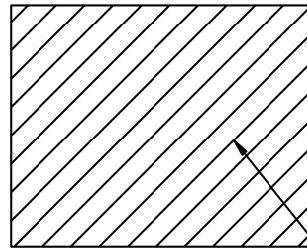
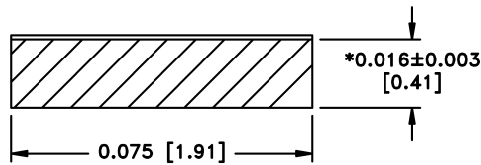

UNITS MARKED ON THIS SURFACE

MECHANICAL SPECIFICATIONS:

SUBSTRATE:
 MATERIAL - ALUMINA 96%, MIL-I-10.
TERMINAL:
 MATERIAL - THICK FILM, NICKEL BARRIER, SOLDER COATED.
RESISTIVE ELEMENT:
 MATERIAL - THICK FILM.

METRIC EQUIVALENTS GIVEN IN [mm] FOR REFERENCE INFORMATION ONLY

* DIMENSIONS APPLY BEFORE SOLDER. ALLOW 0.015 MAX FOR ALL PRETINNED SURFACES.

POWER RATING AND DERATING

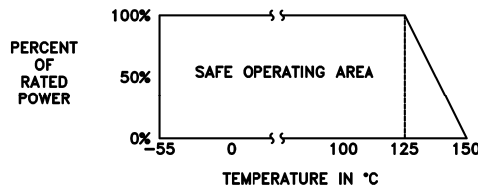

8851 SW OLD KANSAS AVE
 STUART, FL 34997
 PHONE NO. (772)286-9300
 FAX NO. (772)283-5286

UNLESS OTHERWISE SPECIFIED DIMENSIONS ARE IN INCHES

TOLERANCES

FRACT	---
ANG	---
XX	---
XXX	±0.005
XXXX	---

THESE DRAWINGS AND SPECIFICATIONS ARE THE PROPERTY OF EMC TECHNOLOGY INC AND SHALL NOT BE DUPLICATED OR USED AS BASIS FOR THE MANUFACTURE OR SALE OF PARTS OR DEVICES WITHOUT PERMISSION.

CAGE CODE	SCALE	DRAWN BY	CHECKED BY	APPROVED BY
24602	N/A	CRH 05/05/09		DAR 12/8/04
REV	CHANGE NOTICE	DRAWING NO	SHEET	
D	EN 09-E0458	1009825000	2 OF 2	