

WORLDWIDE

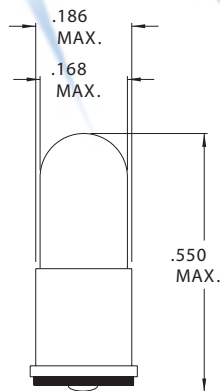

T-1 1/4 Special Midget Flange Base & T-1 1/4 Bi-Pin Base (.100")

**T-1 1/4 Special Midget Flange Base**



Part Number	Design Voltage	Amps	MSCP	Life Hours	Filament Type
CM7302	1.30	.030	.006	100	S-2
CM8636	1.35	.060	.006	500	C-2R
CM8656	2.50	.400	.550	30	C-2R
CM8637	3.00	.190	.250	350	C-2R
CM3518	5.00	.115	.150	40,000	C-2R
CM3582	5.00	.060	.030	60,000	C-2R
CM3585	5.00	.060	.050	25,000	C-2R
CM8541	6.00	.060	.130	3,000	C-2R
CM8628	6.00	.200	.630	1,000	C-2R
CM8551	6.30	.200	.550	5,000	C-2R
CM8646	14.00	.080	.500	1,000	C-2F
CM737	28.00	.050	.300	16,000	C-2F
CM8632	28.00	.040	.320	1,000	C-2F

**T-1 1/4 Bi-Pin Base (.100")**

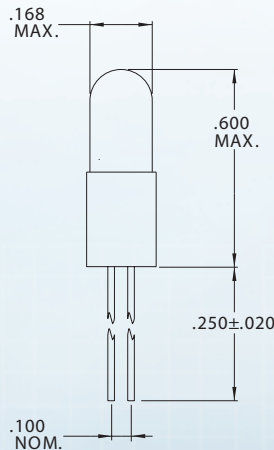

Part Number	Design Voltage	Amps	MSCP	Life Hours	Filament Type
CM7306	1.30	.030	.006	100	S-2
CM7636	1.35	.060	.006	500	C-2R
CM7307	2.50	.400	.550	30	C-2R
CM7637	3.00	.190	.250	350	C-2R
CM7515	5.00	.115	.150	40,000	C-2R
CM7580	5.00	.060	.030	60,000	C-2R
CM7583	5.00	.060	.050	25,000	C-2R
CM7309	6.00	.060	.130	3,000	C-2R
CM7628	6.00	.200	.630	1,000	C-2R
CM7310	6.30	.200	.550	5,000	C-2R
CM7646	14.00	.080	.500	1,000	C-2F
CM7052	28.00	.030	.200	5,000	C-2F
CM7632	28.00	.040	.320	1,000	C-2F



America:  
 CML Innovative Technologies, Inc.  
 147 Central Avenue  
 Hackensack -NJ 07601 -USA  
 Tel:1-201-489 -8989  
 Fax:1-201-489 -6911  
 e-mail:americas@cml-it.com

Europe:  
 CML Technologies GmbH &Co.KG  
 Robert-Bunsen-Str.1  
 67098 Bad Dürkheim -GERMANY  
 Tel:+49 (0)6322 9567-0  
 Fax:+49 (0)6322 9567-88  
 e-mail:europe@cml-it.com

Asia:  
 CML Innovative Technologies, Inc.  
 61 Aida Street  
 Singapore 459975  
 Tel:(65)9630 -5003  
 e-mail:asia@cml-it.com