

AS FILTER CONNECTORS

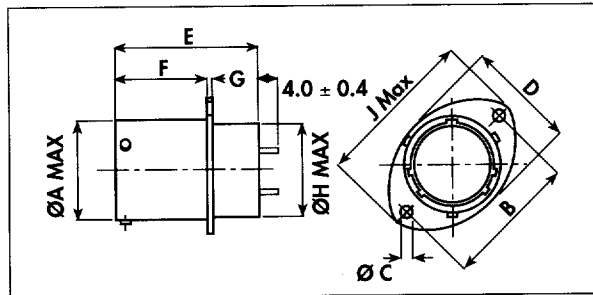
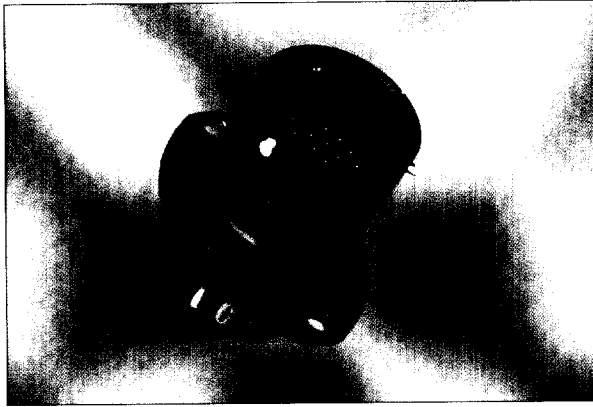

With ever increasing systems and equipment sensitivity, unwanted noise created by ignition and communication systems on race cars can cause the "Black box" designer a real headache.

The Deutsch AS Filter connector range provides a high performance and space saving solution. By placing the filter elements in the "skin" of the equipment the RF window is minimised and RFI / EMI conducted interference is adequately attenuated.

In conjunction with the Autosport industry two values have been determined for optimum performance, namely 5nF 'LC' and 10nF Pi configuration. They are available in #10 thru #18 shell sizes incorporating the -35 high density planforms.

PART NUMBER	SHELL SIZE	NO OF WAYS	FILTER CONFIG	Ø A	B	Ø C ±0.15	D	E	F	G	H	J
ASLDD210-35PN9767	10	13	5nf LC	14.99	25.90	3.25	18.00	34.20	19.45	1.62	14.24	32.00
ASLDD212-35PN9767	12	22	5nf LC	19.04	29.10	3.25	22.50	34.20	19.45	1.62	17.41	35.20
ASLDD214-35PN9767	14	37	5nf LC	22.21	32.50	3.25	25.60	34.20	19.45	1.62	20.57	38.40
ASLDD216-35PN9767	16	55	5nf LC	25.39	34.80	3.25	28.80	34.20	19.45	1.62	23.74	41.00
ASLDD218-35PN9767	18	66	5nf LC	28.56	38.20	3.25	32.00	34.20	19.45	1.62	26.91	44.70
ASDPE210-35PN9767	10	13	10nF Pi	14.99	25.90	3.25	18.00	34.20	19.45	1.62	14.24	32.00
ASDPE212-35PN9767	12	22	10nF Pi	19.04	29.10	3.25	22.50	34.20	19.45	1.62	17.41	35.20
ASDPE214-35PN9767	14	37	10nF Pi	22.21	32.50	3.25	25.60	34.20	19.45	1.62	20.57	38.40
ASDPE216-35PN9767	16	55	10nF Pi	25.39	34.80	3.25	28.80	34.20	19.45	1.62	23.74	41.00
ASDPE218-35PN9767	18	66	10nF Pi	28.56	38.20	3.25	32.00	34.20	19.45	1.62	26.91	44.70

AS FIBRE OPTICS

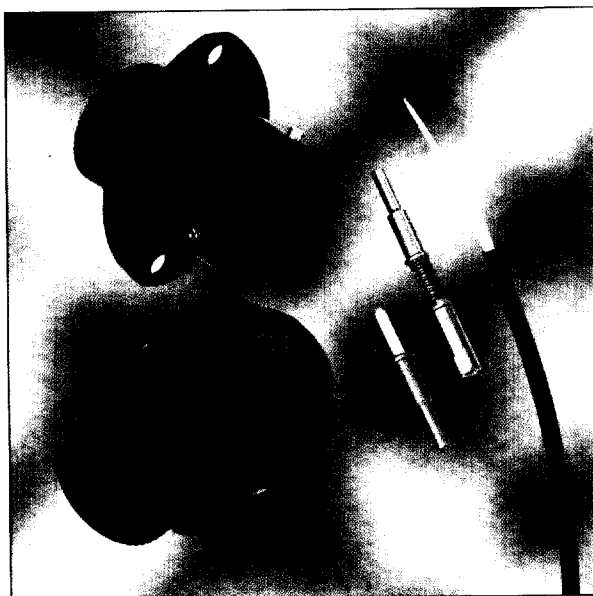

High quality fibre optic contacts are available for any AS Series connector platform having size 16 contact locations, e.g. 12-04, 14-97, 16-08, 20-16, 20-39, 22-21 and 24-29.

The precision ceramic ferruled fibre optic contacts are available for high quality (Aerospace type specification) optic cables and silica glass fibres, enabling high speed, EMI/RFI immune data transmission. The optical contacts are designed to meet MIL - T - 29504/5.

Please consult the sales office for technical details.