

CARD	"A"
-01	1.000
-02	2.000
-03	3.000

PCMT-1XX-XX-X-D-XX-XX-SL-XX

NO OF POSITIONS
-20, -25, -30, -34, -40, -50
(PER ROW)

BODY STYLE
-01: STANDARD
(USE PCMT-XX-D-S-XX-SL)
-02: ELEVATED
(USE PCMT-XX-E-S-XX-SL)

PLATING SPECIFICATION
-L: LIGHT SELECTIVE GOLD
(USE T-1 S1 5-09-L)
-S: SELECTIVE GOLD
(USE T-1 S1 5-09-S)

* = NOT RELEASED

POST OPTION
-SD: STANDARD .120
-BLANK: HOT PLUGGABLE
(34 POS ONLY)

-SL: SOLDER LOCK

CARD LENGTH
-01: 1 INCH
-02: 2 INCH
-03: 3 INCH

TAIL OPTION
-RA: RIGHT ANGLE
* -DH: SURFACE MOUNT (STYLE -01 ONLY)

ROW SPECIFICATION
-D: DOUBLE (USE PCMT-XX-D-X-XX-SL)

DO NOT SCALE FROM THIS PRINT

SECTION "A"-"A"

FIG. 1

PCMT-1XX-01-X-D-DH-02-SL SHOWN

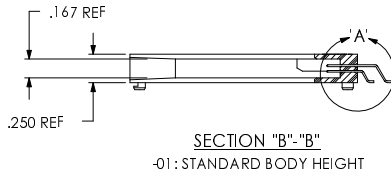
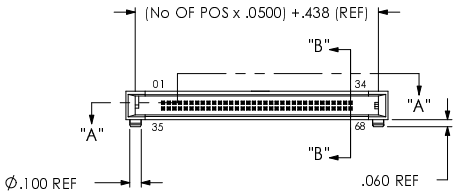

SECTION "B"-"B"
-01: STANDARD BODY HEIGHT

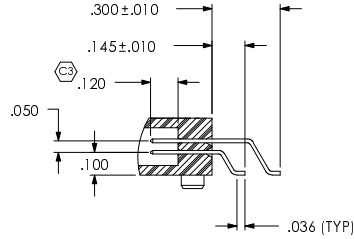
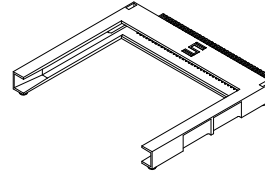

-SD POST OPTION
DETAIL "A"
SCALE 2 : 1.25

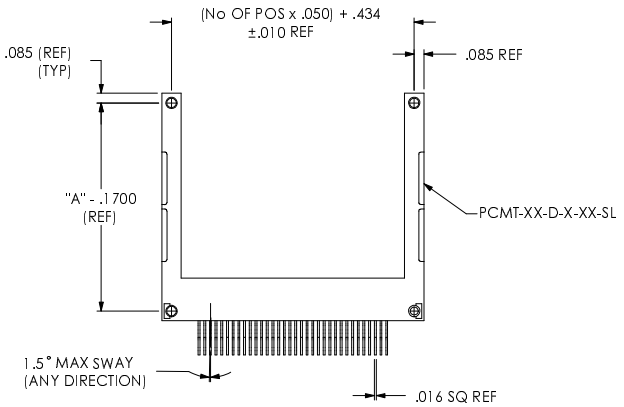

NOTES:

- ⊕ REPRESENTS A CRITICAL DIMENSION.
- COPLANARITY TO BE WITHIN .006.
- BURR ALLOWANCE: .0015 MAX.
- MINIMUM PUSHOUT FORCE: 1 LB.
- MAXIMUM ALLOWABLE BOW: .002 INCH/INCH AFTER ASSEMBLY.
- MAX HEIGHT VARIATION: .005 BETWEEN ROWS.
- PIN 1 AND 2 TO BE FLUSH TO .0030 ABOVE BODY.
- TERMINALS TO BE SHEARED TO OBTAIN DIMENSION SPECIFICATION.
- PARTS TO BE PACKAGED IN TUBES.
- DIMENSION TO BE MEASURED AT BEND.

UNLESS OTHERWISE SPECIFIED, DIMENSIONS ARE IN INCHES. TOLERANCES ARE:

DECIMALS: .XX: ± .01
.XXX: ± .005
.XXXX: ± .0020

ANGLES: 2°

PROPRIETARY NOTE
THIS DOCUMENT CONTAINS INFORMATION CONFIDENTIAL AND PROPRIETARY TO SAMTEC, INC. AND SHALL NOT BE REPRODUCED OR TRANSFERRED TO OTHER DOCUMENTS OR DISCLOSED TO OTHERS OR USED FOR ANY PURPOSE OTHER THAN THAT WHICH IT WAS OBTAINED WITHOUT THE EXPRESSED WRITTEN CONSENT OF SAMTEC, INC.

SAMTEC

520 Park East Blvd. New Albany, IN 47151
Phone (812) 944-6733 Fax (812) 948-5047
e-Mail: INFO@SAMTEC.COM CODE: 55322

MATERIAL: DO NOT SCALE DRAWING
INSULATOR: VECTRA E1301
COLOR: BLACK
TERMINAL: 510 PHOS BRONZE SPRING TEMPER

DESCRIPTION: .050 CARD GUIDE ASSEMBLY

DWG. NO. PCMT-1XX-XX-X-D-XX-XX-XX

BY: DEAN P 2/1/1999 SHEET 1 OF 3

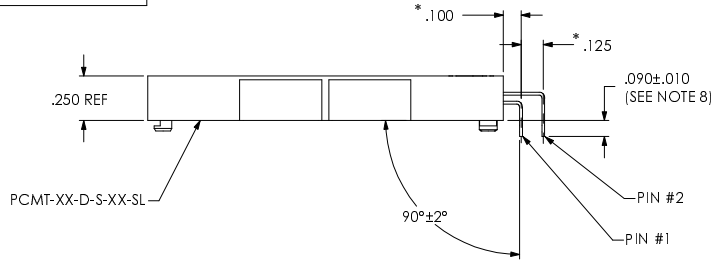

FIG. 3
 STYLE -01, -RA SHOWN
 [DIFFERENT AS SHOWN, OTHERWISE SAME AS FIG. 1]
 USE FOR -SD OR -HP VERSION
 * = SEE NOTE 10

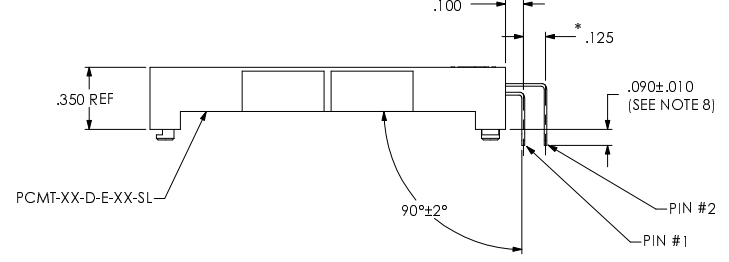
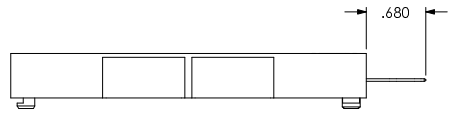
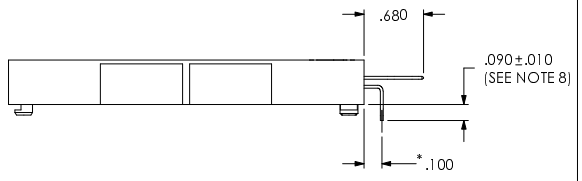

FIG. 4
 STYLE -02, -RA SHOWN
 [DIFFERENT AS SHOWN, OTHERWISE SAME AS FIG. 1]
 USE FOR -SD OR -HP VERSION
 * = SEE NOTE 10

-SD POST OPTION



IN-PROCESS 1: -RA TAIL OPTION
 BODY STYLE -01 & -02



IN-PROCESS 2: -RA TAIL OPTION
 BODY STYLE -01 & -02
 * = SEE NOTE 10

DO NOT SCALE FROM THIS PRINT

<p>PROPRIETARY NOTE THIS DOCUMENT CONTAINS INFORMATION CONFIDENTIAL AND PROPRIETARY TO SAMTEC, INC. AND SHALL NOT BE REPRODUCED OR TRANSMITTED TO OTHER DOCUMENTS OR DISCLOSED TO OTHERS OR USED FOR ANY PURPOSE OTHER THAN THAT WHICH IT WAS OBTAINED WITHOUT THE EXPRESSED WRITTEN CONSENT OF SAMTEC, INC.</p> <p>DO NOT SCALE DRAWING</p> <p>SHEET SCALE 1:25:1</p>	<p>SAMTEC</p> <p>520 Park East Blvd. New Albany, IN 47151 Phone (812) 944-6733 Fax (812) 948-5047 e-Mail: INFO@SAMTEC.COM CODE: 55322</p>	
	<p>DESCRIPTION: .050 CARD GUIDE ASSEMBLY</p>	
<p>DWG. NO. PCMT-1XX-XX-X-D-XX-XX-XX</p>		
<p>BY: DEAN P</p>	<p>2/1/1999</p>	<p>SHEET 2 OF 3</p>

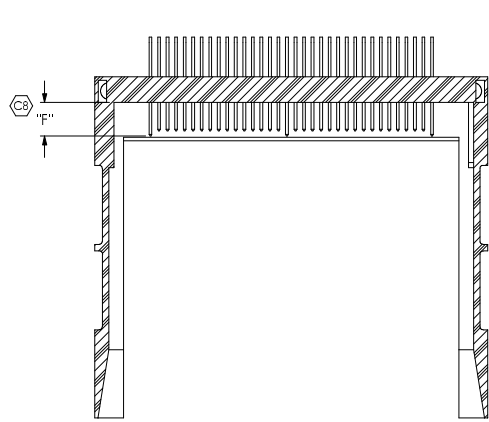

SECTION "C"-"C"

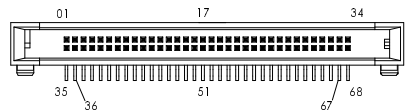
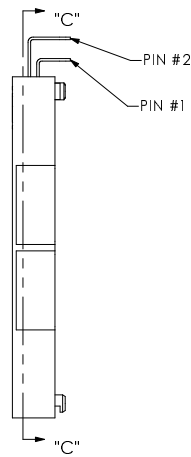

HOT PLUGGABLE

-01 BODY STYLE, -RA TAIL OPTION SHOWN
[-34 POSITION AVAILABLE IN HOT PLUGGABLE ONLY]

POSITION	"F"
36, 67	.138
01, 17, 34, 35, 51, 68	.197
ALL OTHERS	.167

DO NOT SCALE FROM THIS PRINT

* = NOT RELEASED

HOT PLUGGABLE POST OPTION: IN-PROCESSES

IN-PROCESS 1: -RA TAIL OPTION

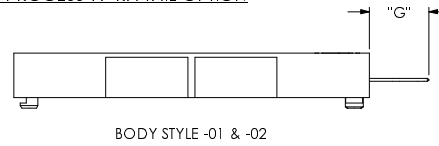

BODY STYLE -01 & -02

IN-PROCESS 2: -RA TAIL OPTION

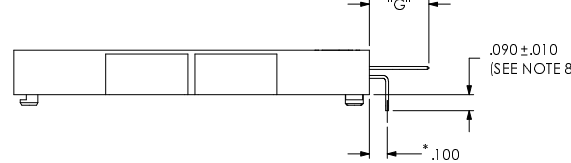

BODY STYLE -01 & -02
* = SEE NOTE 10

STYLE -01-DH: AFTER SHEAR

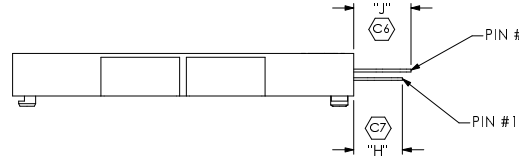

TABLE 5: 34 POSITION ONLY

STYLE	POST ("F")	"G"	"H" (PIN 1)	"J" (PIN 2)
-01-RA	.138	.662	N/A	N/A
	.197	.603	N/A	N/A
	.167	.633	N/A	N/A
-02-RA	.138	.662	N/A	N/A
	.197	.603	N/A	N/A
	.167	.633	N/A	N/A
* -01-DH	.138	.662	.193	.377
	.197	.603	.193	.377
	.167	.633	.193	.377

CARD LENGTH	TUBE	PLUG
-01	PT-1-24-01-81	TP-07
-02	PT-1-24-02-81	TP-07
-03	PT-1-24-03-81	2 TP-07 (per side)

PACKAGING VIEW

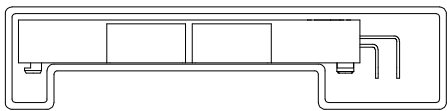

FIG. 6

STYLE -01, -RA SHOWN
[DIFFERENT AS SHOWN, OTHERWISE SAME AS FIG. 1]

F:\D:\WG\SW\Billsprod\ASSEMBLY\050\PCMT-ASM.SLDDRW

PROPRIETARY NOTE
THIS DOCUMENT CONTAINS INFORMATION CONFIDENTIAL AND PROPRIETARY TO SAMTEC, INC. AND SHALL NOT BE REPRODUCED OR TRANSMITTED TO OTHER DOCUMENTS OR DISCLOSED TO OTHERS OR USED FOR ANY PURPOSE OTHER THAN THAT WHICH IT WAS OBTAINED WITHOUT THE EXPRESSED WRITTEN CONSENT OF SAMTEC, INC.

DO NOT SCALE DRAWING

SHEET SCALE 1.2:1

SAMTEC

520 Park East Blvd. New Albany, IN 47151
Phone (812) 944-6733 Fax (812) 948-5047
e-Mail: INFO@SAMTEC.COM CODE: 55322

DESCRIPTION: .050 CARD GUIDE ASSEMBLY

DWG. NO. PCMT-1XX-XX-X-D-XX-XX-XX

BY: DEAN P 2/1/1999 SHEET 3 OF 3