

THIS DRAWING IS UNPUBLISHED. RELEASED FOR PUBLICATION ,19 .  
 © COPYRIGHT 19 BY AMP INCORPORATED. ALL RIGHTS RESERVED.

| LOC |     | DIST        |  | REVISIONS                   |         |      |    |
|-----|-----|-------------|--|-----------------------------|---------|------|----|
| P   | LTR | DESCRIPTION |  | DATE                        | DWN     | APVD |    |
| G   | 14  | F           |  | REDRAWN PER EC 0720-0432-94 | 07NOV94 | LO   | ME |

|                          |                          |                               |
|--------------------------|--------------------------|-------------------------------|
| <b>AMP</b><br>WIRE RANGE | <b>UL</b> E13288         | <b>SR</b> LR7189<br>Certified |
| - -<br>SOLID OR STRANDED | - -<br>SOLID OR STRANDED | - -<br>SOLID OR STRANDED      |

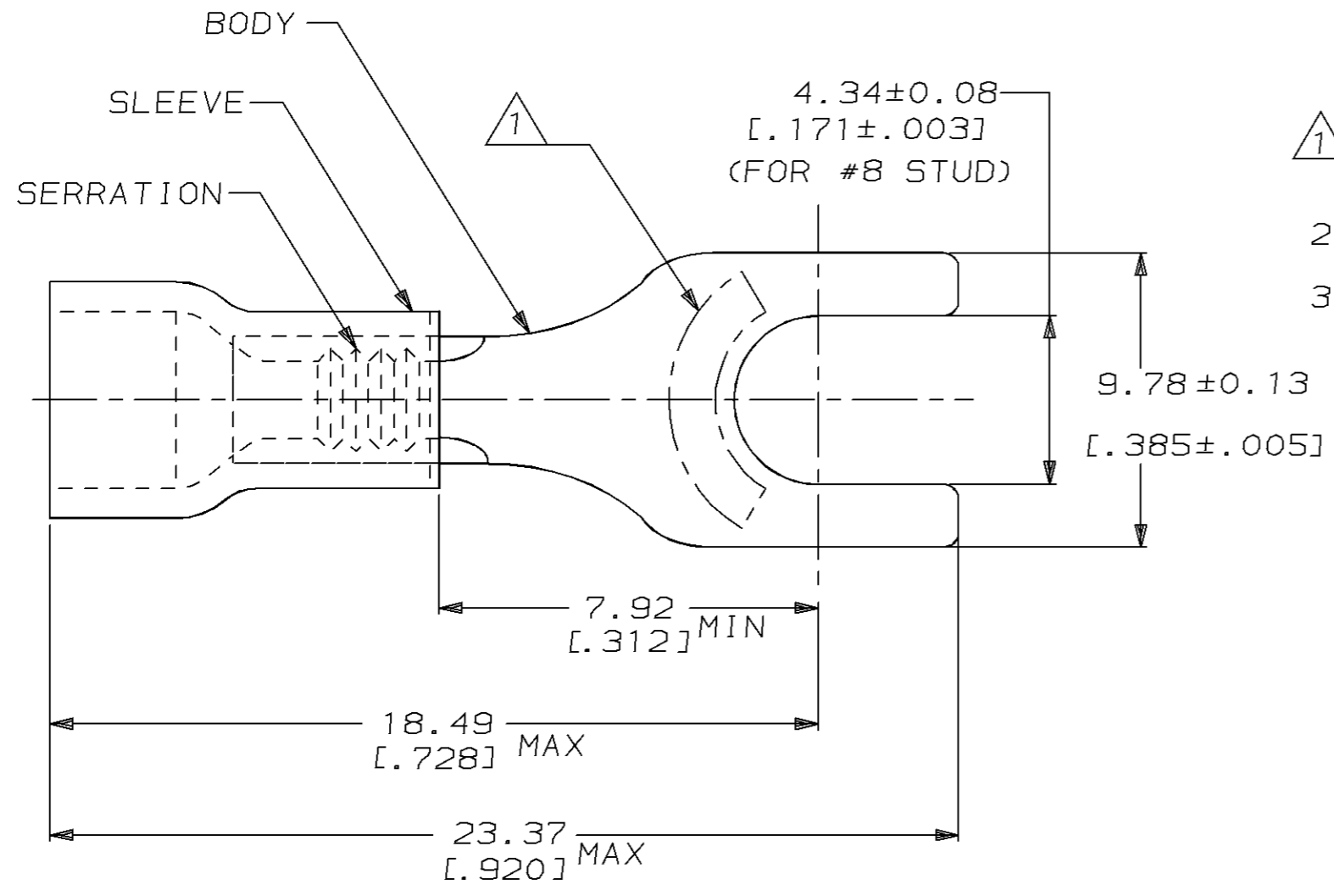

- 1. STAMP AMP 16-14\* LOCATE APPROX AS SHOWN
- 2. WIRE INSUL DIA, 2.92 TO 4.32 [.115 TO .170]
- 3. TONGUE MATL THK, 0.79 ± 0.05 [.031 ± .002]

| QTY  | PACKAGE TYPE     | PART NO   |
|------|------------------|-----------|
| 5    | LOOSE PIECE, BLS | 8-34166-4 |
| 100  | LOOSE PIECE, BOX | 8-34166-1 |
| 5000 | ON TAPE, REEL    | 2-34166-1 |
| 1000 | LOOSE PIECE      | 34166     |

**AMP INCORPORATED**  
**CUSTOMER SERVICE SYSTEM**

FOR ADDITIONAL PRODUCT INFORMATION OR COPIES OF DRAWINGS AND TECHNICAL DOCUMENTS: PRODUCT INFORMATION CENTER 1-800-522-6752

FOR APPLICATION TOOLING INFORMATION: TOOLING ASSISTANCE CENTER 1-800-722-1111

FOR ORDER ENTRY: 1-800-526-5142

MAX RECOMMENDED OPERATING TEMPERATURE:  
 90°C [194°F]

VOLTAGE RATING:  
 600V MAX  
 (1000V FIXTURE OR SIGN)

CIRCULAR MIL AREA:  
 1.04mm<sup>2</sup>-2.62mm<sup>2</sup> [2050-5180]

THIS DRAWING IS A CONTROLLED DOCUMENT FOR AMP INCORPORATED. IT IS SUBJECT TO CHANGE AND THE CONTROLLING ENGINEERING ORGANIZATION SHOULD BE CONTACTED FOR THE LATEST REVISION.

| DIMENSIONS: | TOLERANCES UNLESS OTHERWISE SPECIFIED. |
|-------------|--|
| mm [in]     |  |
|             | 0 PLC ±-                               |
|             | 1 PLC ±-                               |
|             | 2 PLC ±0.20 [.008]                     |
|             | 3 PLC ±-                               |
|             | 4 PLC ±-                               |
|             | ANGLES ±-                              |
|             | FINISH -                               |

MATERIAL: BODY, CU PER ASTM B152; SLEEVE, PVC, BLUE

|                      |  |
|----------------------|--|
| DWN L OLMEDA 03NOV94 | <b>AMP</b> AMP Incorporated<br>Harrisburg, PA 17105-3608 |
| CHK M ELLIS 03NOV94  |  |
| APVD G NGO 03NOV94   |  |
| PRODUCT SPEC UL486A  |  |
| APPLICATION SPEC -   | NAME TERMINAL, SPADE, PLASTI-GRIP, WIRE SIZE, 16-14 AWG  |
| WEIGHT -             | SIZE A3 CAGE CODE 00779 DRAWING NO C-34166               |
| CUSTOMER DRAWING     | SCALE 6:1 SHEET 1 OF 1 REV F                             |