

SD

K-952AJ

REVISIONS

ISSUE	CHANGES
0	ER 37353 MRM 04/22/97

K952AJ2

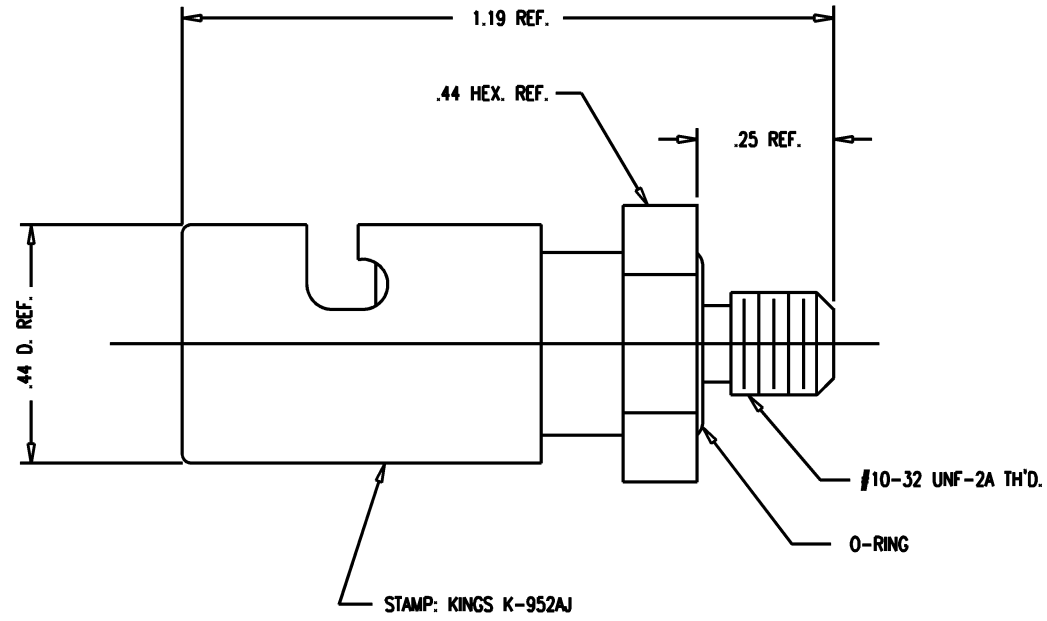

NOTES:

- MATERIALS:
 - STATIONARY CONTACT GRIP-STAINLESS STEEL, 303
 - SLIDING CONTACT GRIP-BRASS, ASTM-B16
 - DISC-BRASS, ASTM-B36
 - SPRING-CORROSION RESISTING STEEL WIRE, QQ-W-423
 - O-RING-SILICONE RUBBER, ZZ-R-765
 - ALL OTHER METAL PARTS-BRASS, ASTM-B16
- FINISHES:
 - ALL METAL PARTS-BLACK NICKEL PLATE

SCALE 4:1

APPROX SURFACE AREA

USED ON

REF: HARRIS DWG. NO. 10372-1204

BINDING POST

DRAWN	MRM	DATE	04/22/97
DESIGN	MRM	DATE	04/22/97
APPR.	FDH	DATE	04/28/97

KINGS
ELECTRONICS CO., INC.
TUCKAHOE, NEW YORK 10707

K-952AJ

SD