



Self-insulated with high dielectric-strength nylon sleeves, these ring terminals are recommended for temperatures up to 105°C. An inner bronze insulation grip sleeve lengthens the flexing radius of the conductor and eliminates conductor creep. The nylon jacket is color-coded:

| Color Code | Wire Range |
|------------|------------|
| yellow     | 26-22      |
| red        | 22-16      |
| blue       | 18-14      |
| yellow     | 12-10      |

Most standard bulk catalog numbers can be put on Mylar Tape for reel fed applications (i.e. 12050 tool and application dies). See pages 190-191.

Please put the suffix M for Mylar Tape RA2573M.

(Bulk number 1000 and 500 packages.)

RZ & RAX stock thickness: .02

RA & RB stock thickness: .03

RC stock thickness: .04

### Nylon Insulated Ring – Insulation Grip

| Cat. No.  | Pkg. Qty. | Wire Range | Max. Ins. | Bolt Hole | Wt./Lbs. Per 1000 | Dimensions |     |     |      |
|-----------|-----------|------------|-----------|-----------|-------------------|------------|-----|-----|------|
|           |           |            |           |           |                   | A          | B   | C   | M    |
| RZ22-2**  | 100       | 26-22      | .083      | #2        | 1                 | .57        | .14 | .13 | .49  |
| RZ22-4**  | 100       | 26-22      | .083      | #4        | 1                 | .65        | .21 | .20 | .54  |
| RZ22-6**  | 100       | 26-22      | .083      | #6        | 1                 | .65        | .21 | .20 | .54  |
| RZ22-8**  | 100       | 26-22      | .083      | #8        | 1                 | .75        | .25 | .23 | .62  |
| RZ22-10** | 100       | 26-22      | .083      | #10       | 1                 | .75        | .25 | .23 | .62  |
| RAX23*    | 1000      | 26-24      | .125      | #2        | 3                 | .66        | .14 | .14 | .59  |
| RAX43*    | 1000      | 26-24      | .125      | #4        | 3                 | .74        | .20 | .19 | .64  |
| RAX63*    | 1000      | 26-24      | .125      | #6        | 3                 | .84        | .25 | .22 | .72  |
| RAX83*    | 1000      | 26-24      | .125      | #8        | 3                 | .84        | .25 | .22 | .72  |
| RAX103*   | 1000      | 26-24      | .125      | #10       | 3                 | .84        | .25 | .24 | .72  |
| RA18-4    | 100       | 22-16      | .136      | #4        | 2                 | .70        | .23 | .14 | .59  |
| RA323     | 1000      | 22-16      | .136      | #4        | 2                 | .70        | .23 | .14 | .59  |
| RA333     | 1000      | 22-16      | .136      | #6        | 2                 | .70        | .23 | .14 | .59  |
| RA18-6    | 100       | 22-16      | .136      | #6        | 2                 | .83        | .26 | .25 | .71  |
| RA853     | 1000      | 22-16      | .136      | #6        | 2                 | .83        | .26 | .25 | .71  |
| RA18-8    | 100       | 22-16      | .136      | #8        | 3                 | .83        | .26 | .25 | .71  |
| RA833     | 1000      | 22-16      | .136      | #8        | 3                 | .83        | .26 | .25 | .71  |
| RA863     | 1000      | 22-16      | .136      | #8        | 3                 | .83        | .26 | .25 | .71  |
| RA18-10   | 100       | 22-16      | .136      | #10       | 2                 | .86        | .31 | .25 | .71  |
| RA873     | 1000      | 22-16      | .136      | #10       | 2                 | .86        | .31 | .25 | .71  |
| RA18-14   | 100       | 22-16      | .136      | 1/4"      | 3                 | 1.07       | .46 | .31 | .84  |
| RA713     | 1000      | 22-16      | .136      | 1/4"      | 3                 | 1.07       | .46 | .31 | .84  |
| RA18-516  | 100       | 22-16      | .136      | 5/16"     | 3                 | 1.07       | .46 | .31 | .84  |
| RA723     | 1000      | 22-16      | .136      | 5/16"     | 3                 | 1.07       | .46 | .31 | .84  |
| RA18-38   | 100       | 22-16      | .136      | 3/8"      | 3                 | 1.17       | .53 | .35 | .87  |
| RA733     | 1000      | 22-16      | .136      | 3/8"      | 3                 | 1.17       | .53 | .35 | .87  |
| RA18-12   | 100       | 22-16      | .136      | 1/2"      | 3                 | 1.27       | .72 | .50 | .92  |
| RA753     | 1000      | 22-16      | .136      | 1/2"      | 3                 | 1.27       | .72 | .50 | .92  |
| RB14-4    | 100       | 18-14      | .162      | #4        | 2-1/2             | .72        | .26 | .14 | .59  |
| RB1323    | 1000      | 18-14      | .162      | #4        | 2-1/2             | .72        | .26 | .14 | .59  |
| RB14-6    | 100       | 18-14      | .162      | #6        | 3                 | .89        | .31 | .25 | .71  |
| RB853     | 1000      | 18-14      | .162      | #6        | 3                 | .89        | .31 | .25 | .71  |
| RB1333    | 1000      | 18-14      | .162      | #6        | 3                 | .74        | .26 | .14 | .59  |
| RB14-8    | 100       | 18-14      | .162      | #8        | 3                 | .89        | .31 | .25 | .71  |
| RB863     | 1000      | 18-14      | .162      | #8        | 3                 | .89        | .31 | .25 | .71  |
| RB14-10   | 100       | 18-14      | .162      | #10       | 3-1/2             | .89        | .31 | .25 | .71  |
| RB873     | 1000      | 18-14      | .162      | #10       | 3-1/2             | .89        | .31 | .25 | .71  |
| RB14-14   | 100       | 18-14      | .162      | 1/4"      | 3-1/2             | 1.08       | .47 | .31 | .81  |
| RB713     | 1000      | 18-14      | .162      | 1/4"      | 3-1/2             | 1.08       | .47 | .31 | .81  |
| RB14-516  | 100       | 18-14      | .162      | 5/16"     | 3-1/2             | 1.08       | .47 | .31 | .84  |
| RB723     | 1000      | 18-14      | .162      | 5/16"     | 3-1/2             | 1.08       | .47 | .31 | .84  |
| RB14-38   | 100       | 18-14      | .162      | 3/8"      | 3-1/2             | 1.17       | .53 | .35 | .87  |
| RB733     | 1000      | 18-14      | .162      | 3/8"      | 3-1/2             | 1.17       | .53 | .35 | .87  |
| RB14-12   | 100       | 18-14      | .162      | 1/2"      | 4                 | 1.25       | .72 | .50 | .90  |
| RB753     | 1000      | 18-14      | .162      | 1/2"      | 4                 | 1.25       | .72 | .50 | .90  |
| RC10-6    | 50        | 12-10      | .210      | #6        | 3                 | 1.00       | .37 | .27 | .81  |
| RC333     | 500       | 12-10      | .210      | #6        | 3                 | 1.00       | .37 | .27 | .81  |
| RC10-8    | 50        | 12-10      | .210      | #8        | 5                 | 1.00       | .37 | .27 | .81  |
| RC863     | 500       | 12-10      | .210      | #8        | 5                 | 1.00       | .37 | .27 | .81  |
| RC10-10   | 50        | 12-10      | .210      | #10       | 5                 | 1.00       | .37 | .27 | .81  |
| RC363     | 500       | 12-10      | .210      | #10       | 5                 | 1.00       | .37 | .27 | .81  |
| RC10-14   | 50        | 12-10      | .210      | 1/4"      | 6                 | 1.12       | .53 | .32 | .86  |
| RC713     | 500       | 12-10      | .210      | 1/4"      | 6                 | 1.12       | .53 | .32 | .86  |
| RC10-516  | 50        | 12-10      | .210      | 5/16"     | 6                 | 1.21       | .53 | .31 | .94  |
| RC703     | 500       | 12-10      | .210      | 5/16"     | 6                 | 1.21       | .53 | .31 | .94  |
| RC10-38   | 50        | 12-10      | .210      | 3/8"      | 6                 | 1.27       | .59 | .35 | .98  |
| RC733     | 500       | 12-10      | .210      | 3/8"      | 6                 | 1.27       | .59 | .35 | .98  |
| RC10-12   | 50        | 12-10      | .210      | 1/2"      | 6                 | 1.37       | .72 | .52 | 1.02 |
| RC753     | 500       | 12-10      | .210      | 1/2"      | 6                 | 1.37       | .72 | .52 | 1.02 |

\* Not Listed By U.L. CSA

\*\* CSA Listed only

U.L. Listed E9809

Installing tools: WT2000, WT112M, WT145C, ERG-2001, ERG-2003, WT145A

Installing tool: WT1452 (RZ series only)

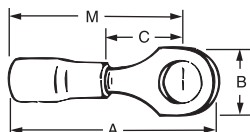



*Catalog numbers with the suffix X indicate an expanded insulation grip. This means a wider wire entry to accommodate heavy wall insulation. Ring terminals won't fall free even if the mounting screw loosens.*

**RB stock thickness: .03**  
**RC stock thickness: .04**

*Most standard bulk catalog numbers can be put on Mylar Tape for reel fed applications (i.e. 12050 tool and application dies). See pages 190-191.*

*Please put the suffix M for Mylar Tape RA2573M. (Bulk number 1000 and 500 packages.)*

### Nylon Insulated Ring – Expanded Insulation Grip

| Cat. No.  | Pkg. Qty. | Wire Range | Max. Ins. | Bolt Hole | Wt./Lbs. Per 1000 | Dimensions |     |     |      |
|-----------|-----------|------------|-----------|-----------|-------------------|------------|-----|-----|------|
|           |           |            |           |           |                   | A          | B   | C   | M    |
| RB14-4X   | 100       | 18-14      | .190      | #4        | 4                 | .80        | .26 | .14 | .67  |
| RB1324    | 1000      | 18-14      | .190      | #4        | 4                 | .80        | .26 | .14 | .67  |
| RB14-6X   | 100       | 18-14      | .190      | #6        | 4                 | .95        | .31 | .25 | .79  |
| RB854     | 1000      | 18-14      | .190      | #6        | 4                 | .95        | .31 | .25 | .79  |
| RB14-8X   | 100       | 18-14      | .190      | #8        | 5                 | .95        | .31 | .25 | .79  |
| RB864     | 1000      | 18-14      | .190      | #8        | 5                 | .95        | .31 | .25 | .79  |
| RB14-10X  | 100       | 18-14      | .190      | #10       | 5                 | .95        | .31 | .25 | .79  |
| RB874     | 1000      | 18-14      | .190      | #10       | 5                 | .95        | .31 | .25 | .79  |
| RB14-14X  | 100       | 18-14      | .190      | 1/4"      | 6                 | 1.16       | .47 | .31 | .92  |
| RB714     | 1000      | 18-14      | .190      | 1/4"      | 6                 | 1.16       | .47 | .31 | .92  |
| RB14-516X | 100       | 18-14      | .190      | 5/16"     | 6                 | 1.16       | .47 | .31 | .92  |
| RB724     | 1000      | 18-14      | .190      | 5/16"     | 6                 | 1.16       | .47 | .31 | .92  |
| RB14-38X  | 100       | 18-14      | .190      | 3/8"      | 6                 | 1.25       | .53 | .42 | .95  |
| RB734     | 1000      | 18-14      | .190      | 3/8"      | 6                 | 1.25       | .53 | .42 | .95  |
| RC10-6X   | 50        | 12-10      | .250      | #6        | 5                 | 1.10       | .37 | .27 | .91  |
| RC334     | 500       | 12-10      | .250      | #6        | 5                 | 1.10       | .37 | .27 | .91  |
| RC10-8X   | 50        | 12-10      | .250      | #8        | 5                 | 1.10       | .37 | .27 | .91  |
| RC864     | 500       | 12-10      | .250      | #8        | 5                 | 1.10       | .37 | .27 | .91  |
| RC10-10X  | 50        | 12-10      | .250      | #10       | 5                 | 1.10       | .37 | .27 | .91  |
| RC364     | 500       | 12-10      | .250      | #10       | 5                 | 1.10       | .37 | .27 | .91  |
| RC10-14X  | 50        | 12-10      | .250      | 1/4"      | 6                 | 1.22       | .53 | .32 | .96  |
| RC714     | 500       | 12-10      | .250      | 1/4"      | 6                 | 1.22       | .53 | .32 | .96  |
| RC10-516X | 50        | 12-10      | .250      | 5/16"     | 6                 | 1.32       | .53 | .31 | 1.05 |
| RC704     | 500       | 12-10      | .250      | 5/16"     | 6                 | 1.32       | .53 | .31 | 1.05 |
| RC10-38X  | 50        | 12-10      | .250      | 3/8"      | 6                 | 1.38       | .59 | .48 | 1.09 |
| RC734     | 500       | 12-10      | .250      | 3/8"      | 6                 | 1.38       | .59 | .48 | 1.09 |
| RC10-12X  | 50        | 12-10      | .250      | 1/2"      | 6                 | 1.48       | .72 | .52 | 1.13 |

U.L. Listed E9809

Installing tools: WT2000, WT112M, WT145C, ERG-2001, ERG-2003, WT145A

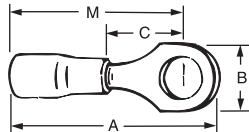

# Sta-Kon® Terminals



*These ring terminals are self-insulated with heat shrinkable polyolefin and internally coated sealant. Upon completed installation, a fully sealed connection is achieved to protect the joint against the degrading effects of galvanic action, corrosion, and environmental exposure.*

*RAS & RBS stock thickness: .03  
RCS stock thickness: .04*

## Heat Shrinkable Ring Terminals – Expanded Insulation Support

| Cat. No.         | Pkg. Qty. | Wire Range | Max. Ins. | Bolt Hole | Wt./Lbs. Per 1000 | Dimensions |     |     |      |
|------------------|-----------|------------|-----------|-----------|-------------------|------------|-----|-----|------|
|                  |           |            |           |           |                   | A          | B   | C   | M    |
| <b>RAS18-6X</b>  | 100       | 22-18      | .170      | #6        | 2                 | 1.23       | .25 | .27 | 1.10 |
| <b>RAS18-8X</b>  | 100       | 22-18      | .170      | #8        | 3                 | 1.26       | .31 | .27 | 1.10 |
| <b>RAS18-10X</b> | 100       | 22-18      | .170      | #10       | 2                 | 1.26       | .31 | .27 | 1.10 |
| <b>RBS14-6X</b>  | 100       | 16-14      | .200      | #6        | 3                 | 1.23       | .25 | .27 | 1.10 |
| <b>RBS14-8X</b>  | 100       | 16-14      | .200      | #8        | 3                 | 1.23       | .25 | .27 | 1.10 |
| <b>RBS14-10X</b> | 100       | 16-14      | .200      | #10       | 3-1/2             | 1.26       | .31 | .27 | 1.10 |
| <b>RCS10-6X</b>  | 50        | 12-10      | .250      | #6        | 3                 | 1.34       | .31 | .27 | 1.15 |
| <b>RCS10-8X</b>  | 50        | 12-10      | .250      | #8        | 5                 | 1.34       | .37 | .27 | 1.15 |
| <b>RCS10-10X</b> | 50        | 12-10      | .250      | #10       | 5                 | 1.34       | .37 | .27 | 1.15 |
| <b>RCS10-14X</b> | 50        | 12-10      | .250      | 1/4"      | 6                 | 1.34       | .49 | .32 | 1.15 |

U.L. Listed E9809

Installing tool: WT1255

Note: Not available on Mylar Tape.

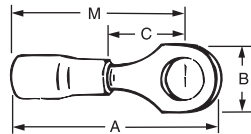

# Sta-Kon® Terminals



\* (Chamfered Funnel)

RD, RE, RF stock thickness: .04  
RG stock thickness: .05\*

## Nylon Insulated Ring

| Cat. No. | Pkg. Qty. | Wire Range | Max. Ins. | Bolt Hole | Wt./Lbs. Per 1000 | Dimensions |     |     |      |
|----------|-----------|------------|-----------|-----------|-------------------|------------|-----|-----|------|
|          |           |            |           |           |                   | A          | B   | C   | M    |
| *RD167   | 200       | 8          | .340      | #8        | 12                | 1.48       | .42 | .28 | 1.29 |
| *RD8-10  | 25        | 8          | .340      | #10       | 12                | 1.48       | .42 | .28 | 1.29 |
| *RD367   | 200       | 8          | .340      | #10       | 12                | 1.48       | .42 | .28 | 1.29 |
| *RD8-14  | 25        | 8          | .340      | 1/4"      | 12                | 1.54       | .46 | .36 | 1.32 |
| *RD717   | 200       | 8          | .340      | 1/4"      | 12                | 1.54       | .46 | .36 | 1.32 |
| *RD8-516 | 25        | 8          | .340      | 5/16"     | 12                | 1.63       | .57 | .36 | 1.35 |
| *RD727   | 200       | 8          | .340      | 5/16"     | 12                | 1.63       | .57 | .36 | 1.35 |
| *RD8-38  | 25        | 8          | .340      | 3/8"      | 12                | 1.63       | .57 | .36 | 1.35 |
| *RD737   | 200       | 8          | .340      | 3/8"      | 12                | 1.63       | .57 | .36 | 1.35 |
| *RD8-12  | 25        | 8          | .310      | 1/2"      | 12                | 1.79       | .82 | .55 | 1.39 |
| *RD757*  | 200       | 8          | .310      | 1/2"      | 12                | 1.79       | .82 | .55 | 1.39 |
| RD10161  | 200       | 8AN        | .270      | #8        | 12                | 1.40       | .41 | .24 | 1.20 |
| RD10361  | 200       | 8AN        | .270      | #10       | 12                | 1.40       | .41 | .24 | 1.20 |
| RD10711  | 200       | 8AN        | .270      | 1/4"      | 12                | 1.45       | .45 | .34 | 1.22 |
| RD10721  | 200       | 8AN        | .270      | 5/16"     | 12                | 1.53       | .56 | .34 | 1.25 |
| RD10731  | 200       | 8AN        | .270      | 3/8"      | 12                | 1.53       | .56 | .34 | 1.25 |
| *RE6-10  | 20        | 6          | .420      | #10       | 16                | 1.65       | .49 | .28 | 1.40 |
| *RE267   | 200       | 6          | .420      | #10       | 16                | 1.65       | .49 | .28 | 1.40 |
| *RE6-14  | 20        | 6          | .420      | 1/4"      | 16                | 1.65       | .49 | .28 | 1.40 |
| *RE717   | 200       | 6          | .420      | 1/4"      | 16                | 1.65       | .49 | .28 | 1.40 |
| *RE6-516 | 20        | 6          | .420      | 5/16"     | 16                | 1.76       | .61 | .34 | 1.47 |
| *RE727   | 200       | 6          | .420      | 5/16"     | 16                | 1.76       | .61 | .34 | 1.47 |
| *RE6-38  | 20        | 6          | .420      | 3/8"      | 16                | 1.76       | .61 | .34 | 1.47 |
| *RE737   | 200       | 6          | .420      | 3/8"      | 16                | 1.76       | .61 | .34 | 1.47 |
| *RE6-12  | 20        | 6          | .395      | 1/2"      | 16                | 1.83       | .82 | .55 | 1.43 |
| *RE757*  | 200       | 6          | .395      | 1/2"      | 16                | 1.83       | .82 | .55 | 1.43 |
| RE10261  | 200       | 6AN        | .315      | #10       | 16                | 1.55       | .49 | .24 | 1.31 |
| RE10711  | 200       | 6AN        | .315      | 1/4"      | 16                | 1.55       | .49 | .27 | 1.31 |
| RE10721  | 200       | 6AN        | .315      | 5/16"     | 16                | 1.70       | .60 | .34 | 1.40 |
| RE10731  | 200       | 6AN        | .315      | 3/8"      | 16                | 1.70       | .60 | .34 | 1.40 |
| *RF4-10  | 15        | 4          | .510      | #10       | 21                | 1.76       | .56 | .36 | 1.49 |
| *RF267   | 100       | 4          | .510      | #10       | 21                | 1.76       | .56 | .36 | 1.49 |
| *RF4-14  | 15        | 4          | .510      | 1/4"      | 21                | 1.76       | .56 | .36 | 1.49 |
| *RF717   | 100       | 4          | .510      | 1/4"      | 21                | 1.76       | .56 | .36 | 1.49 |
| *RF4-516 | 15        | 4          | .510      | 5/16"     | 21                | 1.84       | .62 | .35 | 1.53 |
| *RF727   | 100       | 4          | .510      | 5/16"     | 21                | 1.84       | .62 | .35 | 1.53 |
| *RF4-38  | 15        | 4          | .510      | 3/8"      | 23                | 1.84       | .62 | .35 | 1.53 |
| *RF737   | 100       | 4          | .510      | 3/8"      | 23                | 1.84       | .62 | .35 | 1.53 |
| *RF757*  | 100       | 4          | .500      | 1/2"      | 23                | 1.90       | .82 | .55 | 1.49 |
| RF10261  | 100       | 4AN        | .380      | #10       | 26                | 1.78       | .55 | .30 | 1.51 |
| RF10711  | 100       | 4AN        | .380      | 1/4"      | 26                | 1.78       | .55 | .30 | 1.51 |
| RF10721  | 100       | 4AN        | .380      | 5/16"     | 26                | 1.80       | .62 | .34 | 1.49 |
| RF10731  | 100       | 4AN        | .380      | 3/8"      | 26                | 1.80       | .62 | .34 | 1.49 |
| *RG2-10  | 10        | 2          | .588      | #10       | 42                | 2.15       | .69 | .40 | 1.83 |
| *RG267   | 50        | 2          | .588      | #10       | 42                | 2.15       | .69 | .40 | 1.83 |
| *RG2-14  | 10        | 2          | .588      | 1/4"      | 42                | 2.15       | .69 | .40 | 1.83 |
| *RG717   | 50        | 2          | .588      | 1/4"      | 42                | 2.15       | .69 | .40 | 1.83 |
| *RG2-516 | 10        | 2          | .588      | 5/16"     | 42                | 2.15       | .69 | .40 | 1.83 |
| *RG727   | 50        | 2          | .588      | 5/16"     | 42                | 2.15       | .69 | .40 | 1.83 |
| *RG2-38  | 10        | 2          | .588      | 3/8"      | 42                | 2.15       | .69 | .40 | 1.83 |
| *RG737   | 50        | 2          | .588      | 3/8"      | 42                | 2.15       | .69 | .40 | 1.83 |
| *RG2-12  | 10        | 2          | .588      | 1/2"      | 42                | 2.35       | .80 | .49 | 1.93 |
| *RG757   | 50        | 2          | .588      | 1/2"      | 42                | 2.35       | .80 | .49 | 1.93 |
| RG9711   | 50        | 2AN        | .453      | 1/4"      | 48                | 2.07       | .69 | .40 | 1.74 |
| RG9731   | 50        | 2AN        | .453      | 3/8"      | 48                | 2.07       | .69 | .40 | 1.74 |
| RG9751   | 100       | 2AN        | .453      | 1/2"      | 48                | 2.26       | .80 | .49 | 1.84 |

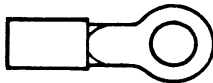

\*Brazed Seam, Lolly-Pop Style Tongue.

AN – Aircraft Wire. U.L. Listed E9809. Installing tools: TBM6/TBM6S, ERG-2007, (RD & RE Except Brazed Seam)

Note: Not available on Mylar Tape.

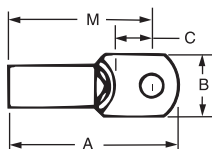



**Stock Thickness:**

- RH = .05**
- RJ = .06**
- RK = .06**
- RL = .07**
- RM = .07**

**Nylon Insulated Ring – continued**

| Cat. No.      | Pkg. Qty. | Wire Range | Max. Ins. | Bolt Hole | Wt./Lbs. Per 1000 | Dimensions |      |     |      |
|---------------|-----------|------------|-----------|-----------|-------------------|------------|------|-----|------|
|               |           |            |           |           |                   | A          | B    | C   | M    |
| <b>RH9711</b> | 100       | 1AN        | .500      | 1/4"      | 54                | 2.14       | .77  | .44 | 1.81 |
| <b>RH9731</b> | 50        | 1AN        | .500      | 3/8"      | 54                | 2.14       | .77  | .44 | 1.81 |
| <b>RH9751</b> | 100       | 1AN        | .500      | 1/2"      | 54                | 2.34       | .77  | .54 | 1.90 |
| <b>RJ9711</b> | 50        | 1/0AN      | .550      | 1/4"      | 80                | 2.35       | .83  | .46 | 1.97 |
| <b>RJ9731</b> | 25        | 1/0AN      | .550      | 3/8"      | 80                | 2.35       | .83  | .46 | 1.97 |
| <b>RJ9751</b> | 100       | 1/0AN      | .550      | 1/2"      | 80                | 2.49       | .89  | .55 | 2.04 |
| <b>RH717</b>  | 50        | 1/0        | .629      | 1/4"      | 80                | 2.14       | .77  | .43 | 1.81 |
| <b>RH727</b>  | 50        | 1/0        | .629      | 5/16"     | 80                | 2.14       | .77  | .43 | 1.81 |
| <b>RH737</b>  | 50        | 1/0        | .629      | 3/8"      | 80                | 2.14       | .77  | .43 | 1.81 |
| <b>RH757</b>  | 100       | 1/0        | .629      | 1/2"      | 80                | 2.34       | .77  | .54 | 1.90 |
| <b>RK9731</b> | 25        | 2/0AN      | .610      | 3/8"      | 70                | 2.52       | .93  | .55 | 2.14 |
| <b>RK9751</b> | 25        | 2/0AN      | .610      | 1/2"      | 70                | 2.60       | .93  | .55 | 2.15 |
| <b>RJ717</b>  | 50        | 2/0        | .675      | 1/4"      | 80                | 2.34       | .83  | .46 | 1.96 |
| <b>RJ727</b>  | 50        | 2/0        | .675      | 5/16"     | 80                | 2.34       | .83  | .46 | 1.96 |
| <b>RJ737</b>  | 50        | 2/0        | .675      | 3/8"      | 80                | 2.34       | .83  | .46 | 1.96 |
| <b>RJ757</b>  | 50        | 2/0        | .675      | 1/2"      | 80                | 2.48       | .89  | .54 | 2.03 |
| <b>RL9731</b> | 25        | 3/0AN      | .680      | 3/8"      | 120               | 2.83       | 1.04 | .57 | 2.36 |
| <b>RL9751</b> | 100       | 3/0AN      | .680      | 1/2"      | 120               | 2.83       | 1.04 | .57 | 2.36 |
| <b>RK717</b>  | 25        | 3/0        | .765      | 1/4"      | 84                | 2.60       | .93  | .54 | 2.21 |
| <b>RK727</b>  | 25        | 3/0        | .765      | 5/16"     | 84                | 2.60       | .93  | .54 | 2.21 |
| <b>RK737</b>  | 25        | 3/0        | .765      | 3/8"      | 84                | 2.60       | .93  | .54 | 2.21 |
| <b>RM9731</b> | 100       | 4/0AN      | .750      | 3/8"      | 160               | 3.00       | 1.13 | .66 | 2.51 |
| <b>RM9751</b> | 20        | 4/0AN      | .750      | 1/2"      | 160               | 3.00       | 1.13 | .66 | 2.51 |
| <b>RL737</b>  | 25        | 4/0        | .785      | 3/8"      | 130               | 2.83       | 1.04 | .57 | 2.35 |
| <b>RL757</b>  | 100       | 4/0        | .785      | 1/2"      | 130               | 2.83       | 1.04 | .57 | 2.35 |
| <b>RM737</b>  | 25        | 250MCM     | .868      | 3/8"      | 130               | 3.00       | 1.13 | .65 | 2.51 |
| <b>RM747</b>  | 25        | 250MCM     | .868      | 7/16"     | 130               | 3.00       | 1.13 | .65 | 2.51 |
| <b>RM757</b>  | 25        | 250MCM     | .868      | 1/2"      | 130               | 3.00       | 1.13 | .65 | 2.51 |

**AN** – Aircraft Wire

U.L. Listed E9809

Installing tools: TBM6/TBM6S, ERG-2007, (RD & RE Except Brazed Seam)

Note: Not available on Mylar Tape.

