

NAS77 UNLINED FLANGED BUSHINGS

- Material options: Aluminum bronze, beryllium copper, alloy steel, CRES
- Finish options: Cadmium plating, aluminum coating
- A final size (FS) option is available. Parts are manufactured to customer's required dimensions

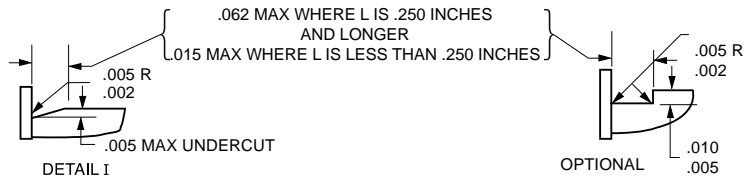
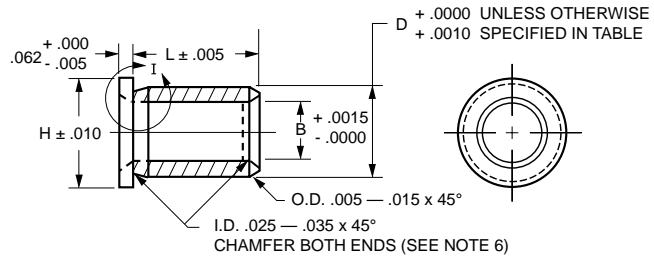

SPECIFICATIONS AND ORDERING INFORMATION

DIMENSIONS – TOLERANCES

Part Number	B		D		F		H		Weight	
	+.0015, -.0000 +.038, -.000		+.000, -.0010 +.000, -.025		+.000, -.005 +.00, -.13		+.010, -.010 +.25, -.25		Approx. (Assume 1 in. Length)	
	in.	mm	in.	mm	in.	mm	in.	mm	lbs.	kg
NAS77A3-xxx	0.1900	4.826	*0.3136	7.965	0.062	1.575	0.437	11.100	0.0147	0.0067
NAS77A4-xxx	0.2500	6.350	*0.3761	9.553	0.062	1.575	0.500	12.700	0.0186	0.0084
NAS77A5-xxx	0.3125	7.938	*0.4386	11.140	0.062	1.575	0.562	14.275	0.0222	0.0101
NAS77A6-xxx	0.3750	9.525	**0.5013	12.733	0.062	1.575	0.625	15.875	0.0259	0.0117
NAS77A7-xxx	0.4375	11.113	**0.5638	14.321	0.062	1.575	0.687	17.450	0.0295	0.0134
NAS77A8-xxx	0.5000	12.700	***0.6265	15.913	0.062	1.575	0.750	19.050	0.0332	0.0151
NAS77A9-xxx	0.5625	14.288	0.6892	17.506	0.062	1.575	0.812	20.625	0.0369	0.0167
NAS77A10-xxx	0.6250	15.875	0.8142	20.681	0.062	1.575	1.000	25.400	0.0639	0.0290
NAS77A11-xxx	0.6875	17.463	0.8767	22.268	0.062	1.575	1.062	26.975	0.0693	0.0315
NAS77A12-xxx	0.7500	19.050	0.9393	23.858	0.062	1.575	1.125	28.575	0.0749	0.0340
NAS77A14-xxx	0.8750	22.225	1.0648	27.046	0.062	1.575	1.250	31.750	0.0860	0.0390
NAS77A16-xxx	1.0000	25.400	1.1898	30.221	0.062	1.575	1.375	34.925	0.0970	0.0440
NAS77A18-xxx	1.1250	28.575	1.3148	33.396	0.062	1.575	1.500	38.100	0.1080	0.0490
NAS77A20-xxx	1.2500	31.750	1.4399	36.573	0.062	1.575	1.625	41.275	0.1190	0.0540
NAS77A22-xxx	1.3750	34.925	1.5649	39.748	0.062	1.575	1.750	44.450	0.1300	0.0590
NAS77A24-xxx	1.5000	38.100	1.6899	42.923	0.062	1.575	1.875	47.625	0.1410	0.0639
	*+.000, -.0020 +.000, -.051		*+.000, -.0005 +.000, -.013							
			**+.000, -.0007 +.000, -.018							
			***+.000, -.0008 +.000, -.020							

Available journal material options:
 A=Aluminum bronze alloy 642 per AMS 4640 (shown above)
 S=Steel alloy 4130 per AMS-S-6758
 C=CRES type 17-4PH per AMS 5643
 B=Beryllium copper per ASTM-B-196
 xxx: Length in .010 increments (ex: -025 = .025 in.)

JOURNAL BEARINGS