

Catalog Number E70SF(5 – 30) 700VAC/700VDC  
Catalog Number E70S(35 – 1200) 700VAC/700VDC\*

### E70SF(AMP) DIMENSIONS

CATALOG NUMBER	INCHES/MM
E70SF5 – 30	See Drawing

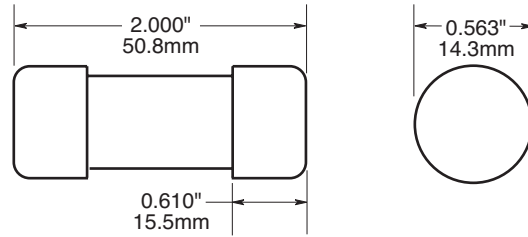

### E70S(Amp) DIMENSIONS

CATALOG NUMBER	FIGURE	INCHES										MILLIMETERS									
		A	B	C	D	E	F	G	H	J	A	B	C	D	E	F	G	H	J		
E70S35 – 60	1 & 1A	4.38	1.00	2.84	3.78	3.44	0.34	0.75	0.13	0.52	111	25.4	72.1	96	87.4	8.6	19.1	3.3	13.2		
E70S70 – 100	1 & 1A	4.38	1.22	2.84	3.69	3.44	0.34	1.00	0.19	0.47	111	31	72.1	93.7	87.4	8.6	25.4	4.8	11.9		
E70S125 – 200	1 & 1A	5.09	1.50	2.84	4.19	3.50	0.41	1.00	0.25	0.75	129	38.1	72.1	106	88.9	10.4	25.4	6.4	19.1		
E70S225 – 400	1 & 1A	5.09	2.00	2.84	4.28	3.53	0.41	1.50	0.25	0.78	129	50.8	72.1	109	89.7	10.4	38.1	6.4	19.8		
E70S450 – 600	1 & 1A	7.09	2.50	2.84	5.72	4.19	0.53	2.00	0.38	1.30	180	63.5	72.1	145	106	13.5	50.8	9.7	33		
E70S700 – 800	1 & 1A	6.63	2.00	2.84	5.56	5.06	0.63	1.50	0.25	0.88	168	50.8	72.1	141.2	128.6	15.9	38.1	6.4	22.2		
E70S900 – 1000	2	See Drawing																			
E70S1200	3	See Drawing																			

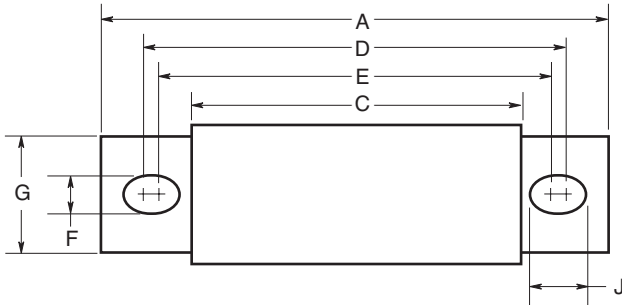

Figure 1: 35 – 100 & 125 – 800 Amp Range

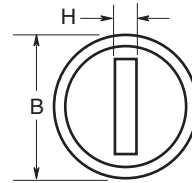

Figure 1A:

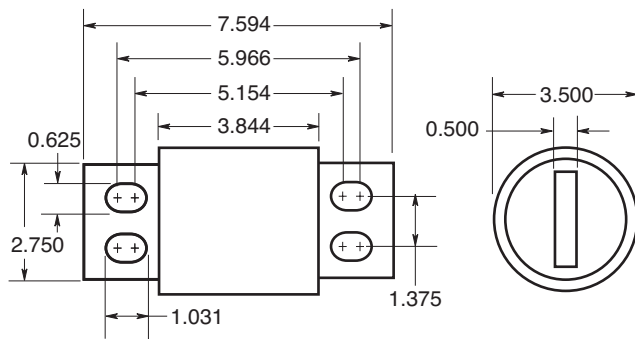

Figure 2: 900 – 1000 Amp Range

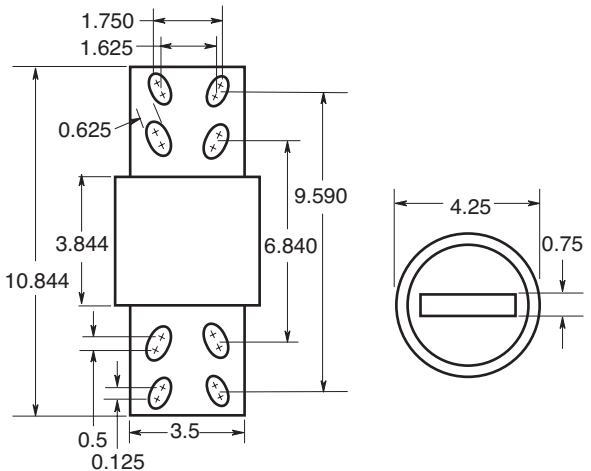
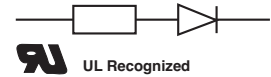

Figure 3: 1200 Amp Range

Catalog Number E70S(Amp)  
700VAC/700VDC\*



### E70S(Amp) 700VAC/700VDC ELECTRICAL CHARACTERISTICS

CATALOG NUMBER	RATED CURRENT RMS AMPS	MELTING I <sup>2</sup> t A <sup>2</sup> S	CLEARING I <sup>2</sup> t A <sup>2</sup> S @ 700V	WATTS LOSS @ RATED CURRENT
E70SF5	5	1.6	4	1.5
E70SF10	10	3.6	10	4.0
E70SF15	15	10.0	22	5.5
E70SF20	20	26.0	60	6.0
E70SF25	25	44.0	130	7.0
E70SF30	30	58.0	150	9.0
E70S35	35	80.0	370	9.8
E70S40	40	100	460	11.5
E70S50	50	200	840	13.4
E70S60	60	310	1300	15.1
E70S70	70	470	2200	17.0
E70S80	80	620	2900	20.0
E70S90	90	800	3700	23.0
E70S100	100	1030	4800	25.0
E70S125	125	1800	7300	28.0
E70S150	150	2900	11700	32.0
E70S175	175	4200	16700	35.0
E70S200	200	5600	22000	43.0
E70S225	225	7700	31300	45.0
E70S250	250	10500	42500	48.0
E70S300	300	17600	71200	58.0
E70S350	350	23700	95600	65.0
E70S400	400	31000	125000	78.0
E70S450	450	36400	137000	94.0
E70S500	500	45200	170000	107.0
E70S600	600	66700	250000	122.0
E70S700	700	54000	300000	125.0
E70S800	800	78000	450000	140.0
E70S900	900	91500	530000	150.0
E70S1000	1000	120000	600000	170.0
E70S1200	1200	195000	1100000	190.0

Interrupting Rating 200kA RMS Symmetrical

\*700VDC rating applies to 5 – 800 amperes only.



**PRE-ARCING TIME-CURRENT CURVES**

**E70SF(Amp)**  
**5 – 30 Amps, 700 Volts**

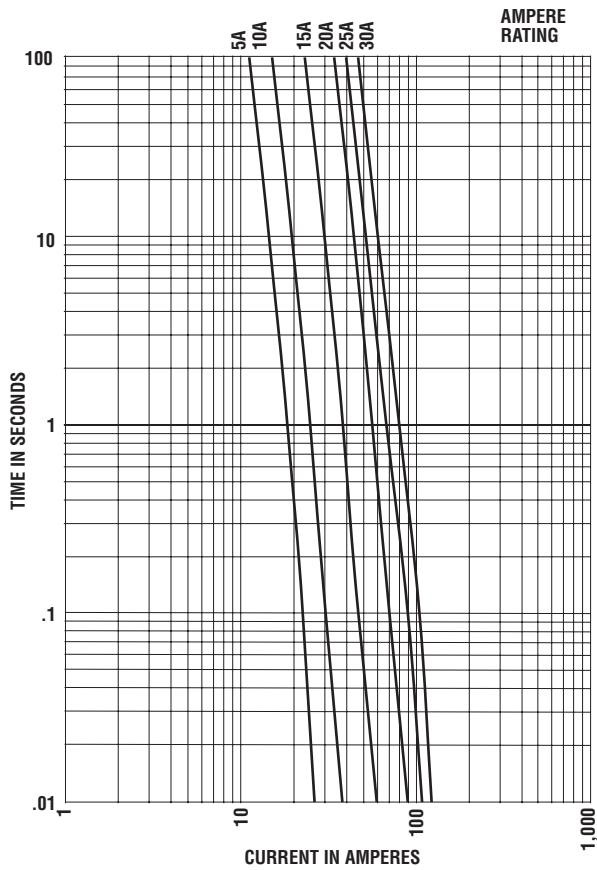

**MINIMUM MELT TIME-CURRENT CURVES**

**E70S(Amp)**  
**35 – 600 Amps, 700 Volts**

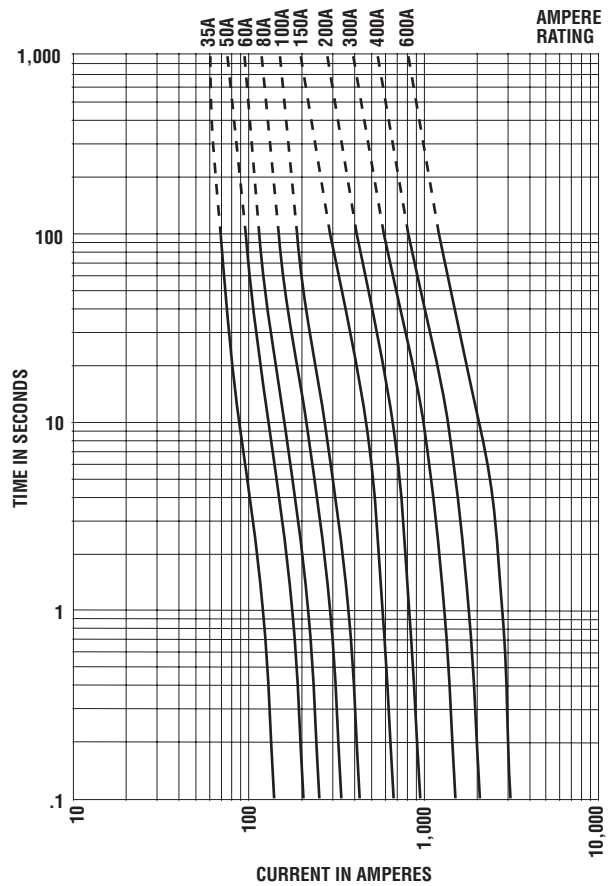

**PEAK LET-THROUGH CURRENT CURVES**

**E70SF(Amp)**  
**5 – 30 Amps, 700 Volts**

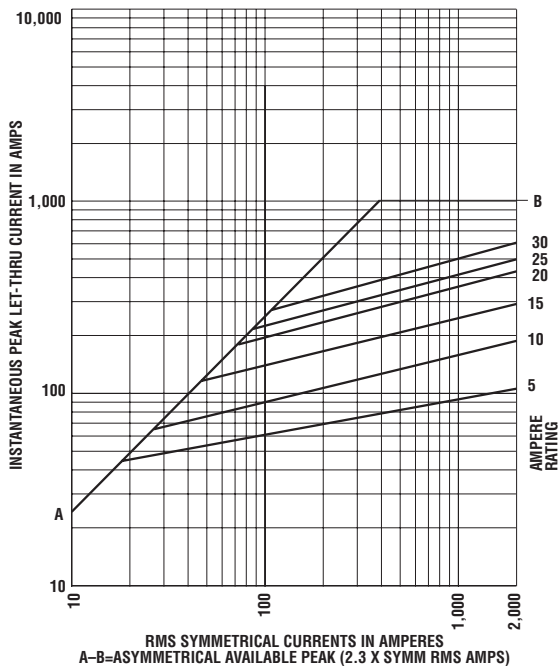

**E70S(Amp)**  
**35 – 600 Amps, 700 Volts**

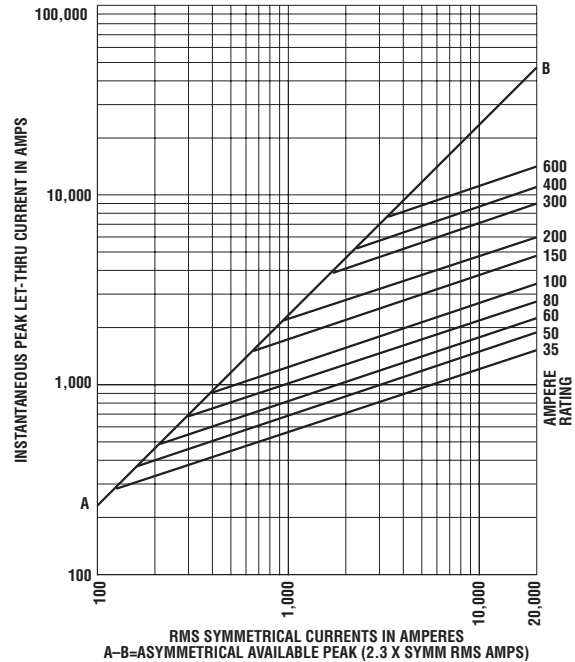

RMS SYMMETRICAL CURRENTS IN AMPERES  
A-B=ASYMMETRICAL AVAILABLE PEAK (2.3 X SYMM RMS AMPS)

RMS SYMMETRICAL CURRENTS IN AMPERES  
A-B=ASYMMETRICAL AVAILABLE PEAK (2.3 X SYMM RMS AMPS)

### MINIMUM MELT TIME-CURRENT CURVES

E70S(Amp)  
700 – 1200 Amps, 700 Volts

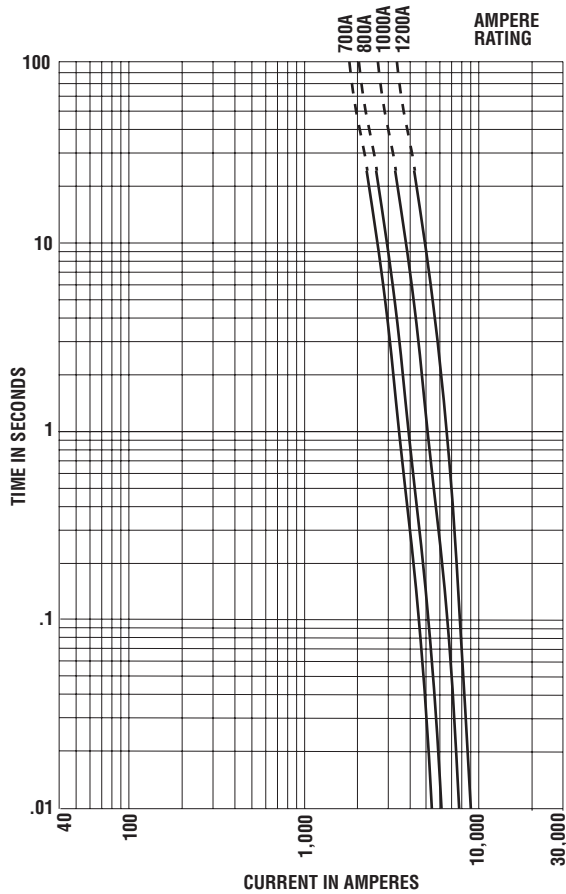

### PEAK LET-THROUGH CURRENT CURVES

E70S(Amp)  
700 – 1200 Amps, 700 Volts

