

# 156" ELC Screw-Terminal/Edgcard Connector



## Product Line Overview

The compact .156" ELC wire-to-board edgcard terminal block is designed for panel-mounting with bottom wire entry. Connectors are available in single and double-sided configurations to meet specific application needs.

### Superior Contact Design

The ELC features a bifurcated cantilever beam contact that eliminates the board damage possible with the stamped tuning fork board contacts commonly used in similar connectors. The cantilever beam also assures improved performance under board warping and bending conditions over the full .054" to .070" board thickness range. Connectors are available with special marking and configuration adaptations, and in sizes not indicated in the table. Please contact Amphenol Pcd for details.

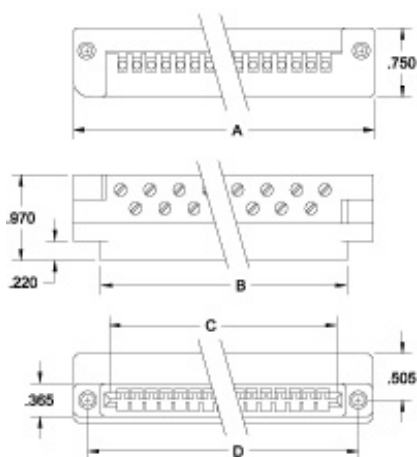

[View part PDF File](#)

[Download part DXF File](#)

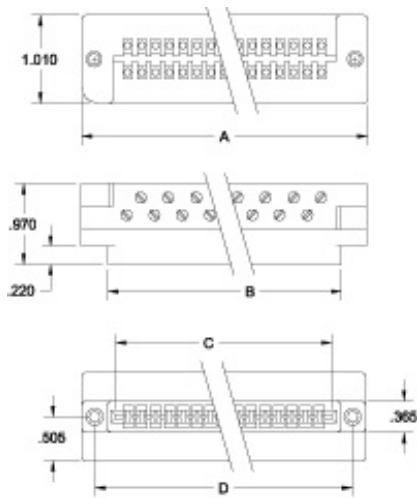

[View part PDF File](#)

[Download part DXF File](#)

### SPECIFICATIONS:

Current Rating: 5A  
 Insulation Resistance: >105 Megohms  
 Durability: 500 cycles per MIL-C-21097  
 Wire Range: 14-26 AWG  
 Wire Pullout Force: 35 lbs minimum  
 Board Thickness Range: .054-.070"

### MATERIALS:

Housing: Glass-filled polyester, UL 94-V0, Black  
 Contact: Phosphor bronze, .000030" selective gold finish  
 Wire Clamp: Brass, nickel finish  
 Terminal Screw: Steel, nickel finish

Pos	Catalog #	A	B	C	D
6	ELC0621001.100	1.252	1.534	1.844	
10	ELC1021001.724	1.876	2.158	2.468	
12	ELC1221002.036	2.188	2.470	2.780	
15	ELC1521002.504	2.656	2.938	3.248	
18	ELC1821002.972	3.124	3.406	3.716	
22	ELC2221003.596	3.748	4.030	4.340	

Pos	Catalog #	A	B	C	D
12	ELC1211001.100	1.252	1.534	1.844	
20	ELC2011001.724	1.876	2.158	2.468	
24	ELC2411002.036	2.188	2.470	2.780	
30	ELC3011002.504	2.656	2.938	3.248	
36	ELC3611002.972	3.124	3.406	3.716	
44	ELC4411003.596	3.748	4.030	4.340	