

POWER SPLITTERS - 2 WAY 0°

Features

- Broadband frequency range
- High isolation
- Surface Mount package available

Operating characteristics

- Operating and storage temperature: - 55° C / + 100° C
- Soldering heat: 10 s at 265° C
- Total input power: 1 W
- Impedance: 50 Ω nominal

Case drawings

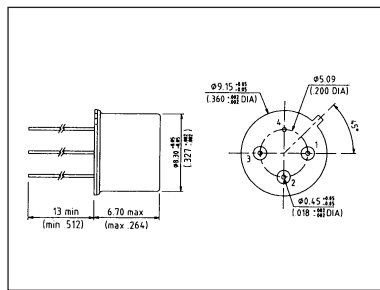

TO39-1

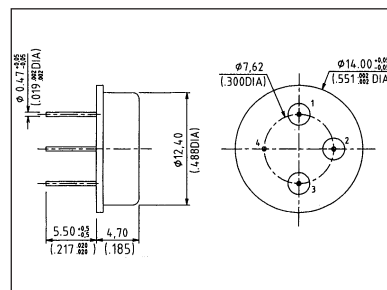

TO8-1

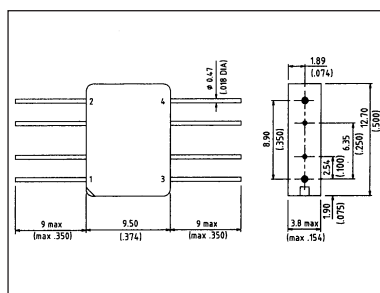

FP3

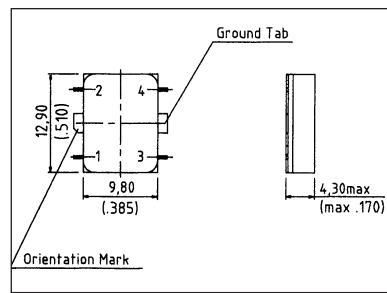

SMM1

Model N°	Freq. range (MHz)	Isolation (dB)			Insertion loss (dB)			Amplitude unbalance (dB)			Phase unbalance (deg)			Package
		L Typ/Min	M Typ/Min	U Typ/Min	L Typ/Max	M Typ/Max	U Typ/Max	L Max	M Max	U Max	L Max	M Max	U Max	
F54701	10-500	35/30	40/30	30/25	0.25/0.5	0.3/0.6	0.3/0.6	0.2	0.2	0.2	0.5	1	1	FP3
F54702	10-2000	30/25	25/20	20/15	1.1	1.3	1.8	0.3	0.4	0.6	3	4	5	FP3
C54701	10-500	35/30	40/30	30/25	0.2/0.5	0.3/0.6	0.3/0.6	0.2	0.2	0.2	1	1.5	1.5	SMM1
C54702	10-2000	28/23	22/18	18/12	1.1	1.3	1.8	0.3	0.4	0.6	4	6	8	SMM1
F54709	1-200	35/30	40/35	35/30	0.2/0.4	0.2/0.5	0.3/0.6	0.2	0.2	0.2	1	1	1.5	TO39-1
F54751	10-500	35/30	40/30	30/25	0.2/0.5	0.3/0.6	0.3/0.6	0.2	0.2	0.2	0.5	1	1	TO39-1
F54726	10-500	35/30	40/30	30/25	0.2/0.5	0.3/0.6	0.3/0.6	0.2	0.2	0.2	0.5	1	1	TO8-1