

## D Subminiature Solder Mount Hermetic Connectors

Glass-sealed hermetic receptacles are qualified to MIL-DTL-24308/9 and feature gold-plated iron alloy size #20 contacts and steel shells. Available in five shell sizes, these connectors are installed onto bulkheads by soldering. Choose solder cup or eyelet contacts for termination to #20 AWG wire. Choose Class H tin-plated steel shells for general purpose applications. For space applications choose Class K versions with nickel-plated stainless steel shells.

Style A



Flange  
Style A

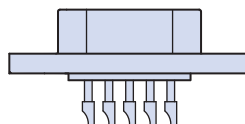

Solid connector flange with no mounting hole.

Flange  
Style B

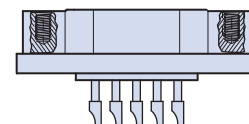

Connector flange features integral tapped #4-40 female threads for attaching mating male screw locks.

Style B



Contact  
Style P

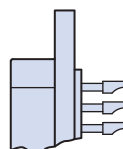

Connector is supplied with solder cup contacts.

Contact  
Style X

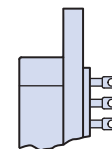

Connector is supplied with eyelet style contacts.

Shell Size	No. of Contacts	Contact Style	Flange Style	Class H Tin-Plated Steel		Class K (Space) Nickel-Plated Stainless Steel	
				Part Number	Military PN	Part Number	Military PN
1	9	Solder Cup	A	<a href="#">280-006H1AP</a>	M24308/9-1	<a href="#">280-006K1AP</a>	M24308/9-21
1	9	Solder Cup	B	<a href="#">280-006H1BP</a>	M24308/9-11	<a href="#">280-006K1BP</a>	M24308/9-31
1	9	Eyelet	A	<a href="#">280-006H1AX</a>	M24308/9-6	<a href="#">280-006K1AX</a>	M24308/9-26
1	9	Eyelet	B	<a href="#">280-006H1BX</a>	M24308/9-16	<a href="#">280-006K1BX</a>	M24308/9-36
2	15	Solder Cup	A	<a href="#">280-006H2AP</a>	M24308/9-2	<a href="#">280-006K2AP</a>	M24308/9-22
2	15	Solder Cup	B	<a href="#">280-006H2BP</a>	M24308/9-12	<a href="#">280-006K2BP</a>	M24308/9-32
2	15	Eyelet	A	<a href="#">280-006H2AX</a>	M24308/9-7	<a href="#">280-006K2AX</a>	M24308/9-27
2	15	Eyelet	B	<a href="#">280-006H2BX</a>	M24308/9-17	<a href="#">280-006K2BX</a>	M24308/9-37
3	25	Solder Cup	A	<a href="#">280-006H3AP</a>	M24308/9-3	<a href="#">280-006K3AP</a>	M24308/9-23
3	25	Solder Cup	B	<a href="#">280-006H3BP</a>	M24308/9-13	<a href="#">280-006K3BP</a>	M24308/9-33
3	25	Eyelet	A	<a href="#">280-006H3AX</a>	M24308/9-8	<a href="#">280-006K3AX</a>	M24308/9-28
3	25	Eyelet	B	<a href="#">280-006H3BX</a>	M24308/9-18	<a href="#">280-006K3BX</a>	M24308/9-38
4	37	Solder Cup	A	<a href="#">280-006H4AP</a>	M24308/9-4	<a href="#">280-006K4AP</a>	M24308/9-24
4	37	Solder Cup	B	<a href="#">280-006H4BP</a>	M24308/9-14	<a href="#">280-006K4BP</a>	M24308/9-34
4	37	Eyelet	A	<a href="#">280-006H4AX</a>	M24308/9-9	<a href="#">280-006K4AX</a>	M24308/9-29
4	37	Eyelet	B	<a href="#">280-006H4BX</a>	M24308/9-19	<a href="#">280-006K4BX</a>	M24308/9-39
5	50	Solder Cup	A	<a href="#">280-006H5AP</a>	M24308/9-5	<a href="#">280-006K5AP</a>	M24308/9-25
5	50	Solder Cup	B	<a href="#">280-006H5BP</a>	M24308/9-15	<a href="#">280-006K5BP</a>	M24308/9-35
5	50	Eyelet	A	<a href="#">280-006H5AX</a>	M24308/9-10	<a href="#">280-006K5AX</a>	M24308/9-30
5	50	Eyelet	B	<a href="#">280-006H5BX</a>	M24308/9-20	<a href="#">280-006K5BX</a>	M24308/9-40

Dimensions in inches (millimeters) and are subject to change without notice.

**MATERIALS AND FINISHES**

Contacts	Ferrous alloy, gold plated per ASTM B488, type II, code C, class 1,27.
Shell, class H	Carbon steel, tin/lead plated over nickel underplating (3% min. lead)
Shell, class K	304L alloy stainless steel, dull nickel plated
Insulators	Vitreous glass

**SPECIFICATIONS**

Current rating	5 Amps per contact maximum
Voltage rating (DWV)	750 VAC sea level, 175 VAC at 70,000 ft. (21,336 meters)
Insulation resistance	5000 megohms minimum
Hermeticity	Less than $1 \times 10^{-5}$ cc/second helium leak rate
Contact resistance	165 milliohms maximum
Thermal vacuum outgassing (class K)	1.0% max. TML, 0.1% max. VCM
Durability	500 mating cycles
Operating temperature	-55° C to +125° C
Shock	50 g.
Vibration	20 g.
Corrosion resistance (salt spray)	48 hours
Maximum wire size	#20 AWG

**INSERT ARRANGEMENTS**

SHELL SIZE	NUMBER OF CONTACTS	MATING FACE OF CONNECTOR
1	9	
2	15	
3	25	
4	37	
5	50	

**PANEL CUTOUTS**

The cutout shown is for front-panel mounting of flange style A and B.

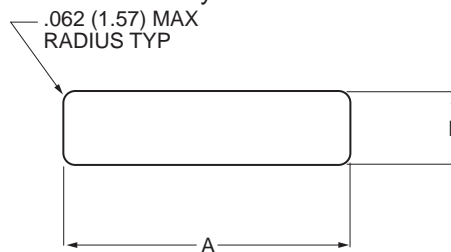

Shell Size	A		B	
	In.	mm.	In.	mm.
1	± .005	± 0.13	± .005	± 0.13
2	.745	18.92	.385	9.78
3	.950	24.13	.385	9.78
4	1.495	37.97	.385	9.78
5	2.145	54.48	.520	13.21

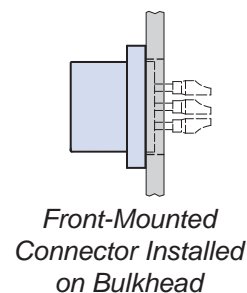

Dimensions in inches (millimeters) and are subject to change without notice.

CAGE Code 06324

Printed in U.S.A.

**Dimensions for Flange Style A**

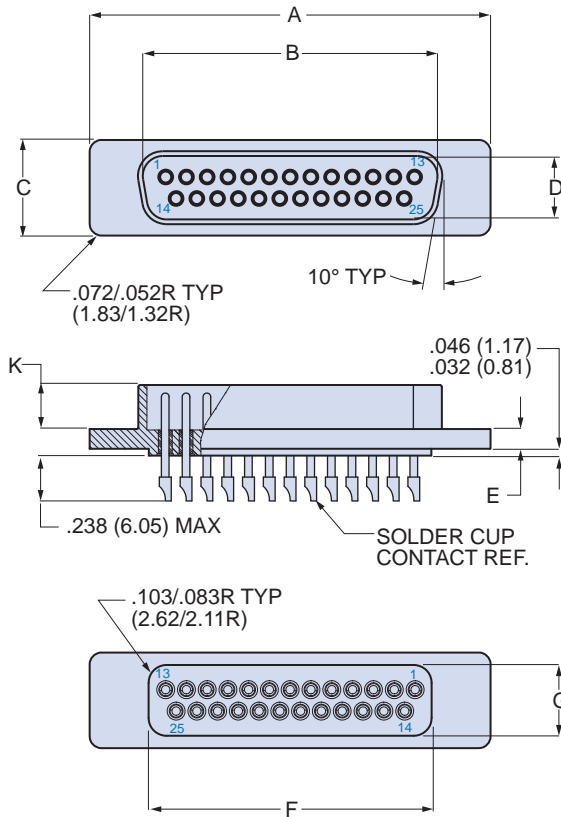

**Dimensions for Flange Style B**

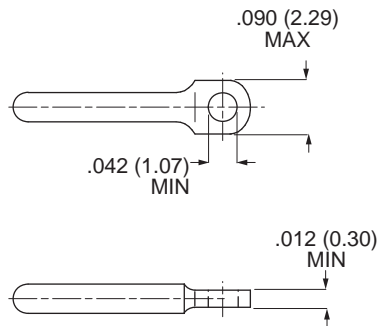
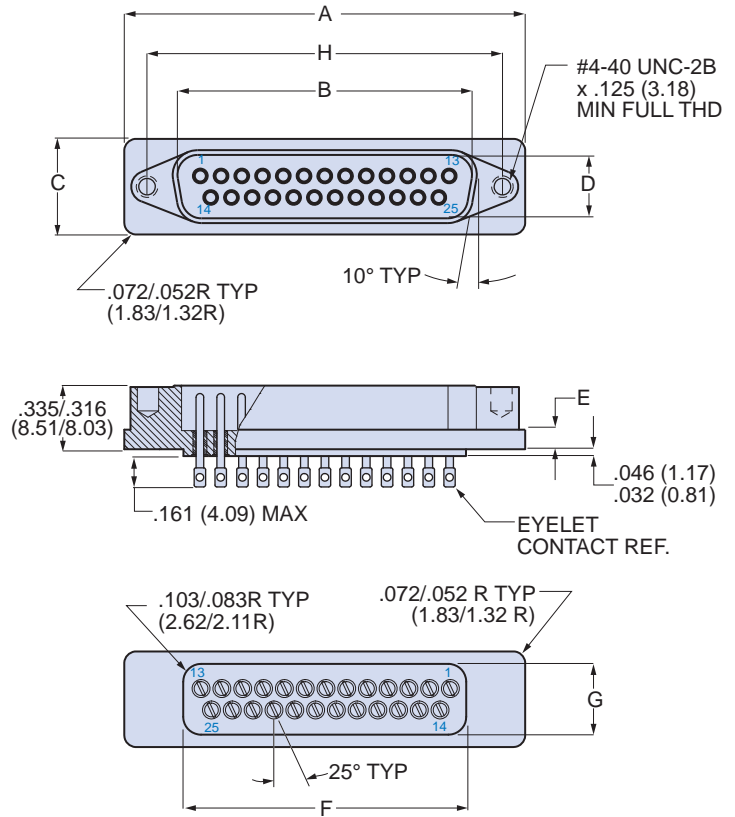

CONTACT STYLE X  
EYELET

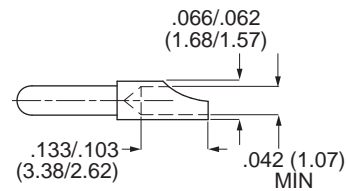

CONTACT STYLE P  
SOLDER CUP

Shell Size	A		B		C		D		E		F		G		H		K	
	In.	mm.	In.	mm.	In.	mm.	In.	mm.	In.	mm.	In.	mm.	In.	mm.	In.	mm.	In.	mm.
1	± .015	± 0.38	± .004	± 0.10	± .010	± 0.25	± .004	± 0.10	± .006	± 0.15	± .010	± 0.25	± .010	± 0.25	± .005	± 0.13	± .010	± 0.25
2	1.213	30.81	.667	16.94	.498	12.65	.330	8.38	.094	2.39	.725	18.42	.369	9.37	.984	24.99	.235	5.97
3	1.541	39.14	.993	25.22	.498	12.65	.330	8.38	.094	2.39	.932	23.67	.369	9.37	1.312	33.32	.235	5.97
4	2.088	53.04	1.535	38.99	.498	12.65	.330	8.38	.103	2.62	1.479	37.57	.369	9.37	1.852	47.04	.230	5.84
5	2.729	69.32	2.183	55.45	.498	12.65	.330	8.38	.103	2.62	2.125	53.98	.369	9.37	2.500	63.50	.230	5.84
5	2.635	66.93	2.079	52.81	.610	15.49	.441	11.20	.103	2.62	2.000	50.80	.500	12.70	2.406	61.11	.230	5.84

Dimensions in inches (millimeters) and are subject to change without notice.