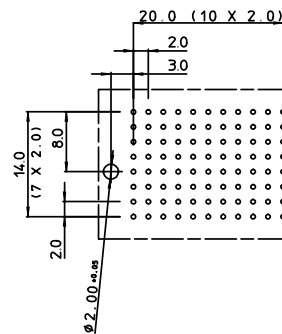
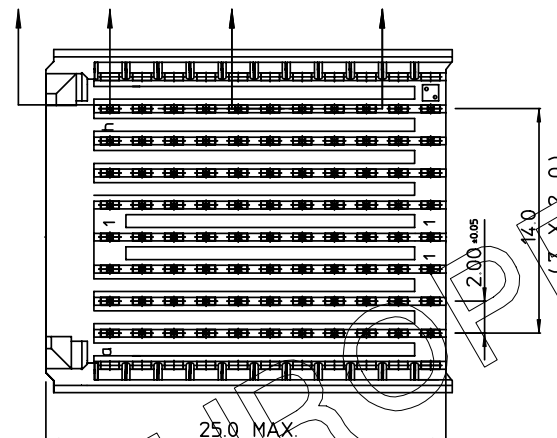

## PERFORMANCE CHARACTERISTICS

CURRENT RATING : 1.5 A AT 20°C ( FULLY LOADED )  
CURRENT RATING : 1 A AT 70°C ( FULLY LOADED )  
RATED VOLTAGE : 500 V AC ( CONT / CONT )  
OPERATING TEMPERATURE : -55°C TO 125°C  
CONTACT RESISTANCE : 20 mΩ MAX  
INSERTION FORCE : 0.60 N MAX / CONT  
EXTRACTION FORCE : 0.15 N MIN / CONT  
INSULATION RESISTANCE : 10<sup>4</sup> MΩ MIN

| CAT. NR.         | L ±0.3 | DESCRIPTION           |
|------------------|--------|-----------------------|
| HM2P82PD8110---- | 3.7    | SHORT PRESS-FIT       |
| HM2P82PC8110---- | 4.5    | SHORT PRESS-FIT       |
| HM2P82PK8110---- | 13     | REAR PLUG-UP: LEVEL 1 |
| HM2P82PM8110---- | 14.5   | REAR PLUG-UP: LEVEL 2 |
| HM2P82PN8110---- | 16     | REAR PLUG-UP: LEVEL 3 |
| HM2P82PT8110---- | 13     | WIRE WRAP             |

LAY-OUT  
P.C.B. - HOLE

## NOTES

1. \*HM2P82P#8110--\*  
PERFORMANCE LEVEL INDICATOR  
(REFER DWG No. BS,C ,201844,003)  
LEAD FREE INDICATOR : LF=LEAD FREE  
(DIGIT 15&16)
2. THIS PRODUCT IS CSA APPROVED.  
THIS PRODUCT IS UL RECOGNIZED.
3. FOR RECOMMENDED PTH DIMENSIONS REFER DRAWING : BS,A ,201572,001
4. THE PRODUCT (LF) MEETS EUROPEAN UNION DIRECTIVES AND OTHER COUNTRY REGULATIONS AS DESCRIBED IN GS-22-008

## MALE SIGNAL STRAIGHT PRESS-FIT-TO-BOARD CONNECTOR

## EXTENSION MODULE (WIDE BODY)

|   |  |                    |                 |  |
|---|--|--------------------|-----------------|--|
| 1DEC ±0.2<br>2DEC ±0.1<br>ANGLES ±1°  | APPR.<br>DRAFT<br>CHECKED                  | DATE<br>1998-10-20 | SIGN.<br>M.Fret | MILLIPACS 2 / TYPE FR (8 ROW) / NO SHIELDING |
| WE RESERVE THE RIGHT TO CHANGE DIMENSIONS OR REQUIREMENTS WITHOUT PRIOR NOTICE. | PROD. MGR.<br>PR.ENG. MGR.<br>PR.MGT. MGR. |                    |                 | CAT. No. HM2P82P#8110----                    |
| ALL DIMENSIONS IN MM  |  |                    |                 | www.fciconnect.com                           |

## REFERENCES



www.fciconnect.com

SCALE

3/1

BS,C ,202259,005

C

PDM: Rev:C

STATUS: Released

CUSTOMER DRAWING REVISION

Printed: Sep 07, 2006

| REV. | DATE     | DESCRIPTION | BY     | C'K'D' |
|------|----------|-------------|--------|--------|
| B    | 06-05-04 | 104-0029    | ALEX B | BKP    |
| C    | 14-01-05 | 105-0006    | ALEX B | BKP    |
| D    | 01-06-05 | 105-0083    | ALEX B | BKP    |

# MILLIPACS : CONTACT PLATING CODE OVERVIEW

HM2---P------(L-)(LF)

FOR LEAD FREE PLATING  
OPTIONAL (NOTE 1)  
PLATING CODE (DIGIT 13 AND 14)

| PLATING CODE | CONTACT AREA  |   |   |
|--------------|---|---|---|
| L9           | 1.25 $\mu$ Au min over 1.3 $\mu$ Ni min.  | MALE CONN.: SHORT / WIRE WRAP CONT.<br>FEMALE CONNECTOR |   |
| E9           | 1.00 $\mu$ Au min over 1.3 $\mu$ Ni min.  | MALE CONN.: SHORT / WIRE WRAP CONT.<br>FEMALE CONNECTOR | PERFORMANCE LEVEL 1 (500 mating cycles) |
| N9           | 0.80 $\mu$ Au min over 1.3 $\mu$ Ni min.  | MALE CONN.: SHORT / WIRE WRAP CONT.<br>FEMALE CONNECTOR | PERFORMANCE LEVEL 2 (250 mating cycles) |
| Z1           | 0.40 $\mu$ Au min over 1.3 $\mu$ Ni min.  | MALE CONN.: SHORT / WIRE WRAP CONT.<br>FEMALE CONNECTOR | PERFORMANCE LEVEL 3 (50 mating cycles)  |
| NN           | 0.15 $\mu$ Au Average over 1.02 $\mu$ NiP Average.                              | MALE CONN.: SHORT / WIRE WRAP CONT.<br>FEMALE CONNECTOR |   |
| NEN          | 0.38 $\mu$ Au Average over 1.02 $\mu$ NiP Average.                              | MALE CONN.: SHORT / WIRE WRAP CONT.<br>FEMALE CONNECTOR |   |
| GE           | 1.25 $\mu$ Au min over 1.3 $\mu$ Ni min.  | MALE CONN.: REAR PLUG-UP CONTACTS                       |   |
| GL           | 1.00 $\mu$ Au min over 1.3 $\mu$ Ni min.  | MALE CONN.: REAR PLUG-UP CONTACTS                       | PERFORMANCE LEVEL 1 (500 mating cycles) |
| GF           | 0.80 $\mu$ Au min over 1.3 $\mu$ Ni min.  | MALE CONN.: REAR PLUG-UP CONTACTS                       | PERFORMANCE LEVEL 2 (250 mating cycles) |
| GC           | 0.40 $\mu$ Au min over 1.3 $\mu$ Ni min.  | MALE CONN.: REAR PLUG-UP CONTACTS                       | PERFORMANCE LEVEL 3 (50 mating cycles)  |
| GN           | 0.15 $\mu$ Au Average over 1.02 $\mu$ NiP Average.<br>(Both Front & Rear Sides) | MALE CONN.: REAR PLUG-UP CONTACTS                       |   |
| GEN          | 0.38 $\mu$ Au Average over 1.02 $\mu$ NiP Average.<br>(Both Front & Rear Sides) | MALE CONN.: REAR PLUG-UP CONTACTS                       |   |

## NOTE :

- 1) IN CASE OF STR HDR CONNECTORS :  
EXTENSIONS CAN BE ADDED TO THE PLATING CODE  
IF LUBRICATED CONTACTS ARE REQUIRED  
L : LUBRICATED  
L1: LUBRICATED TO MEET TELCORDIA GR-1217 CORE REQUIREMENTS
- 2) PLATING AT EON AREA  
LF : Sn MATT FINISH PLATING(0.05  $\mu$ Min)  
ALL OTHER PART NOS : SnPb PLATING(0.05  $\mu$ Min)

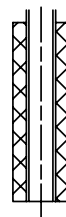

REF NOTE 2 FOR  
EON PLATING

|   |  |                |                 |  |
|---|--|----------------|-----------------|--|
| 1DEC $\pm 0.2$ 1DEC<br>2DEC $\pm 0.1$ 2DEC<br>ANGLES $\pm 1^\circ$ HOEKEN             | APPR.<br>DRAFT<br>CHECKED                    | DATE<br>210303 | SIGN.<br>M.Fret | MPACS CONTACT PLATING OVERVIEW<br>CAT. No. HM2---P------(L-)         |
| WE RESERVE THE RIGHT TO CHANGE<br>DIMENSIONS OR REQUIREMENTS<br>WITHOUT PRIOR NOTICE. | PROD. MGR.<br>PR. ENG. MGR.<br>PR. MGT. MGR. |                |                 | <b>A</b> FCI<br>FCI MECHELEN N.V.<br>A. SPINOYSTRAT 8, 2800 MECHELEN |
| ALL DIMENSIONS IN MM<br>ALLE AFMETINGEN IN MM   | REFERENCES / REFERENTIES                     |                |                 | BS,C ,201844,003<br>D  |