

ENG. NO SDA-87204-7\*\*\*

EDP NO.

SIMILAR ITEM

CAD FILE : S872047

DO NOT SCALE DRAWING

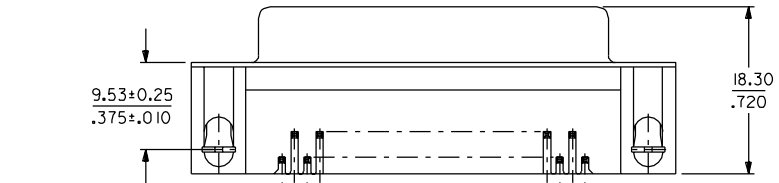
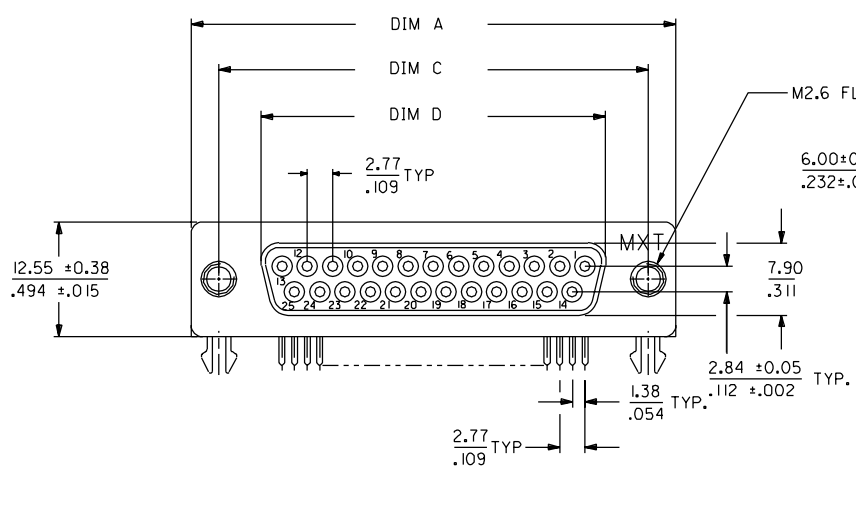

RECOMMENDED PCB LAYOUT

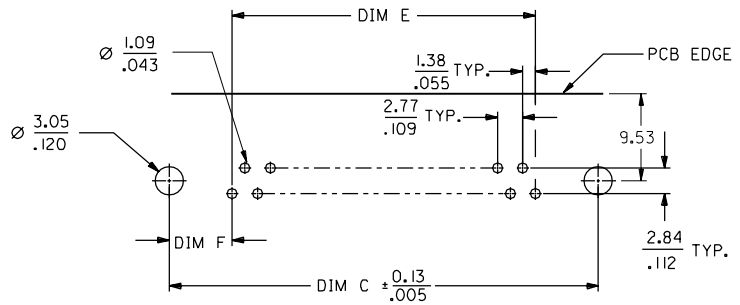

PCB LAYOUT: COMPONENT SIDE  
RECOMMENDED PCB THICKNESS: 1.60 mm

CKT SIZE	DIM A	DIM C	DIM D	DIM E	DIM F
9	30.81	24.99	16.33	11.07	6.96
	1.213	.984	.643	.436	.274
15	39.14	33.32	24.66	19.38	6.97
	1.541	1.312	.971	.763	.274
25	53.04	47.04	38.38	33.22	6.91
	2.088	1.852	1.511	1.308	.272
37	69.32	63.50	54.84	49.83	6.84
	2.729	2.500	2.159	1.962	.269

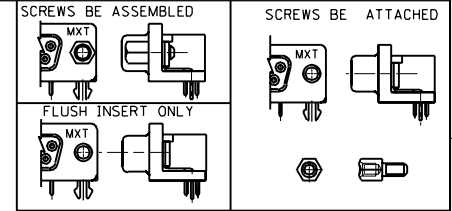

PART NUMBER LEGEND

87204-7

- | CKT SIZE | PLATING | SCREW OPTION  |
|----------|---------|---|
| 87204-7  | *       | *   |
| 0 : 9    |         | 1: 2 pcs #4-40 round inner thread screw rivetted  |
| 1 : 15   |         | 2: Flush insert only  |
| 2 :      |         | 3: 2 pcs #4-40 hex inner thread screw assembled   |
| 3 : 25   |         | 4: 2 pcs M2.6 inner thread screw assembled  |
| 4 : 37   |         | 5: 2 pcs M3 inner thread screw assembled  |
|          |         | 6: 2 pcs #4-40 hex inner thread screw attached  |
|          |         | 7: 2 pcs M2.6 inner thread screw attached   |
|          |         | 8: 2 pcs M3 inner thread screw attached   |
|          |         | 4 : 30 MICRO INCH MINIMUM GOLD IN CONTACT AREA<br>50 MICRO INCH MINIMUM NICKEL ALL OVER<br>AND 100 MICRO INCH TIN/LEAD ON TAILS |
|          |         | 5 : 15 MICRO INCH MINIMUM GOLD IN CONTACT AREA<br>50 MICRO INCH MINIMUM NICKEL ALL OVER<br>AND 100 MICRO INCH TIN/LEAD ON TAILS |
|          |         | 6 : GOLD FLASH IN CONTACT AREA<br>AND 100 MICRO INCH TIN/LEAD ON TAILS  |

REVISION RECORD				DRAWN BY		CHK'D BY		TITLE	
LTR	REVISION RECORD	ECN	DR	DATE	BY	DATE	BY	SCALE	REV Q
O	CHANGE PLATE	1699-0286	G.Wang	990507					
P	UPDATE THE OPTION	198-277	NEIL	980225					
O	RELEASE TO MANUFACTURING	197-380	NEIL	970519					
N	ERROR CORRECTION	196-158	NEIL	95/10/26					
M	PER ECN# TA94-162		RICHARD	94/09/06					
L	PER ECN# TA94-125		WILSON	94/01/21					
K	PER ECN# TA93-125		WILSON	93/07/06					
J	PER ECN# TA93-037		LYC	93/03/11					
REVISION RECORD				ECN	DR	DATE	DRAWN BY C K 89/6/9		CHK'D BY
REVISION RECORD				ECN	DR	DATE	APPR'D BY	SCALE	1:1

MATERIAL : SEE NOTE  
FINISH : SEE NOTE  
WIRE RANGE : ---  
INS. RANGE : ---  
MATERIAL : SEE NOTE  
MOLLEX TAIWAN LTD.  
SHEET 1 OF 1  
GENERAL TOLERANCES  
ANGLE : ± 3° DIM : ± .25/.010  
ENG. NO.: SDA-87204-7\*\*\*  
TITLE : STANDARD FEMALE D-SUB (FORK BOARD LOCK)