

PLEASE CHECK WWW.MOLEX.COM FOR LATEST PART INFORMATION

Part Number: **0190030126**
Status: **Active**
Description: InsulKrimp™ Quick Disconnect, Female, Box, Tab 4.75mm (.187") x 0.51mm (.020")

Documents:

[Drawing \(PDF\)](#) [RoHS Certificate of Compliance \(PDF\)](#)
[Product Specification PS-19902-008 \(PDF\)](#)

Agency Certification

UL E79133

General

Product Family Quick Disconnects
 Series [19003](#)
 Comments Funnel Entry
 Crimp Quality Equipment Yes
 Product Name InsulKrimp™
 Type Quick Disconnect

Physical

Barrel Type Closed
 Color - Resin Natural
 Flammability 94V-0
 Gender Female
 Glow-Wire Compliant No
 Insulation Nylon (PA)
 Lock to Mating Part None
 Material - Metal Brass
 Material - Plating Mating Tin
 Material - Plating Termination Tin
 Material - Resin Nylon
 Orientation Straight
 Packaging Type Bag
 Plating min: Mating (µin) 160
 Plating min: Mating (µm) 4
 Plating min: Termination (µin) 160
 Plating min: Termination (µm) 4
 Polarized to Mating Part No
 Tab Thickness 0.51mm (.020")
 Tab Width 4.75mm (.187")
 Temperature Range - Operating -65°C to +105°C
 Termination Interface: Style Crimp or Compression
 Wire Size AWG 18, 20, 22

Electrical

Voltage - Maximum 600V

Material Info

Old Part Number AA-2202V

Reference - Drawing Numbers

Product Specification PS-19902-008
 Sales Drawing SD-19003-001

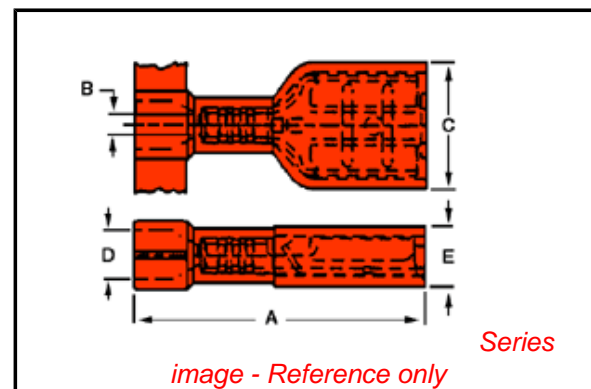

EU RoHS

ELV and RoHS Compliant
REACH SVHC
 Not Reviewed
Halogen-Free Status

China RoHS



Not Reviewed

Need more information on product environmental compliance?

Email productcompliance@molex.com
 For a multiple part number RoHS Certificate of Compliance, [click here](#)

Please visit the [Contact Us](#) section for any non-product compliance questions.

Search Parts in this Series

[19003Series](#)

Application Tooling | FAQ

Tooling specifications and manuals are found by selecting the products below. Crimp Height Specifications are then contained in the Application Tooling Specification document.

Global

Description	Product #
Hand Crimp Tool	0640010700

PLEASE CHECK WWW.MOLEX.COM FOR LATEST PART INFORMATION

MATERIAL NUMBER	ENGINEERING NUMBER	FITS MALE TAB SIZE	"A" MAX.	"C" MAX.	"E" MAX.	CARRIER CONFIGURATION
190030126	AA-2202V	.187X.020	.78/19.8	.316/8.03	.160/4.06	LOOSE PIECE
190030127	AA-2202VT	.187X.020	.78/19.8	.316/8.03	.160/4.06	TAPE MOUNT
190030128	AA-2202VC	.187X.020	.78/19.8	.316/8.03	.160/4.06	PLASTIC STRIP
190030129	AA-2203V	.187X.032	.78/19.8	.316/8.03	.160/4.06	LOOSE PIECE
190030130	AA-2203VT	.187X.032	.78/19.8	.316/8.03	.160/4.06	TAPE MOUNT
190030131	AA-2203VC	.187X.032	.78/19.8	.316/8.03	.160/4.06	PLASTIC STRIP
190030005	AA-220IVN	.250X.032	.86/21.8	.380/9.65	.180/4.57	LOOSE PIECE
190030007	AA-220IVNT	.250X.032	.86/21.8	.380/9.65	.180/4.57	TAPE MOUNT
190030111	AA-220IVNC	.250X.032	.86/21.8	.380/9.65	.180/4.57	PLASTIC STRIP

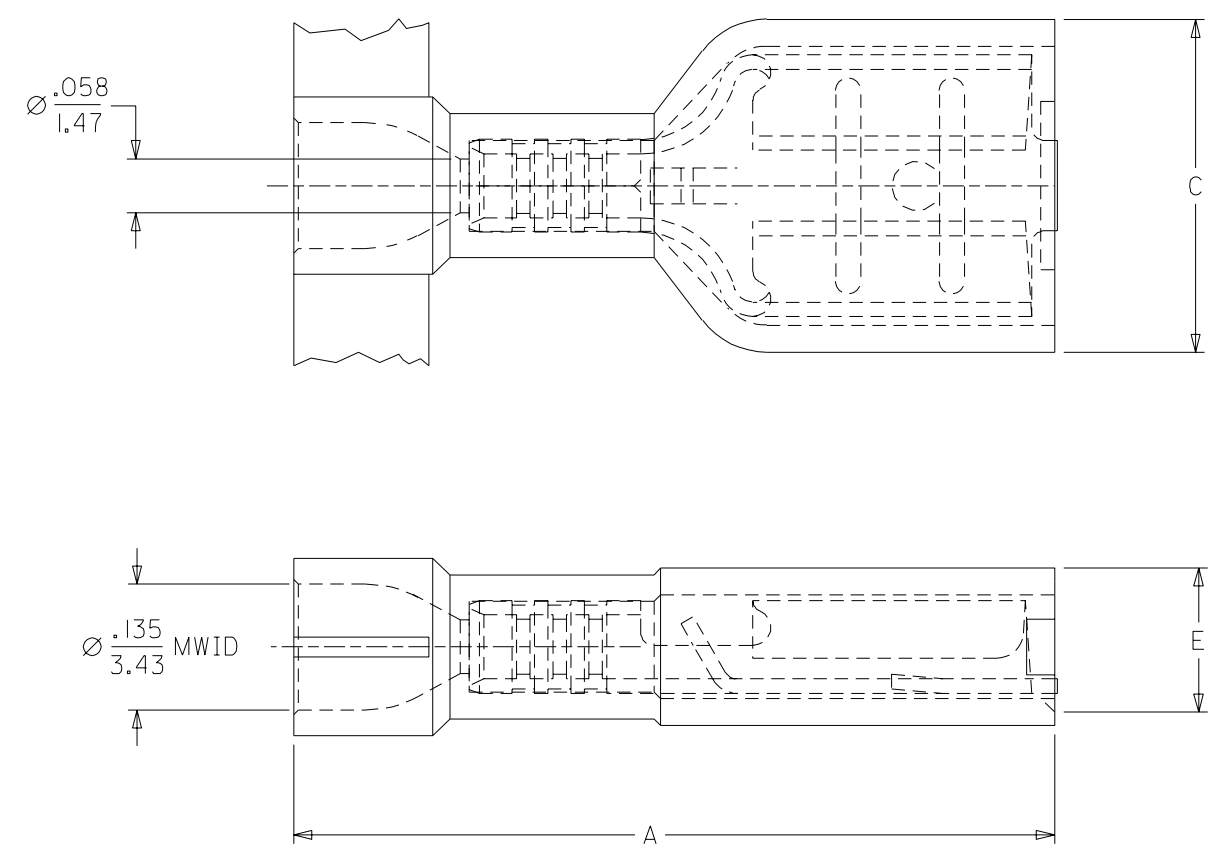

- NOTES:
- ① MATERIAL: TERMINAL: BRASS .016/0.41.
PLATING: ELECTRO-TIN
INSULATION: NYLON 6/6 94V-0 RATING
COLOR: RED
 - MWID = MAXIMUM WIRE INSULATION DIAMETER.
 - ALL DIMENSIONS = INCHES/MM

SALES DRAWING

REV'D NYLON COLOR EC NO. ETC2004-0101 DRWN: BRE 03/11/21 CHK: HEB 03/11/21 APPR: RWD 03/11/21	QUALITY SYMBOLS MAJOR $\blacktriangle = 0$ CRITICAL $\triangle = 0$	GENERAL TOLERANCES: (UNLESS SPECIFIED)		SCALE NO: NE	DESIGN UNITS <input type="checkbox"/> mm <input checked="" type="checkbox"/> INCH	THIRD ANGLE PROJECTION	DIMENSIONS: <input type="checkbox"/> mm <input checked="" type="checkbox"/> INCH <input type="checkbox"/> mm ONLY	SHT REV		
		4 PLACES $\pm 0.---$ $\pm .---$	3 PLACES $\pm 0.---$ $\pm .005$	2 PLACES ± 0.13 $\pm .01$	1 PLACE ± 0.25 $\pm .---$	DRAWN BY & DATE HEB 01/06/07		TITLE: FIQD FEMALE, INSULKRIMP 94V-0 MATERIAL 22-18 AWG		
		ANGULAR: $\pm 1/2^\circ$		DRAFT WHERE APPLICABLE MUST REMAIN WITHIN DIMENSIONS		CHECKED BY & DATE RWD 01/06/07		APPROVED BY & DATE RWD 01/06/07		
		CAD FILENAME S19003001.DGN		MATERIAL NO. SEE TABLE		DRAWING NO. SD-19003-001		SHEET NO. 1 OF 1		

THIS DRAWING CONTAINS INFORMATION THAT IS PROPRIETARY TO MOLEX INCORPORATED AND SHOULD NOT BE USED WITHOUT WRITTEN PERMISSION.