

SMA

RECEPTACLES, JACK & PLUG SOLDER POT

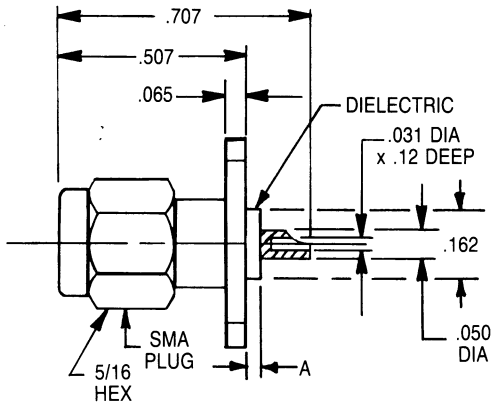
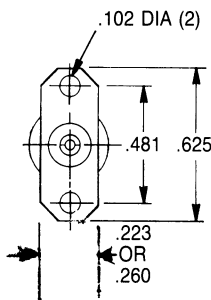
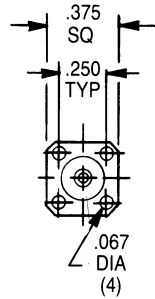

FIG. A



(a)



(b)

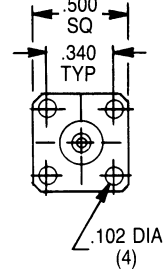

(c)

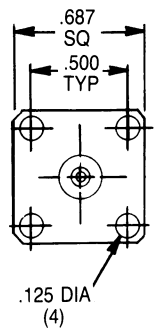

(d)

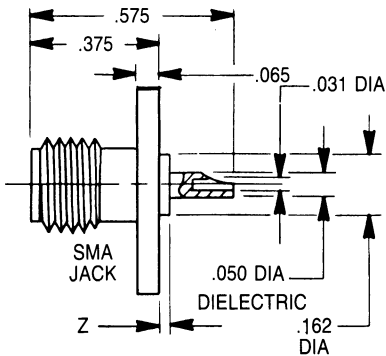
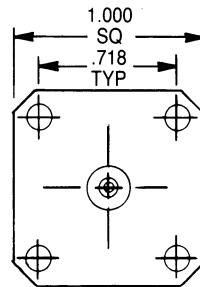
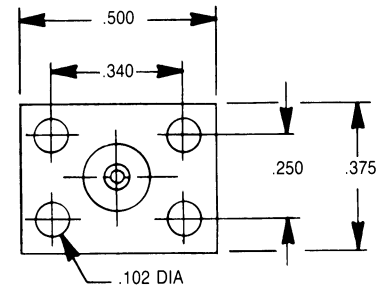

FIG. B



(e)



(f)

Dim. Z	Mounting(a) .223 x .625	Mounting(b) .375 square	Mounting(c) .500 square	Mounting(d) .687 square	Mounting(e) 1.000 square	Mounting(f) .50 x .375
JACK CAPTIVE CONTACT (Solder Pot Figure B.)						
000	S/M 2950-6140	S/M 2950-6138	S/M 2950-6081	S/M 2950-6298	S/M 2950-6150	
.025	S/M 2950-6062					
JACK NON CAPTIVE CONTACT (Solder Pot Figure B.)						
000						S/M 2951-6109
PLUG CAPTIVE CONTACT (Solder Pot Figure A.0)						
000	S/M 2955-6030**		S/M 2955-6242		S/M 2955-6202	
000	S/M 2955-6202SF*		S/M 2955-6022			
PLUG NON CAPTIVE CONTACT (Solder Pot Figure A.)						
000						S/M 2955-6315

MIL-C-039012/NOT equal to listed commercial parts ↑

JACK CAPTIVE CONTACT (Solder Pot Figure B.)						
.035↑	60-3002		60-3001			

↑ MIL-C-39012 item does not define dimensions Z

* Flange width is .260" (thin wall mating)

** Thick wall design

SMA FLANGE MOUNT RECEPTACLES

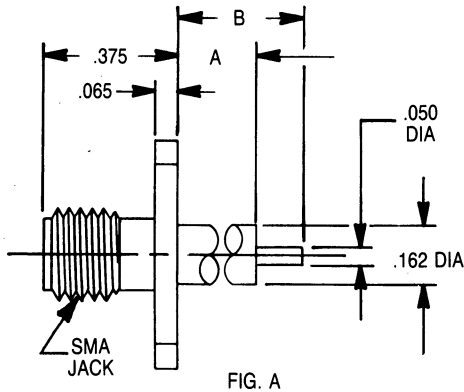
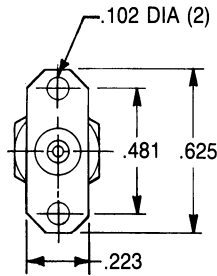
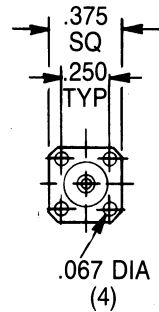

FIG. A



(a)



(b)

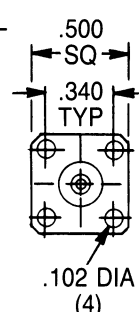

(c)

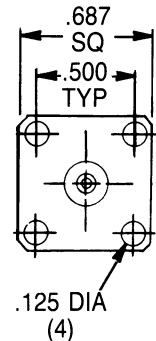

(d)

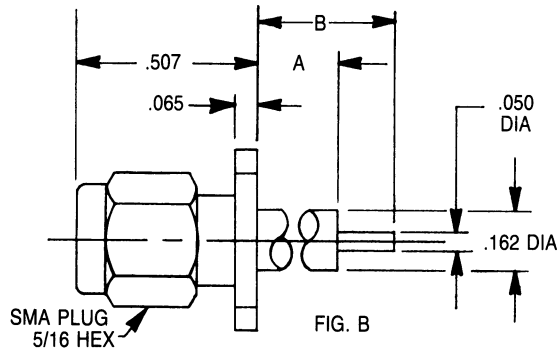
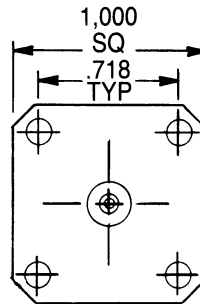
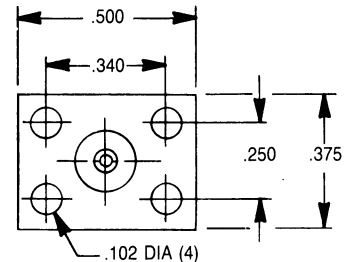

FIG. B



(e)



(f)

STRAIGHT SMA RECEPTACLES (Plain Conductor) JACK AND PLUG

FIG	DIM A	DIM B	2 Hole .223 X .625 (mounting a)	4 Hole .375 X .375 (mounting b)	4 Hole 500 X 500 (mounting c)
STRAIGHT FLANGE MOUNT CAPTIVE CONTACT					
A	.000	.050	S/M 2950-6099	S/M 2951-6055	S/M 2951-6065
A	.000	.100	S/M 2950-6192	S/M 2951-6056	S/M 2951-6066
A	.062	.188	S/M 2950-6218	S/M 2951-6057	S/M 2951-6067
A	.062	.250	S/M 2950-6233	S/M 2951-6058	S/M 2951-6068
A	.110	.230	S/M 2950-6599		
B	.110	.230	S/M 2955-6217		
A	.125	.250	S/M 2950-6251	S/M 2951-6059	S/M 2950-6739
A	.125	.312	S/M 2950-6306	S/M 2951-6060	S/M 2951-6069
A	.187	.312	S/M 2950-6377	S/M 2951-6061	S/M 2951-6245
A	.187	.312	S/M 2950-6393	S/M 2951-6062	S/M 2951-6070
A	.250	.375	S/M 2950-6396	S/M 2951-6063	S/M 2951-6071
A	.250	.500	S/M 2950-6413	S/M 2951-6064	S/M 2950-6917
A	.590	.705	S/M 2950-6200	S/M 2950-6220	S/M 2950-6061
B	.590	.705	S/M 2955-6262		S/M 2955-6356
B	.330	.488	S/M 2955-6217		S/M 2955-6081†
B	.330	.488			S/M 2955-6003†
NON CAPTIVE CONTACT					
B	.330	.488	S/M 2955-6209		S/M 2955-6091
A	.590	.705	S/M 2950-6002		

FIG	DIM A	DIM B	4 HOLE .687 X .687 (mounting d)	4 HOLE 1.00 X 1.00 (mounting e)	4 HOLE .500 X .375 (mounting f)
STRAIGHT FLANGE MOUNT CAPTIVE CONTACT					
A	.000	.050	S/M 2951-6072	S/M 2951-6082	
A	.000	.100	S/M 2950-6417	S/M 2951-6083	
A	.000	.312			S/M 2950-6828
A	.062	.188	S/M 2951-6073	S/M 2951-6084	
A	.062	.250	S/M 2951-6074	S/M 2951-6085	
A	.062	.312			S/M 2950-6835
A	.110	.230	S/M 2950-6479		
A	.125	.250	S/M 2951-6075	S/M 2951-6086	
A	.125	.312	S/M 2951-6076	S/M 2951-6087	S/M 2950-6836
A	.175	.375	S/M 2950-6371		
B	.175	.375	S/M 2955-6357		
A	.187	.312	S/M 2951-6077	S/M 2951-6088	S/M 2951-6840
A	.187	.375	S/M 2951-6078	S/M 2951-6089	
A	.250	.375	S/M 2951-6079	S/M 2951-6090	
A	.250	.500	S/M 2951-6080	S/M 2951-6091	S/M 2951-6103
A	.590	.705	S/M 2951-6081	S/M 2951-6092	S/M 2951-6104
B	.330	.488			S/M 2955-6295
NON CAPTIVE CONTACT					
B	.330	.488			S/M 2955-6301

ADD SUFFIX SF TO PART NUMBERS FOR STAINLESS FINISH VERSION.

† 2955-6081 IS PREFERRED AND IS EXTERNALLY SAME AS 2955-6003.

RECEPTACLES, RIGHT ANGLE (Con't)

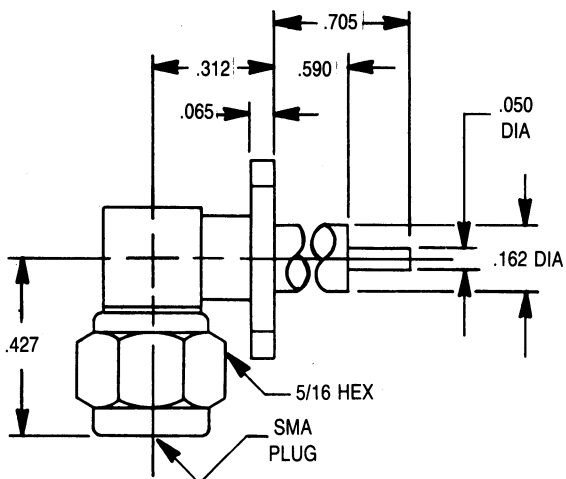

FOUR HOLE CUBED RIGHT ANGLE FLANGE MOUNT PLUG

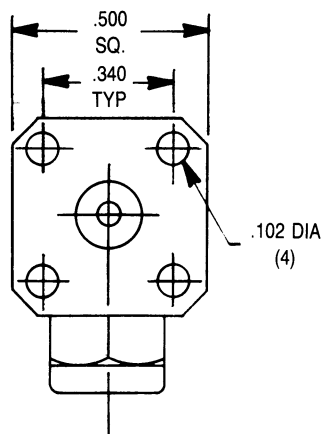

PART #
2961-6603

SLOT TERMINAL TWO HOLE STRAIGHT FLANGE MOUNT JACK

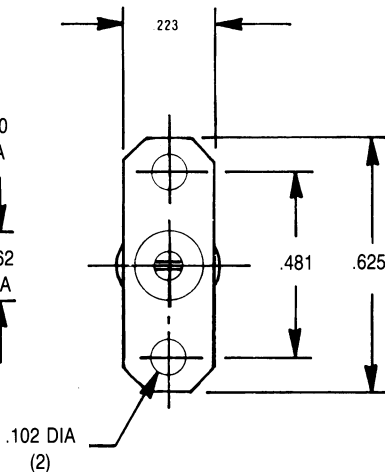
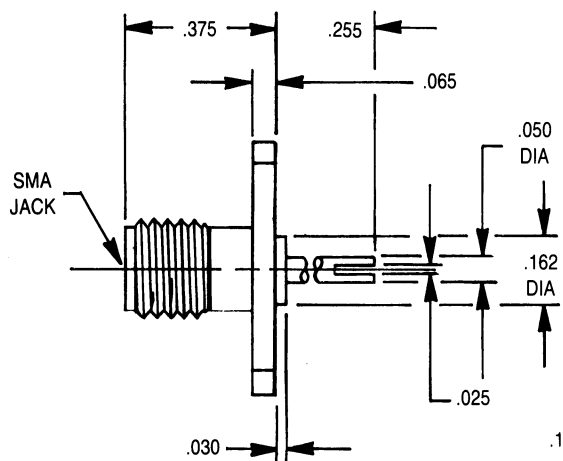

PART #
2950-6060

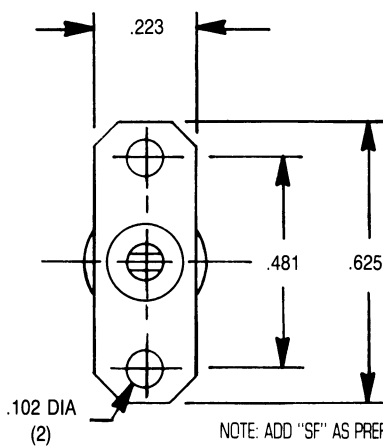
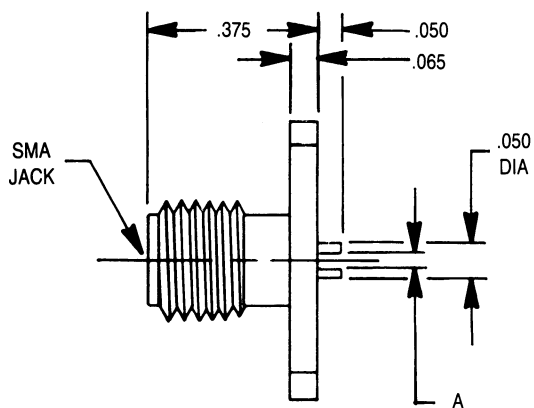

TWO HOLE STRAIGHT FLANGE MOUNT JACK

HORIZONTAL SLOT	
PART #	DIM. A
2950-6331	.012
2950-6332	.018
2950-6333	.028
2950-6360	.036

VERTICAL SLOT	
PART #	DIM. A
2950-6434	.012
2950-6435	.018
2950-6436	.028
2950-6437	.036

NOTE: ADD "SF" AS PREFIX TO PART NUMBER FOR STAINLESS FINISH VERSION.