

STRAIGHT BULKHEAD JACKS CLAMP TYPE

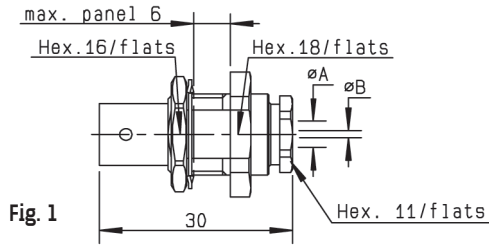

Fig. 1

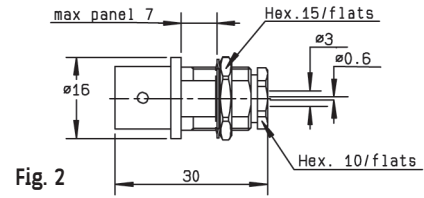

Fig. 2

| Cable group | Cable group dia. | Part number | Fig. | Dimensions (mm) | | Captive center contact | Panel drilling | Note |
|------------------------------|------------------|---------------------|------|-----------------|------|------------------------|----------------|----------------------------|
| | | | | A | B | | | |
| RG178/RG196 | 2/50/S | R141 323 000 | 1 | 2.2 | 0.6 | yes | P14 | Panel sealed |
| RG174/RG316 | 2.6/50/S | R141 304 000 | 2 | | | | | Totally sealed |
| | | R141 324 000 | 1 | 3.1 | 0.6 | Panel sealed | | |
| RG174/RG316/RD316 | 2.6/50/S + D | R141 324 200 | 1 | 3.1 | 0.6 | yes | | Panel sealed |
| RG58/RG141/RG142/RG223/RG400 | 5/50/S + D | R141 327 000 | 1 | 5.6 | 1.05 | no | | |
| RG401 | .141" | R141 338 007 | 1 | 3.68 | 1.27 | yes | | Panel sealed, non magnetic |

STRAIGHT BULKHEAD JACKS CRIMP TYPE FOR FLEXIBLE CABLES

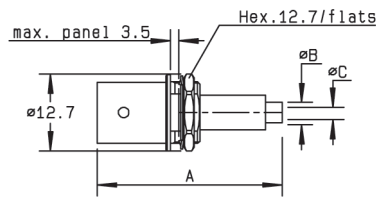

Fig. 1

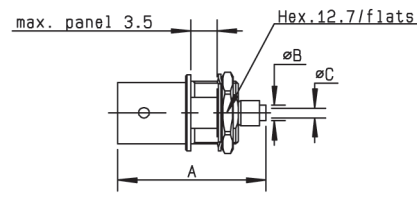

Fig. 2

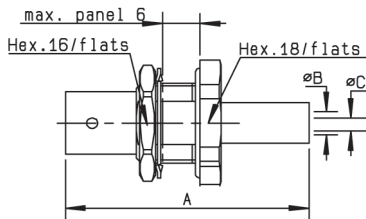

Fig. 3

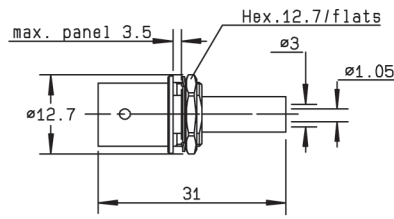

Fig. 4

| Cable group | Cable group dia. | Part number | Fig. | Dimensions (mm) | | | Captive center contact | Panel drilling | Note |
|-------------|------------------|---------------------|------|-----------------|------|------|------------------------|----------------|---|
| | | | | A | B | C | | | |
| RG174/RG316 | 2.6/50/S | R141 306 000 | 1 | 34 | 1.7 | | yes | P18 | |
| | | R141 306 503 | 2 | 26 | 2.95 | 0.6 | | | Reverse crimping/commercial version |
| | | R141 331 500 | 3 | 38.5 | 1.7 | | P14 or P20 | Panel sealed | |
| | | R141A 306 000 | 1 | 31 | 1.7 | 0.6 | no | P18 | ECO version |
| | | R141A 331 500 | 3 | 34 | 1.6 | 0.7 | no | P14 | Panel sealed ECO version |
| RG58/RG141 | 5/50/S | R141A 332 161 | 3 | 34 | 3.1 | 1.2 | no | | Panel sealed ECO version |
| | | R141 308 000 | 4 | | | | | P18 | Single piece body |
| | | R141 332 161 | | | | | yes | P14 or P20 | Panel sealed/commercial version |
| | | R141 332 500 | 3 | 35.5 | 3.1 | 1.05 | | | Panel sealed Reverse crimping/single piece body |

For other types of cables (75Ω, 93Ω or BT cables), please see "additional connectors" on page 10-32.

To download data sheets and assembly instructions, visit www.radiall.com & enter the part number in the Search box.

Bold part numbers represent products typically in stock & available for immediate shipment.

See page 8 and 9 for packaging information.