

SPECIFICATIONS

Mechanical

Insertion Force: 300g max.
Withdrawal Force: 25g min.
Durability: 2500 Cycles

Electrical

Voltage Rating: 125V
Current Rating: 7.0A
Contact Resistance: 25mW max.
Dielectric Withstanding Voltage: 500V AC
Insulation Resistance: 1000MW

Physical

Housing: Thermoplastic, UL 94V-0 rated in Black Color
Contact: Phosphor Bronze
Plating: See "ORDERING INFORMATION"
Board Lock: Phosphor Bronze
Operating Temperature: -40 to +105

Battery Connector

BR02 Series
Through Hole Type
Receptacle
2.00mm [.079"] Pitch

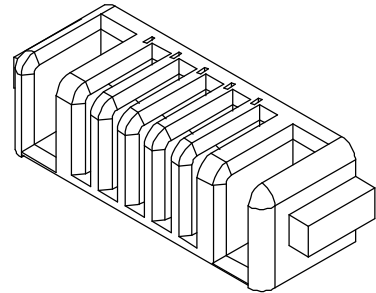

DRAWING

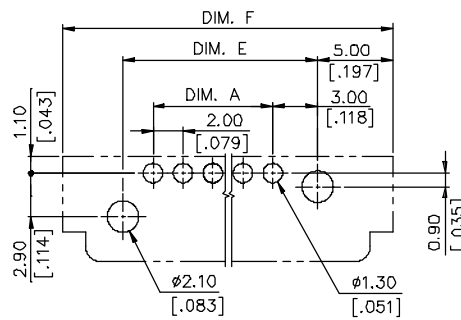
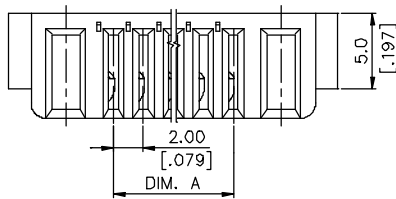

RECOMMENDED P.C.B. LAYOUT

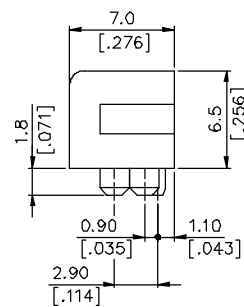
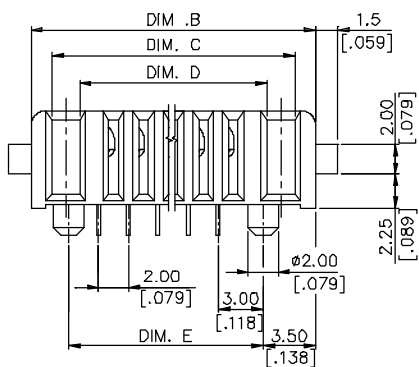

ORDERING INFORMATION

PRODUCT NO.: B R 02 0* 7

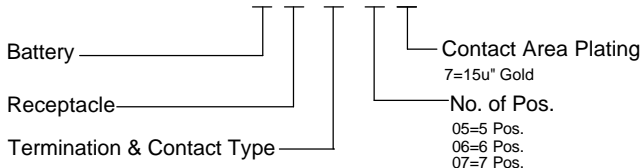

BR02077	7	12.00 [.472]	23.0 [.906]	20.2 [.795]	16.5 [.650]	17.00 [.669]	26.0 [1.024]
BR02067	6	10.00 [.394]	21.0 [.827]	18.2 [.717]	14.5 [.571]	15.00 [.591]	24.0 [.945]
BR02057	5	8.00 [.315]	19.0 [.748]	16.2 [.638]	12.5 [.492]	13.00 [.512]	22.0 [.866]
P/N	PDS.	DIM. A	DIM. B	DIM. C	DIM. D	DIM. E	DIM. F