

**MULTI-FIT™
"F" SERIES
MALE CONNECTORS
& SPLICE**

Premium Performance



Ordering Information — Multi-Fit™ "F" Male Connectors

PART NUMBER	POST I.D.	COLLAR I.D.	TOOL	DESCRIPTION	COLOR CODE
AMF59	.154	.309	1 + 2	—	Gold
AMF6	.191	.346	1 + 2	—	Gold
AMF59C	.154	.309	1 + 2	—	Clear
AMF6C	.191	.346	1 + 2	—	Clear
AMF59S	.154	.309	1 + 2	with Gel	Olive Drab
AMF6S	.191	.346	1 + 2	with Gel	Black
AMF59CS	.154	.309	1 + 2	with Gel	Clear
AMF6CS	.191	.346	1 + 2	with Gel	Clear

Tool: 1 = CST596, 2 = CT2460 Patent #5,217,393

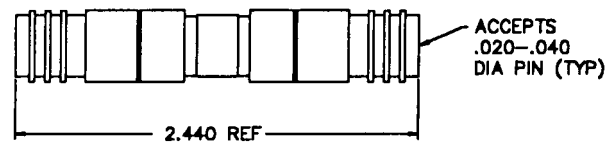
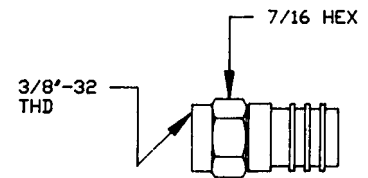

Ordering Information — Multi-Fit™ Splice

PART NUMBER	POST I.D.	COLLAR I.D.	TOOL	DESCRIPTION	COLOR CODE
81AMF59	.154	.309	1 + 2	—	Gold
81AMF6	.191	.346	1 + 2	—	Gold
81AMF59S	.154	.309	1 + 2	with Gel	Olive Drab
81AMF6S	.191	.346	1 + 2	with Gel	Black

Tool: 1 = CST596, 2 = CT2460 Patent #5,217,393

Dimensions shown are for reference only. Dimensions are in inches.

Premium Performance

**MULTI-FIT™
GROUND BLOCK
& CABLE TO "F" FEMALE
CONNECTORS**

Ordering Information — Multi-Fit™ Ground Block: Single

PART NUMBER	POST I.D.	COLLAR I.D.	TOOL	DESCRIPTION	COLOR CODE
GB59AMF	.154	.309	1 + 2	—	Gold
GB6AMF	.191	.346	1 + 2	—	Gold
GB59AMFS	.154	.309	1 + 2	with Gel	Olive Drab
GB6AMFS	.191	.346	1 + 2	with Gel	Black

Tool: 1 = CST596, 2 = CT2460 Patent #5,217,393

All Supplied Screws Have Slotted - 1/4" Hex Combination Head

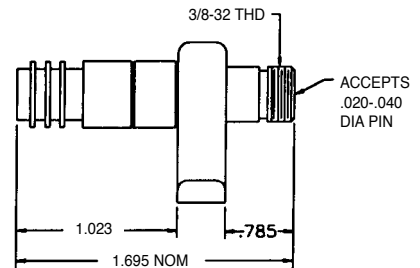

Ordering Information — Multi-Fit™ Cable to "F" Female Connectors

PART NUMBER	POST I.D.	COLLAR I.D.	TOOL	DESCRIPTION	COLOR CODE
AMF59FF	.154	.309	1 + 2	—	Gold
AMF6FF	.191	.346	1 + 2	—	Gold
AMF59FFS	.154	.309	1 + 2	with Gel	Olive Drab
AMF6FFS	.191	.346	1 + 2	with Gel	Black

Tool: 1 = CST596, 2 = CT2460 Patent #5,217,393

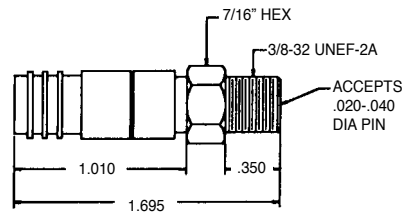

Ordering Information — Multi-Fit™ Cable to "F" Male, Right Angle Connectors

PART NUMBER	FIG.	POST I.D.	COLLAR I.D.	TOOL	DESCRIPTION	COLOR CODE
AMF906	A	.191	.346	1 + 2	—	Gold
AMF9011	B	.295	.477	3 + 4	—	Gold
AMF906S	A	.191	.346	1 + 2	with Gel	Black
AMF9011S	B	.295	.477	3 + 4	with Gel	Black

Tool: 1 = CST596, 2 = CT2460, 3 = CST11, 4 = CT611QS Patent #5,217,393

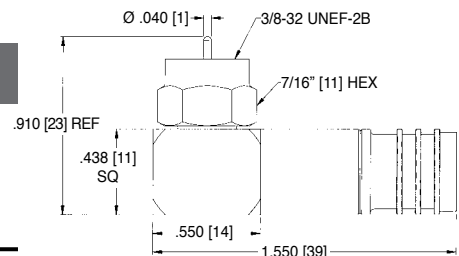

FIG. A

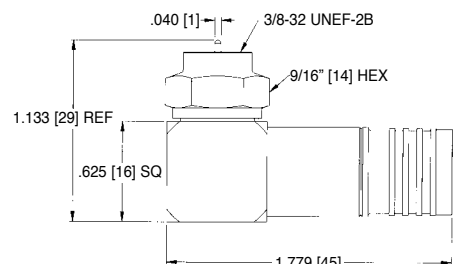

FIG. B

Dimensions shown are for reference only. Dimensions are in inches.