

- BGA adapter/socket systems are a reliable way to make BGAs pluggable, they may also be used as a high density board-to-board interconnect.
- The BGA device is soldered to a 8737/4048 adapter (or a 4098/4054 adapter is soldered to a PCB); and then either one can be plugged into a 8214 surface mount socket.
- Both socket and adapter have the same footprint as the BGA device.
- Insertion force is .40N per pin for standard pins 8737/4098. Tapered EZ-IN pins 4048/4054 reduce insertion force to only .08N, and are recommended for pin counts greater than 500. A pry-bar tool (part #828-01-010) is available for extraction.
- Insulator material is FR-4 epoxy having a TCE to match the BGA device and circuit board.
- Mill-Max offers the option of having the solder surfaces of the 4098/4054 adapters and 8214 socket pre-tinned.

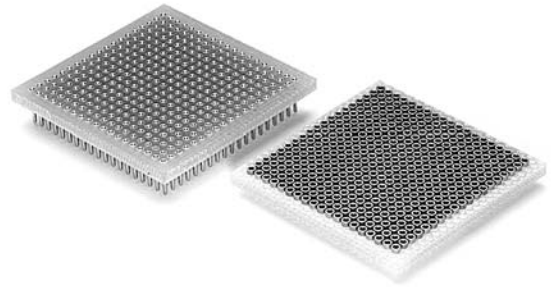

BGA MOUNT ADAPTER PINS

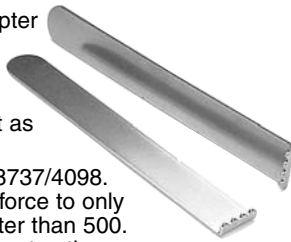
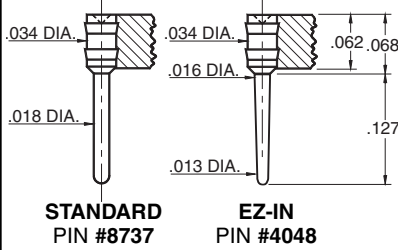

PCB MOUNT STANDARD ADAPTER PIN #4098

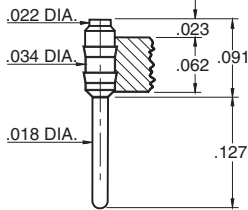

PCB MOUNT EZ-IN ADAPTER PIN #4054

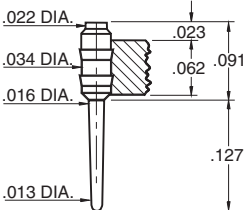

Ordering Information

FOR BGA MOUNT ADAPTER PINS

Series			Plating Code			Window						
5	8	7	-	1	0	-			4	3	7	STAN- DARD
5	4	0	-	1	0	-			4	4	8	EZ-IN PIN

FOR PCB MOUNT STANDARD ADAPTER PIN

5	4	0	-	1	0	-			4	9	8	PRE- TINNED
5	9	7	-	1	0	-			4	1	6	

FOR PCB MOUNT EZ-IN ADAPTER PIN

5	4	0	-	1	0	-			4	5	4	PRE- TINNED
5	9	7	-	1	0	-			4	3	0	

No. of pins Grid size Pattern #

Determined from footprint pattern pages 113 to 115

PLATING CODE XX=	10		
Pin Plating	10μ" Au		

FOR BGA FEMALE SOCKET

Series			Plating Code			Window						
5	8	2	-	1	1	-			4	1	4	PRE- TINNED
5	9	5	-	1	1	-			4	2	6	

No. of pins Grid size Pattern #

Determined from footprint pattern pages 113 to 115

SPECIFY PLATING CODE XX=	11		
Sleeve (Pin)	10μ" Au		
Contact (Clip)	10μ" Au		

SMT RECEPTACLE TYPE #8214

