

可変コイル Adjustable Type Coils K Type Series

Coils, Filters

K5-S

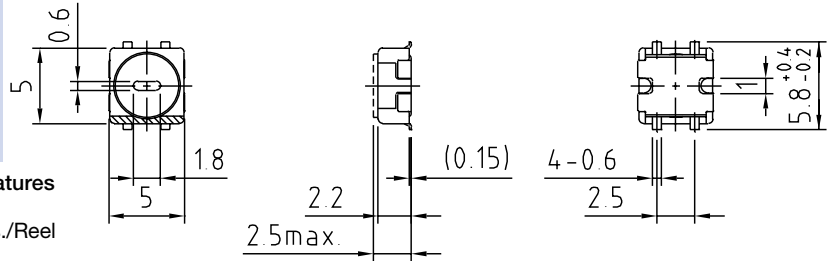
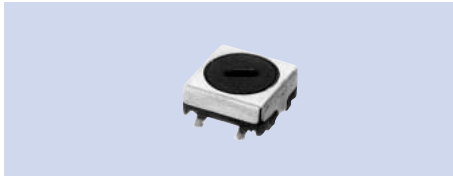

仕様/Specifications

- (1) 1~300 μ H (4) —
- (2) 0.1~20MHz (5) 40~70
- (3) F: $\pm 2\%$
L: $\pm 4\%$

特長/Features

- SMD
- 1000pcs./Reel

K5-S2

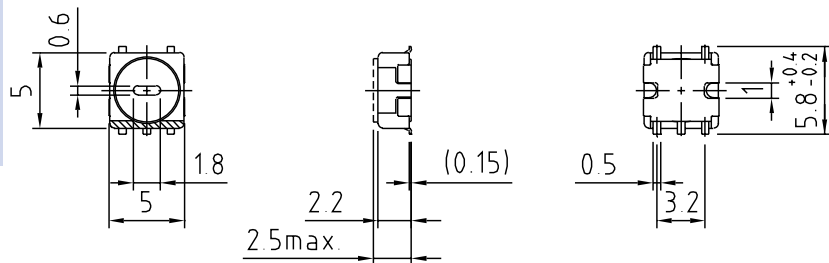

仕様/Specifications

- (1) 1~300 μ H
- (2) 0.1~20MHz
- (3) F: $\pm 2\%$
L: $\pm 4\%$
- (4) —
- (5) 40~70

特長/Features

- SMD
- 1000pcs./Reel

K5-N1

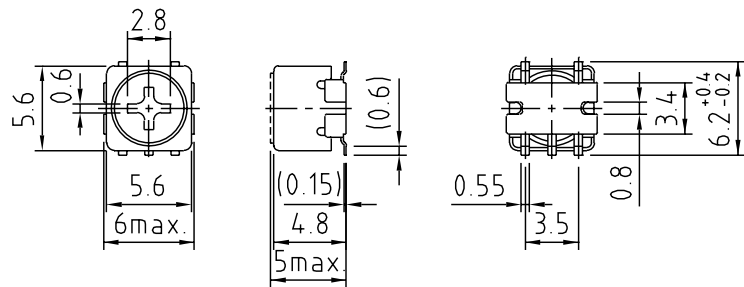

仕様/Specifications

- (1) 1~1200 μ H
- (2) 0.1~20MHz
- (3) F: $\pm 2\%$
L: $\pm 5\%$
- (4) 5~15000pF $\times 2$
- (5) 50~80

特長/Features

- SMD
- 1000pcs./Reel

K5-N

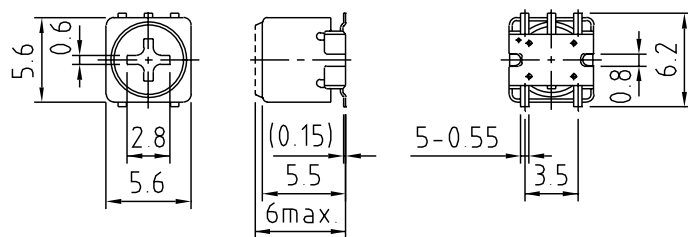

仕様/Specifications

- (1) 1~5900 μ H
- (2) 0.1~20MHz
- (3) F: $\pm 2\%$
L: $\pm 5\%$
- (4) 5~15000pF $\times 2$
- (5) 50~100

特長/Features

- SMD
- 1000pcs./Reel

- (1) インダクタンス/Inductance
- (2) 使用周波数/Operational frequency
- (3) F&L可変範囲/Variable range of F & L
- (4) 内蔵可能容量/Internal capacitance
- (5) 無負荷 Q/Unloaded Q

K5-R2



仕様/Specifications

- (1) 1~6700 μ H
- (2) 10~500kHz
- (3) F: $\pm 2\%$
L: $\pm 4\%$
- (4) 5~15000pF $\times 2$
- (5) 50~80

特長/Features
SMD
500psc./Reel

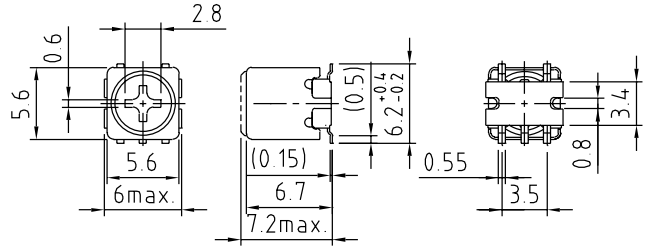

K5-H



仕様/Specifications

- (1) 1~1000 μ H
- (2) 0.1~20MHz
- (3) F: $\pm 2\%$
L: $\pm 5\%$
- (4) 10~10000pF
- (5) 50~100

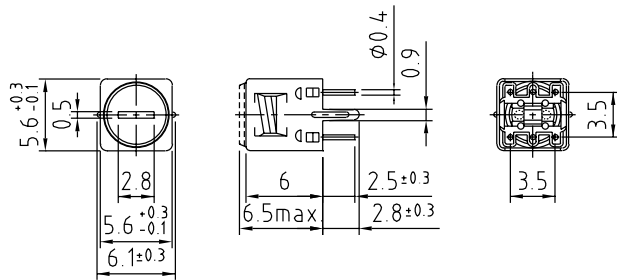

K5-C



仕様/Specifications

- (1) 1~1000 μ H
- (2) 0.1~20MHz
- (3) F: $\pm 2\%$
L: $\pm 5\%$
- (4) 10~10000pF
- (5) 50~100

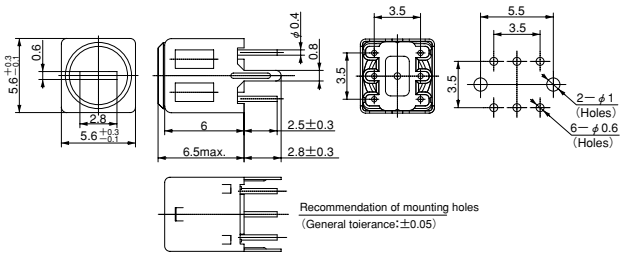

K7-P

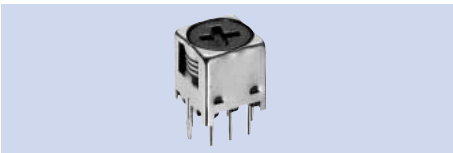

仕様/Specifications

- (1) 1~1600 μ H
- (2) 0.1~20MHz
- (3) F: $\pm 2\%$
L: $\pm 5\%$
- (4) 10~18000pF
- (5) 50~110

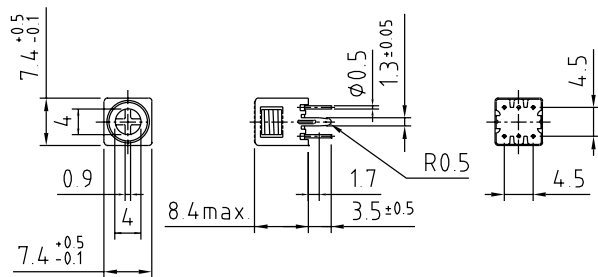

K7-P1

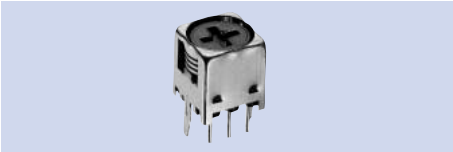

仕様/Specifications

- (1) 0.1~7mH
- (2) 10~300kHz
- (3) F: $\pm 2\%$
L: $\pm 5\%$
- (4) —
- (5) 40~70

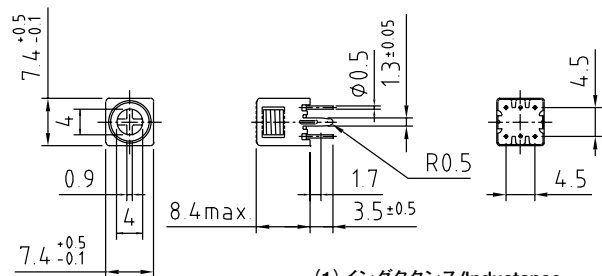

- (1) インダクタンス/Inductance
- (2) 使用周波数/Operational frequency
- (3) F & L可変範囲/Variable range of F & L
- (4) 内蔵可能容量/Internal capacitance
- (5) 無負荷 Q/Unloaded Q

K7-D

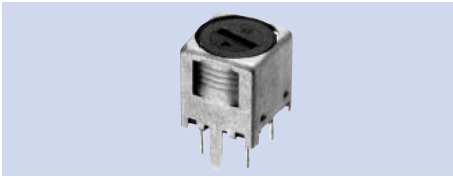

仕様/Specifications

- (1) 5~100mH
- (2) 10~300kHz
- (3) F: ±2%
L: ±5%
- (4) —
- (5) 50~80

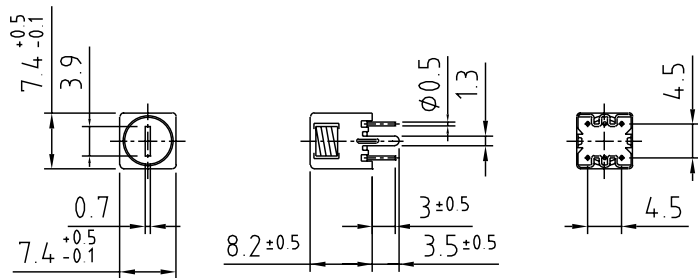

K7-T



仕様/Specifications

- (1) 1~850μH
- (2) 0.1~20MHz
- (3) F: ±2%
L: ±5%
- (4) 10~430pF
- (5) 60~110

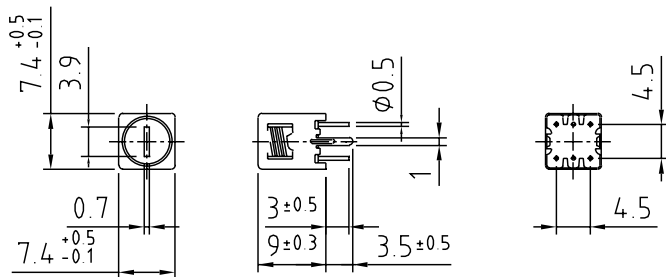

K7-T1

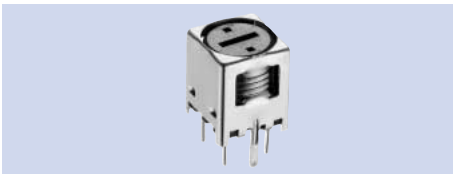

仕様/Specifications

- (1) 0.1~6mH
- (2) 10~300kHz
- (3) F: ±2%
L: ±5%
- (4) —
- (5) 40~70

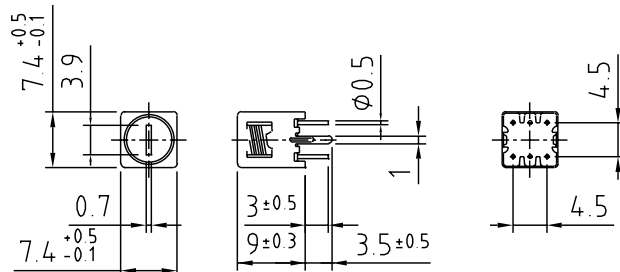

K7-T4

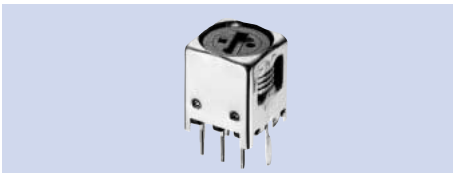

仕様/Specifications

- (1) 1~15mH
- (2) 10~300kHz
- (3) F: ±2%
L: ±5%
- (4) 10~18000pF
- (5) 40~70

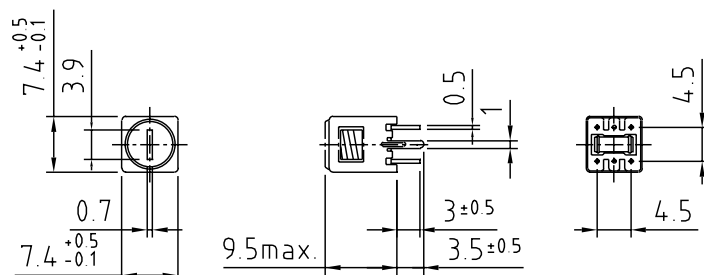

- (1) インダクタンス/Inductance
- (2) 使用周波数/Operational frequency
- (3) F&L可変範囲/Variable range of F & L
- (4) 内蔵可能容量/Internal capacitance
- (5) 無負荷 Q/Unloaded Q

K7-T3

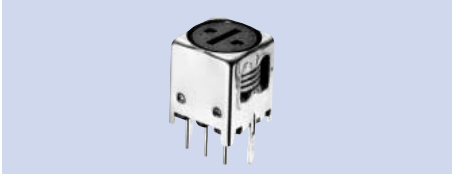

仕様/Specifications

- (1) 1~40mH
- (2) 0.1~1MHz
- (3) F: ±2%
L: ±5%
- (4) —
- (5) 50~140

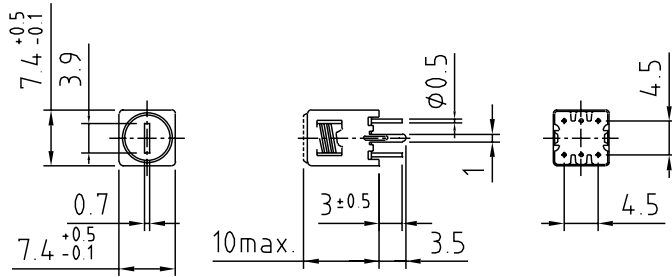

K7-H5 (K7-H6)



仕様/Specifications

- (1) 1~1000 μ H
- (2) 0.1~20MHz
- (3) F: ±3%
L: ±6%
- (4) 10~18000pF
- (5) 50~140

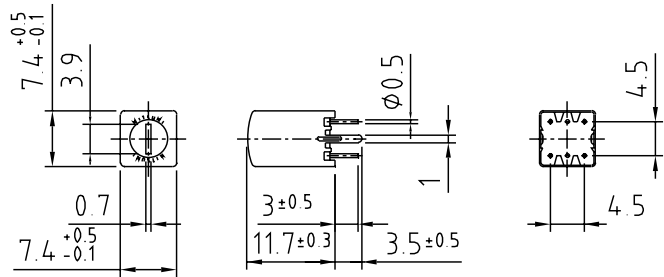

K7-J

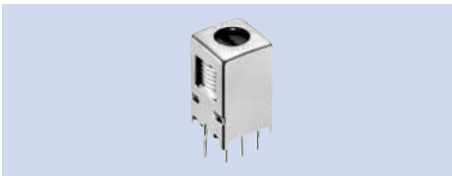

仕様/Specifications

- (1) 1~40mH
- (2) 10~300kHz
- (3) L: ±6%
- (4) —
- (5) 40 ~70

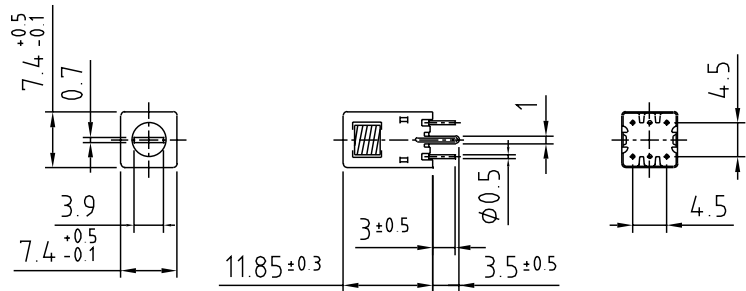

K7-J5

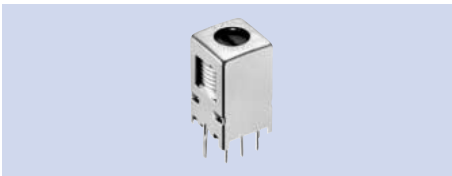

仕様/Specifications

- (1) 1~40mH
- (2) 10~300kHz
- (3) F: ±3%
L: ±6%
- (4) 10~18000pF
- (5) 40~70

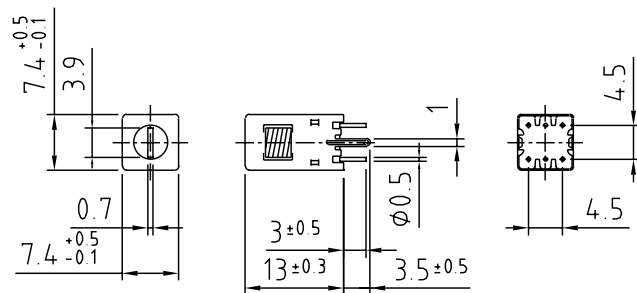

- (1) インダクタンス/Inductance
- (2) 使用周波数/Operational frequency
- (3) F & L可変範囲/Variable range of F & L
- (4) 内蔵可能容量/Internal capacitance
- (5) 無負荷 Q/Unloaded Q