

LOADING PATTERN MATING SIDE

| | | | | | | | | | | | | | | | | | | | | | |
|---|---|---|---|---|---|---|---|---|---|---|---|---|---|---|---|---|---|---|---|---|---|
| f | 6 | 6 | 6 | 6 | 6 | 6 | 6 | 6 | 6 | 6 | 6 | 6 | 6 | 6 | 6 | 6 | 6 | 6 | 6 | 6 | 6 |
| e | A | 7 | 7 | 7 | 7 | 4 | 7 | 7 | 7 | 7 | G | 7 | 7 | 7 | G | 7 | 7 | 7 | 7 | 7 | A |
| d | A | 7 | 7 | 7 | 7 | 4 | 7 | 7 | 7 | 7 | 7 | 7 | 7 | 7 | 7 | 7 | 7 | 7 | 7 | 7 | A |
| c | A | 7 | 7 | 7 | 7 | 4 | 7 | 7 | 7 | 7 | 7 | 7 | 7 | 7 | 7 | 7 | 7 | 7 | 7 | 7 | A |
| b | A | 7 | 7 | 7 | 7 | 4 | 7 | 7 | 7 | 7 | 7 | 7 | 7 | 7 | 7 | 7 | 7 | 7 | 7 | 7 | A |
| a | A | 7 | 7 | 7 | 7 | 4 | 7 | 7 | 7 | 7 | G | 7 | 7 | 7 | G | 7 | 7 | 7 | 7 | 7 | A |
| z | 6 | 6 | 6 | 6 | 6 | 6 | 6 | 6 | 6 | 6 | 6 | 6 | 6 | 6 | 6 | 6 | 6 | 6 | 6 | 6 | 6 |
| P | 0 | | | | | | 0 | | | | 1 | | | | | 1 | | | | 2 | |
| S | 1 | | | | | | 5 | | | | | | | | | | | | | 0 | 5 |

LOADED CONNECTOR ASSEMBLY (FOR EXAMPLE)

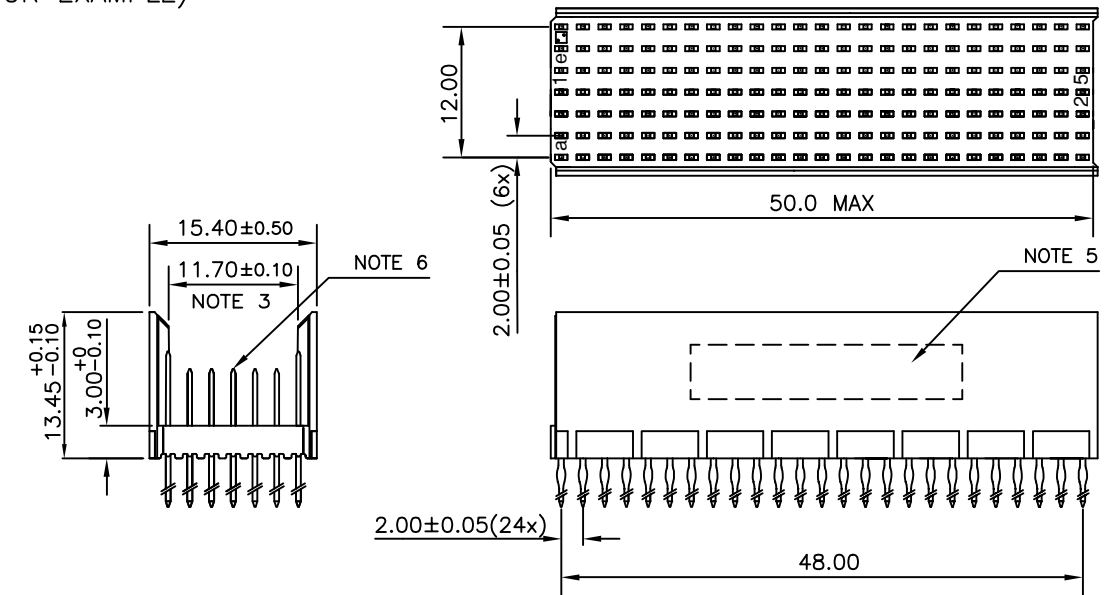

CONTACT OVERVIEW

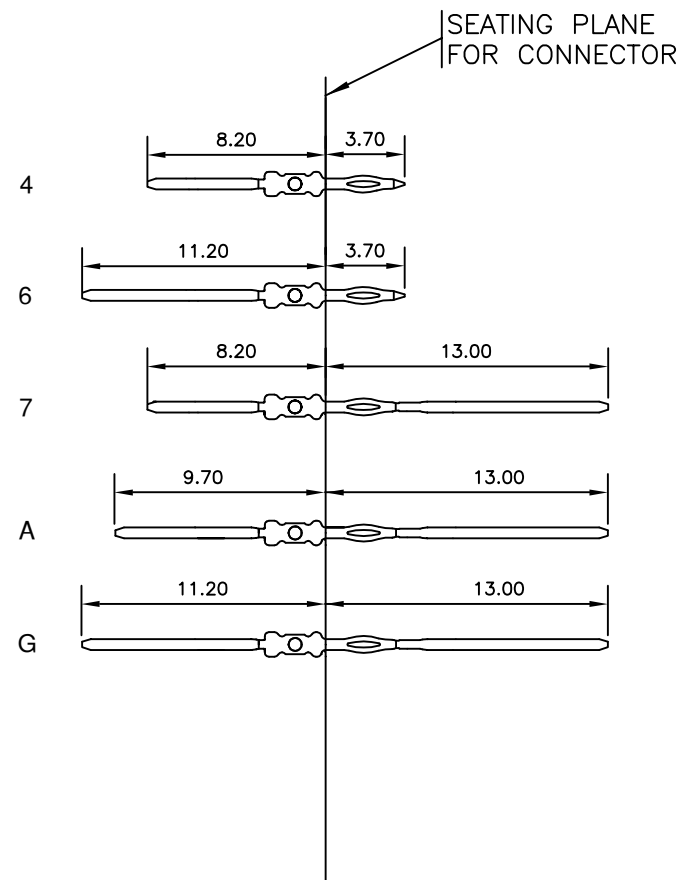

LAY-OUT P.C.B.-HOLE

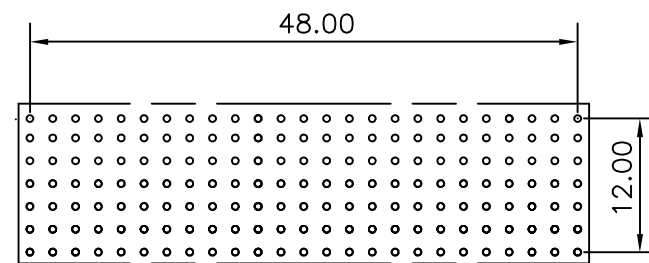

HM2P08PKR181 LEAD FREE INDICATOR : LF = LEAD FREE
(DIGIT 15 & 16)

PLATING CODE (DIGIT 13 AND 14)
(REF DRW NO. BS,C , 201844 , 003)

NOTES

- THIS PRODUCT IS CSA APPROVED.
- THIS PRODUCT IS UL RECOGNIZED.
- MEASURED AT THE BOTTOM.
- MATERIAL CONTACT: PHOSPHORBRONZE
HOUSING: CREAM WHITE GLASS FILLED POLYESTER UL-94V0
- CONNECTOR PRINTED WITH P/N AND DATE CODE.
- FOR ACTUAL CONTACT LOADINGS, SEE LOADING PATTERN MATING SIDE.
- SHAPE OF CONNECTOR HOUSING CAN ALTER DEPENDING ON PRODUCTION LOCATION
- THE PRODUCT (LF) MEETS EUROPEAN UNION DIRECTIVES AND OTHER COUNTRY REGULATIONS AS DESCRIBED IN GS-22-008
- FOR RECOMMENDED PTH DIMENSIONS REFER DRAWING : BS, A , 201572 , 001

CATALOG NO: HM2P08PKR181----

| | | | | | | | | | | |
|---------------------------|----------------|------|------------|---------------------------------------|-------------------------------|------------------|---|--|--|--|
| mat'l. code SEE NOTE 4 | | | | surface ISO 1302 ✓ | tolerance ISO 406 ISO 1101 | projection MM | product family MILLIPACS | | | |
| ltr | ecn no | dr | date | tolerances unless otherwise specified | | MM | title MPACS 5+2R STR HDR PF CONN TYPE B | | | |
| A | 105-0266 | MINI | 2005-12-05 | angles | linear | | | | | |
| B | 106-0141 | MINI | 2006-08-05 | 0°±1° | | scale | | | | |
| | | | | dr | MINI K VANDANATH | 2005-12-05 | dwg no sheet 1 of 1 size BS, C ,203028,647 A3 | | | |
| | | | | engr | BIJU K PAUL | 2005-12-05 | | | | |
| | | | | chr | BIJU K PAUL | 2006-08-05 | type Product Customer Drawing | | | |
| | | | | appd | BIJU K PAUL | 2006-08-05 | | | | |
| sheet index | revision sheet | B | 1 | | | | | | | |

| | | | | | | | | | | | | | | | | | | | | | | | | | | | | | | | | |
|----------|--|----|----|----|----|----|----|----|----|----|----|----|----|----|----|----|----|----|----|----|----|----|----|----|----|----|----|----|----|----|----|----|
| GEN. ST. | | 01 | | 02 | | 03 | | 04 | | 05 | | 06 | | 07 | | 08 | | 0D | | 50 | | 60 | | 70 | | 80 | | 90 | | | | |
| INT. ST. | | 10 | 11 | 12 | 13 | 14 | 18 | 20 | 31 | 32 | 33 | 34 | 38 | 39 | 40 | 42 | 43 | 44 | 45 | 46 | 48 | 56 | 70 | 72 | 73 | 75 | 76 | 81 | 82 | 83 | 84 | 88 |

| REV. | DATE | DESCRIPTION | BY | C'K'D' |
|------|------------|-------------|--------|--------|
| D | 2005-06-01 | 105-0083 | ALEX B | BKP |
| E | 2006-08-03 | 106-0119 | ALEX B | BKP |
| F | 2007-04-11 | 107-0049 | ALEX B | BKP |
| G | 2007-05-17 | 107-0058 | ALEX B | BKP |

MILLIPACS : CONTACT PLATING CODE OVERVIEW

HM2---P------(L-)(LF)

FOR LEAD FREE PLATING
OPTIONAL (NOTE 1)

PLATING CODE (DIGIT 13 AND 14)

| PLATING CODE | DESCRIPTION | PERFORMANCE |
|--------------|---|---|
| L9 | MALE CONN.: SHORT / WIRE WRAP CONT. FEMALE CONNECTOR | TELCORDIA UE |
| E9 | MALE CONN.: SHORT / WIRE WRAP CONT. FEMALE CONNECTOR | PERFORMANCE LEVEL 1 (500 mating cycles) |
| N9 | MALE CONN.: SHORT / WIRE WRAP CONT. FEMALE CONNECTOR | PERFORMANCE LEVEL 2 (250 mating cycles)/ TELCORDIA CO |
| Z1 | MALE CONN.: SHORT / WIRE WRAP CONT. FEMALE CONNECTOR | PERFORMANCE LEVEL 3 (50 mating cycles) |
| GE | MALE CONN.: REAR PLUG-UP CONTACTS | TELCORDIA UE |
| GL | MALE CONN.: REAR PLUG-UP CONTACTS | PERFORMANCE LEVEL 1 (500 mating cycles) |
| GF | MALE CONN.: REAR PLUG-UP CONTACTS | PERFORMANCE LEVEL 2 (250 mating cycles)/ TELCORDIA CO |
| GC | MALE CONN.: REAR PLUG-UP CONTACTS | PERFORMANCE LEVEL 3 (50 mating cycles) |

NOTE :

- IN CASE OF STR HDR CONNECTORS :
EXTENSIONS CAN BE ADDED TO THE PLATING CODE
IF LUBRICATED CONTACTS ARE REQUIRED
L : LUBRICATED
L1: LUBRICATED TO MEET TELCORDIA GR-1217 CORE REQUIREMENTS
- PLATING AT EON AREA
LF : Sn MATT FINISH PLATING
ALL OTHER PART NOS : SnPb PLATING
- FOR PRODUCT SPEC. REFER GS-12-203

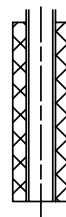
REF NOTE 2 FOR
EON PLATING

| | | | | |
|---|--|--------------------|-----------------|--|
| 1DEC $\pm 0,2$ 2DEC $\pm 0,1$ ANGLES $\pm 1^\circ$ | APPR. DRAFT CHECKED | DATE 2003-03-21 | SIGN. M.Fret | MPACS CONTACT PLATING OVERVIEW CAT. No. HM2---P------(L-) |
| WE RESERVE THE RIGHT TO CHANGE DIMENSIONS OR REQUIREMENTS WITHOUT PRIOR NOTICE. | PROD. MGR. PR. ENG. MGR. PR. MGT. MGR. | | | FCI www.fciconnect.com |
| ALL DIMENSIONS IN MM | REFERENCES | | | SCALE |
| | | BS,C ,201844,003 G | | |