

Power Inductors

C3-K,C4-K,C5-K,C6-K,C8-K,C10-K,C12-K,C13-K Series

Coils, Filters

OUTLINE

High efficiency (low DCR) choke coil for battery-driven portable electronic equipment power supplies (DC-DC compander, switching power supply) and other electronic equipment.

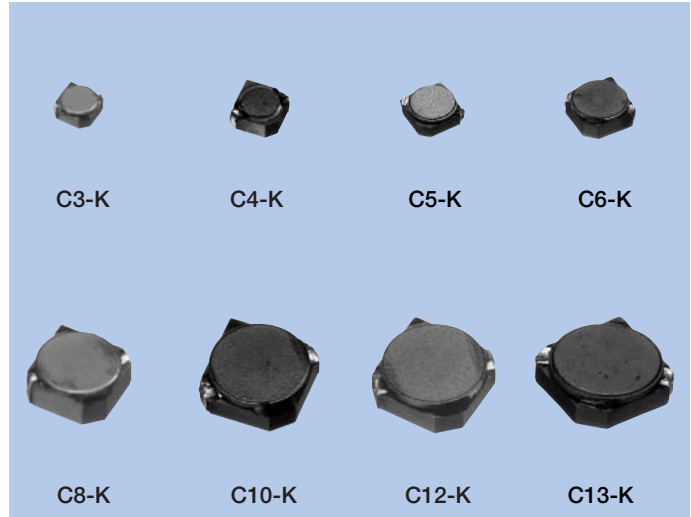

FEATURES

1. Less than one-half the conventional number of DC resistors.
2. Low height, able to handle high power.
3. The "closed magnetic circuit" structure reduces electromagnetic interference.

DATA LIST

Type	Size (mm)	H length (Unit : mm)	Inductance	Operational Frequency (KHz)	Rated Current (A)	DC Resistance (mΩ)	Pcs/Reel
C3-K1.8L	3.8×3.8	1.8	1.2~68	10~500	0.27~2.3	25~980	3000
C4-K1.8L	4.8×4.8	1.9	1~150	10~500	0.22~3.0	16~2016	2000
C4-K2.5L	4.8×4.8	2.5	1~150	10~500	0.27~3.2	38~1423	2000
C4-K3L	4.8×4.8	3.0	1~150	10~500	0.15~2.6	14~484	2000
C5-K1.8L	5.6×5.6	1.9	1~150	10~500	0.28~3.9	12~1300	2000
C5-K2.5L	5.6×5.6	2.6	1~150	10~500	0.30~3.4	26~998	2000
C5-K3L	5.6×5.6	3.0	1~150	10~500	0.30~3.7	18~757	2000
C6-K1.8L	6.6×6.6	1.9	1~150	10~500	0.36~3.7	12~1560	1000
C6-K3L	6.6×6.6	3.2	1~150	10~500	0.40~5.5	11~647	1000
C8-K4L	8×8	4.0	1~150	10~500	0.73~7.0	10~421	500
C8-K5L	8×8	5.0	1~150	10~500	0.73~7.0	11~348	500
C10-K4L	10×10	4.0	1~150	10~500	0.85~7.1	13~375	1000
C12-K4.5L	12×12	4.5	1~150	10~500	1.2~7.1	8~516	800
C13-K4.5L	13×13	4.5	1~150	10~500	1.33~11.0	9~407	800

DIMENSIONS

C3-K Series

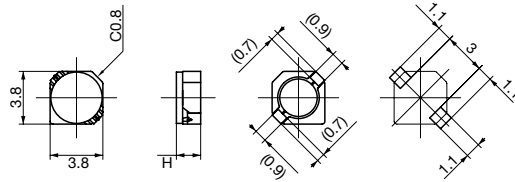

C4-K Series

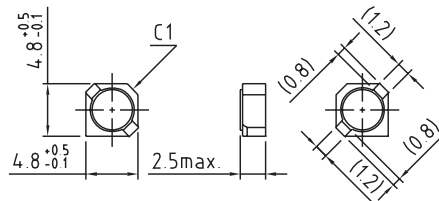

C5-K Series

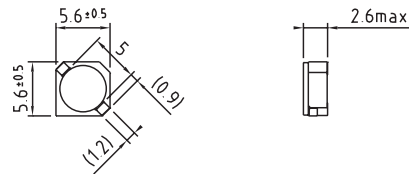

C6-K Series

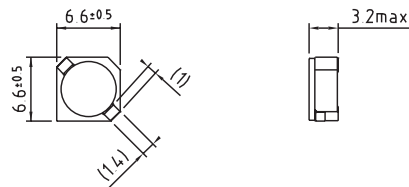

C8-K Series

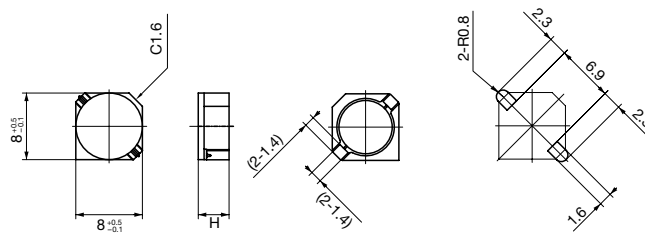

C10-K Series

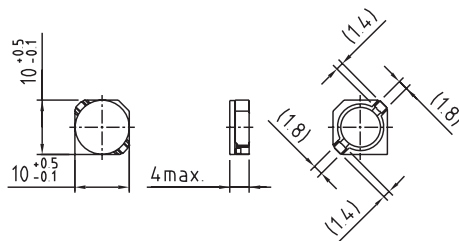

C12-K Series

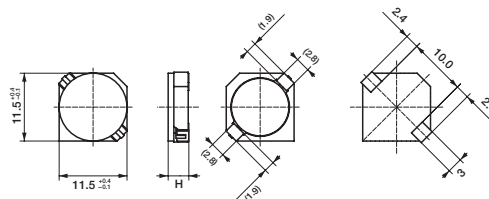

C13-K Series

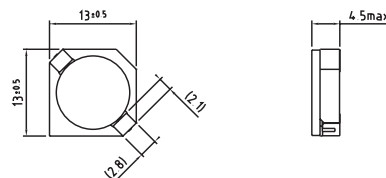

Unit : mm