

L 237 100 Power connectors

► Expert Range

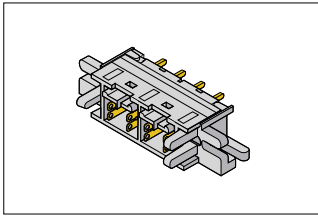

Male socket.
Plug soldered on P.C.B.
Modular mounting (panel or through panel mounting).

Pin 0.8 x 1 x 3.5 mm
.031" x .039" x .138"
P.C.B. thickness ≤ 2.4 mm .094"
P.C.B. holes Ø 1.5 mm .059"
Body : UL94 V0 - PC
Grey □

Spacing 7.62 mm .300"

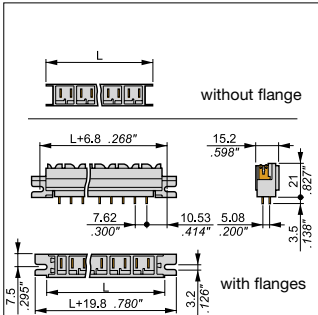

Socket L 237 100 compatible with :

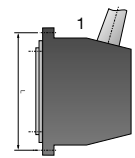
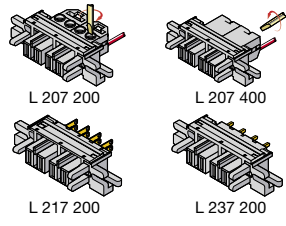

Ordering details

N. Poles	Weight kg	Packaging	L. mm	Order code
Without flange :				
4	0.0083	20	39.90	1SSA 237 104 R0100
6	0.0136	20	55.10	1SSA 237 106 R0100
8	0.0210	30	70.40	1SSA 237 108 R0100
Other numbers of poles, consult us				
With flanges :				
4	0.0105	20	59.70	1SSA 237 104 R3100
6	0.0190	30	74.90	1SSA 237 106 R3100
8	0.0245	30	90.20	1SSA 237 108 R3100
Other numbers of poles, consult us				



Technical data

	IEC	UL	CSA
Wire size			
Rated voltage	380 V	300 V	300 V
Rated current	25 A	15 A	20 A
Short-circuit current			
Rated wire size / Gauge			
Storage temperature range	-20 ~ +80 °C		
Insulation resistance	≥ 10 ⁹ Ω		
Wire stripping length			
Recommended screwdriver			
Recommended torque			
Protection			

Accessories

Rep.	Description	Type	Order code	L. mm	Packaging	Weight kg
1	Housing	grey □	4 poles	1SSA 299 004 R0100	50.30 mm	
		grey □	6 poles	1SSA 299 004 R0200	65.50 mm	
		grey □	8 poles	1SSA 299 004 R0300	80.80 mm	

Other versions, please consult us :

Male plug. Wire Wrapping.

