

MAX solutions

Mill-Max Target Connectors for Spring Pins Hit the Mark

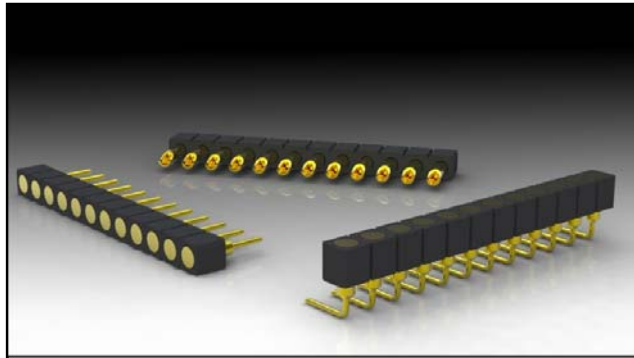

Mill-Max Target Connectors provide a convenient mating surface to connect with Mill-Max spring pins. They can be utilized in any spring pin application requiring conductive lands. Examples are: board stacking, elevated circuits or recharging applications.

Mill-Max precision-machined pins are plated with 10 micro inches hard gold and assembled in high temperature PCT thermoplastic.

The large .070" diameter target pin face is a convenient, easy-to-hit target for .042" diameter plungers, common to Mill-Max spring pins.

In non-standard applications, modifying a Mill-Max Target Connector is a much more cost-effective approach than modifying its complex, multi-part spring pin mate. For more information, visit www.mill-max.com/PR587.

We offer our spring-loaded connectors as six families of single and double row strip assemblies for .100" mounting grid – low and high profile surface mount styles are available on carrier tape and thru-hole style for manual placement. We also offer a choice of 46 discrete spring-loaded contacts for use in customer specific assemblies. Ask for datasheet PR561 for details on our spring-loaded parts.

For expert assistance with your specific application, please contact our engineers at techsupport@mill-max.com, or call 516-922-6000.

(4/10 -- 587)

Mill-Max Mfg. Corp. • 190 Pine Hollow Road, Oyster Bay, NY 11771-0300
516-922-6000 • Fax: 516-922-9253 • www.mill-max.com





SPRING-LOADED CONNECTORS
.100" Grid Target Connectors for Spring-Loaded Assemblies
Single Row

Series 319, 330, 399

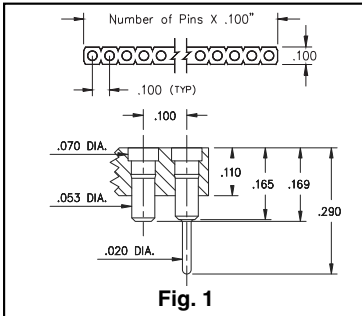

Fig. 1

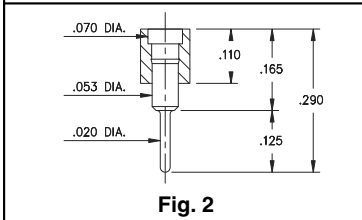

Fig. 2

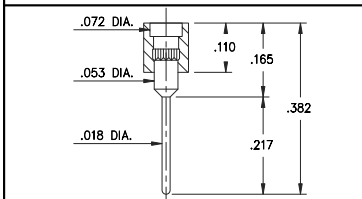

Fig. 3

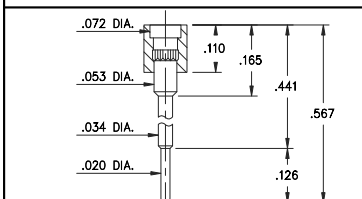

Fig. 4

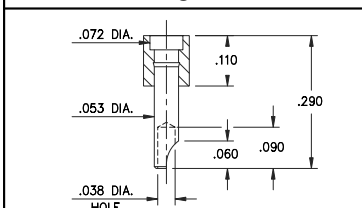

Fig. 5

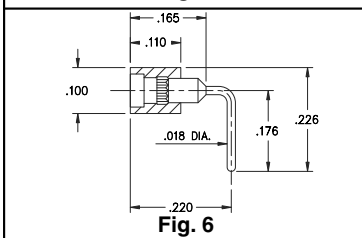
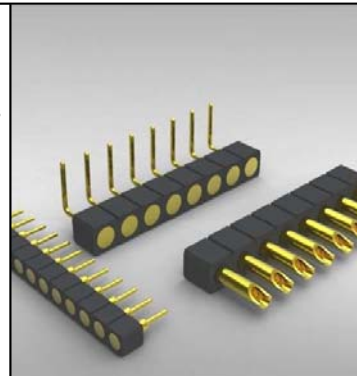

Fig. 6

- Series 319, 330 and 399 single row strips may be cut to any length.
- Spring Target connectors present a large flat surface for making tangent connections to our standard .042" dia spring pin plungers. The target connectors provide an excellent gold plated conductive path back to the board mounted spring pin connector.
- Target connectors use MM #1938, #1940, #1941, #1942 and #3024 pins. See page 185 for details.
- Insulators are high temp. thermoplastic.



Ordering Information

Fig. 1	Series 319...041 SMT w/ Alignment Pins
	319-10-1_ _-30-041000 Specify # of pins → 01-64
Fig. 2	Series 319...001 Standard Solder Tails
	319-10-1_ _-00-001000 Specify # of pins → 01-64
Fig. 3	Series 319...002 Long Solder Tails
	319-10-1_ _-00-002000 Specify # of pins → 01-64
Fig. 4	Series 319...005 Elevated Solder Tails
	319-10-1_ _-00-005000 Specify # of pins → 01-64
Fig. 5	Series 330...240 Solder Cups
	330-10-1_ _-10-240000 Specify # of pins → 01-64
Fig. 6	Series 399...008 Right Angle Solder Tails
	399-10-1_ _-10-008000 Specify # of pins → 01-64

*For Electrical,
 Mechanical & Environmental
 Data, See pg. 4*



PLATING CODE =	10			
Pin Plating	10 μ" Au			



SPRING-LOADED CONNECTORS
.100" Grid Target Connectors for Spring-Loaded Assemblies
Double Row

Series 419, 430, 499

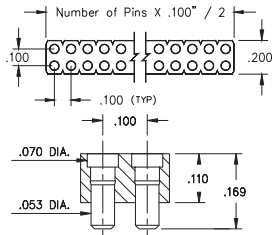

Coplanarity .005". For Pin Counts >20 positions consult Technical Support.

Fig. 1

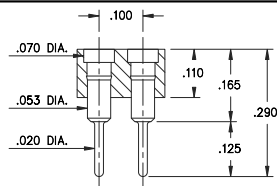

Fig. 2

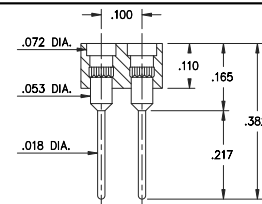

Fig. 3

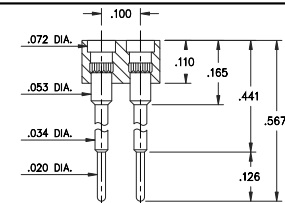

Fig. 4

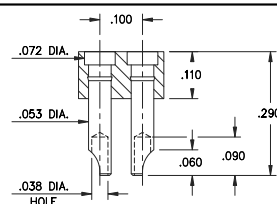

Fig. 5

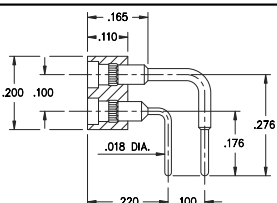
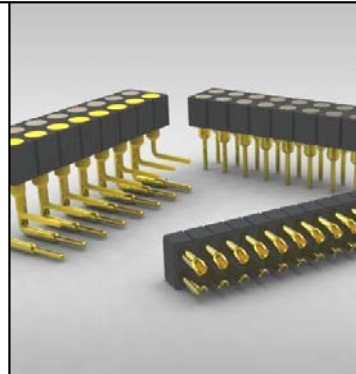

Fig. 6

- Series 419, 430 and 499 double row strips may be cut to any length.
- Spring Target connectors present a large flat surface for making tangent connections to our standard .042" dia spring pin plungers. The target connectors provide an excellent gold plated conductive path back to the board mounted spring pin connector.
- Target connectors use MM #1938, #1940, #1941, #1942 and #3024 pins. See page 185 for details.
- Insulators are high temp. thermoplastic.



Ordering Information

Fig. 1	Series 419...041 Surface Mount
	419-10-2_ _-30-041000 Specify # of pins → 04-64
Fig. 2	Series 419...001 Standard Solder Tails
	419-10-2_ _-00-001000 Specify # of pins → 04-64
Fig. 3	Series 419...002 Long Solder Tails
	419-10-2_ _-00-002000 Specify # of pins → 04-64
Fig. 4	Series 419...005 Elevated Solder Tails
	419-10-2_ _-00-005000 Specify # of pins → 04-64
Fig. 5	Series 430...240 Solder Cups
	430-10-2_ _-10-240000 Specify # of pins → 04-64
Fig. 6	Series 499...008 Right Angle Solder Tails
	499-10-2_ _-10-008000 Specify # of pins → 04-64

For Electrical,
 Mechanical & Environmental
 Data, See pg. 4



PLATING CODE =	10			
Pin Plating 	10 μ" Au			