

Customer Information Sheet

DRAWING No.: DOI-E01XXXX

SHEET 3 OF 4

IF IN DOUBT - ASK

©

NOT TO SCALE

THIRD ANGLE PROJECTION

ALL DIMENSIONS IN mm

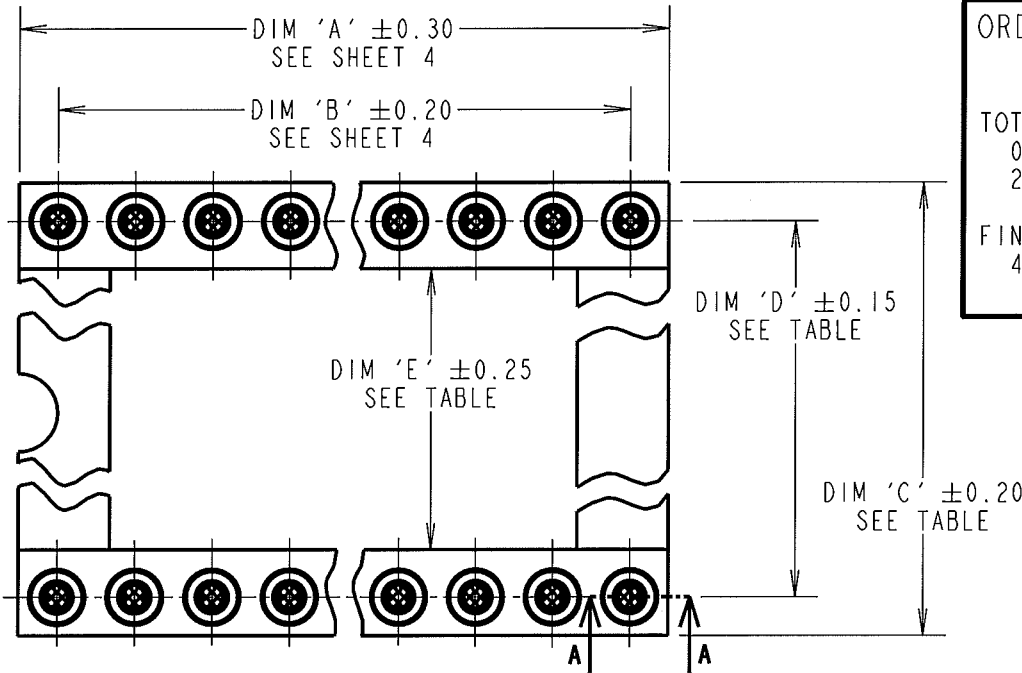

PART SECTION A-A

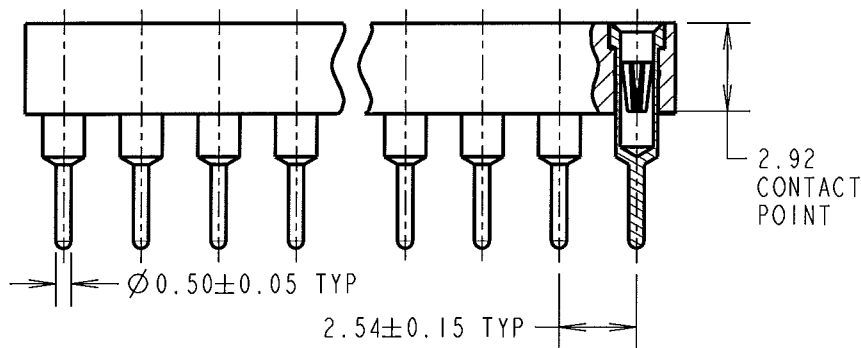

ORDER CODE:
DOI-E01XXXX
 TOTAL No. OF CONTACTS
 06, 08, 14, 16,
 20, 28, 32, 40
 FINISH
 42 = GOLD CLIP,
 100% TIN SHELL

NOTES:
 1. RECOMMENDED PCB HOLE
 SIZE = $\phi 0.80$ mm.

SPECIFICATIONS:
 MATERIAL:
 MOULDING = 30% GLASS-FILLED PPS, UL94V-0, BLACK
 CONTACT CLIP = BERYLLIUM COPPER
 CONTACT SHELL = BRASS
 FINISH:
 CONTACT CLIP = GOLD OVER NICKEL
 CONTACT SHELL = 100% TIN OVER NICKEL
 ELECTRICAL:
 CURRENT RATING = 3A
 CONTACT RESISTANCE:
 INITIAL = $20m\Omega$ MAX
 AFTER CONDITIONING = $30m\Omega$ MAX
 INSULATION RESISTANCE = $1,000M\Omega$ MIN
 DIELECTRIC STRENGTH = 1,000V AC / 1 MINUTE
 MECHANICAL:
 DURABILITY = 300 OPERATIONS
 INSERTION FORCE ($\phi 0.46$ mm GAUGE) = 5N MAX
 WITHDRAWAL FORCE ($\phi 0.46$ mm GAUGE) = 0.5N MIN
 ENVIRONMENTAL:
 TEMPERATURE RANGE = $-40^{\circ}C$ TO $+105^{\circ}C$
 PACKING:
 TUBE

TOTAL No. OF CONTACTS	DIM 'C'	DIM 'D'	DIM 'E'
6, 8, 14, 16, 20	10.20	7.62	4.40
28, 32, 40	17.80	15.24	12.10

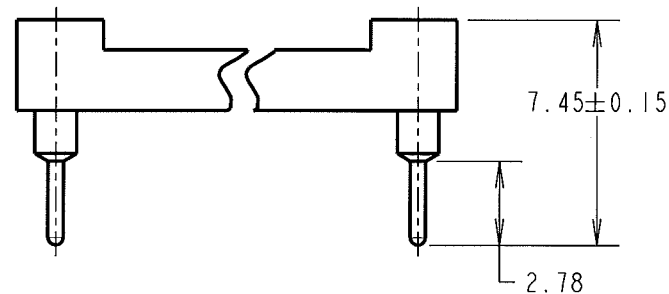

Asia only

SF	2	11.07.08	10093
NAME	ISS.	DATE	C/NOTE
APPROVED:	<i>[Signature]</i>		
CHECKED:	<i>[Signature]</i>		
DRAWN:	W. J. BOURNE		
CUSTOMER REF.:			
ASSEMBLY DRG:			

HARWIN

HARWIN USA
 TEL: 603 893 5376
 FAX: 603 893 5396
 mis@harwin.com

HARWIN Europe (UK)
 TEL: 023 9231 4545
 FAX: 023 9231 4590
 mis@harwin.co.uk

HARWIN Asia
 TEL: +65 6 779 4909
 FAX: +65 6 779 3868
 mis@harwin.com.sg

THIS DRAWING AND ANY
 INFORMATION OR DESCRIPTIVE
 MATTER SET OUT HEREON ARE
 CONFIDENTIAL AND COPYRIGHT
 PROPERTY OF THE HARWIN
 GROUP AND MUST NOT BE
 DISCLOSED, LOANED, COPIED
 OR USED FOR MANUFACTURING,
 TENDERING OR FOR ANY
 OTHER PURPOSE WITHOUT
 THEIR WRITTEN PERMISSION.

TOLERANCES
 X. = ± 1 mm
 X.X = ± 0.25 mm
 X.XX = ± 0.10 mm
 X.XXX = ± 0.01 mm
 ANGLES = $\pm 5^{\circ}$
 UNLESS STATED

MATERIAL:
 SEE ABOVE
 FINISH: SEE ABOVE
 S/AREA: mm²

TITLE:
 2.54mm PITCH DUAL ROW PC TAIL
 I.C. SOCKET ASSEMBLY
 DRAWING NUMBER:
DOI-E01XXXX
 SHT
 3
 OF
 4

Customer Information Sheet

DRAWING No.: D01-E01XXXX

SHEET 4 OF 4

IF IN DOUBT - ASK

©

NOT TO SCALE

THIRD ANGLE PROJECTION

ALL DIMENSIONS IN mm

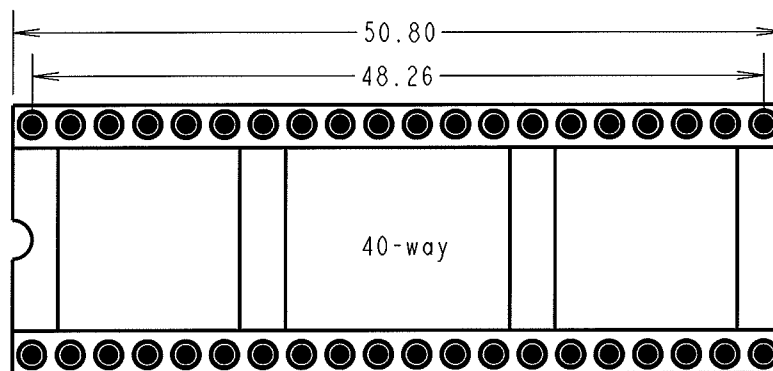
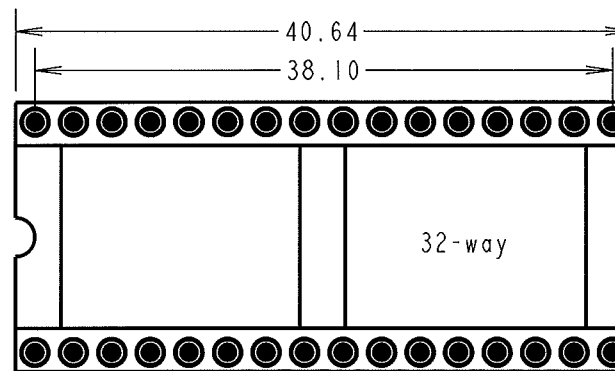
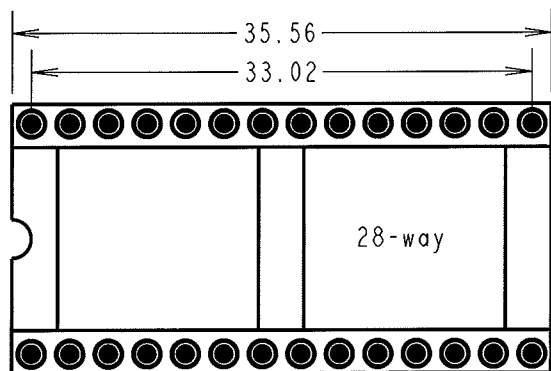
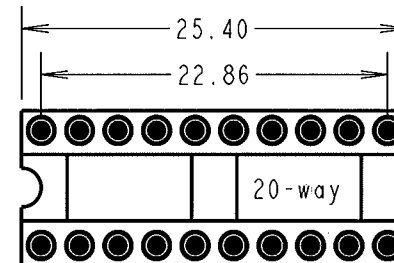
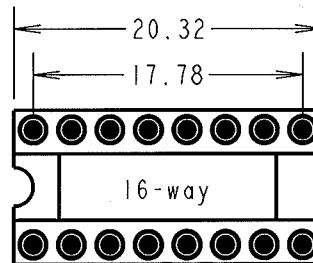
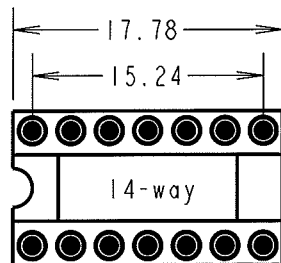
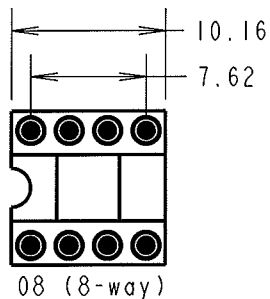
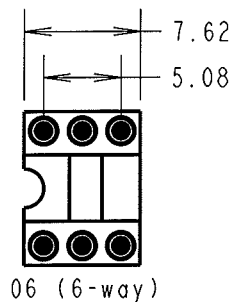

NOTES:
1. SEE SHEET 3 FOR TOLERANCES RELATING TO THESE DIMENSIONS.

SF	2	11.07.08	10093
NAME	ISS.	DATE	C/NOTE
APPROVED: <i>[Signature]</i>			
CHECKED: <i>[Signature]</i>			
DRAWN: W. J. BOURNE			
CUSTOMER REF.:			
ASSEMBLY DRG:			

HARWIN

HARWIN USA
TEL: 603 893 5376
FAX: 603 893 5396
mis@harwin.com

HARWIN Europe (UK)
TEL: 023 9231 4545
FAX: 023 9231 4590
mis@harwin.co.uk

HARWIN Asia
TEL: +65 6 779 4909
FAX: +65 6 779 3868
mis@harwin.com.sg

THIS DRAWING AND ANY INFORMATION OR DESCRIPTIVE MATTER SET OUT HEREON ARE CONFIDENTIAL AND COPYRIGHT PROPERTY OF THE HARWIN GROUP AND MUST NOT BE DISCLOSED, LOANED, COPIED OR USED FOR MANUFACTURING, TENDERING OR FOR ANY OTHER PURPOSE WITHOUT THEIR WRITTEN PERMISSION.

TOLERANCES
X = ±1mm
X.X = ±0.25mm
X.XX = ±0.10mm
X.XXX = ±0.01mm
ANGLES = ±5°
UNLESS STATED

MATERIAL:

SEE ABOVE

FINISH: SEE ABOVE

S/AREA:

mm²

TITLE:

2.54mm PITCH DUAL ROW PC TAIL I.C. SOCKET ASSEMBLY

DRAWING NUMBER:

D01-E01XXXX

SHT
4 OF 4

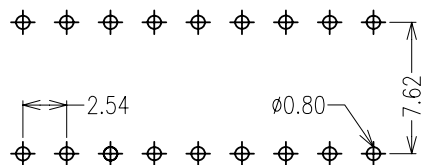
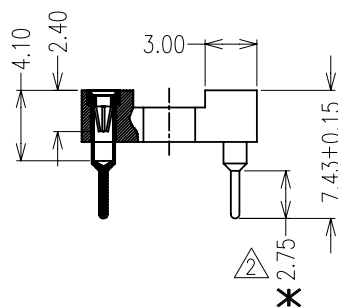
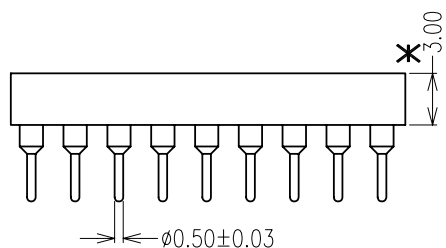
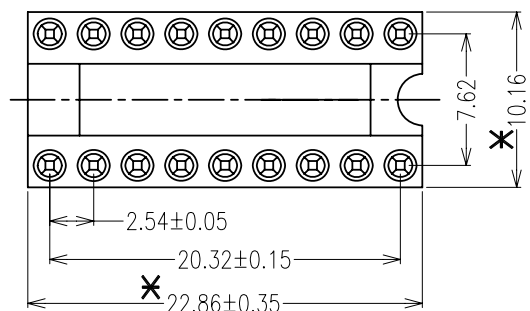

PCB LAYOUT

SPECIFICATIONS:

MATERIAL:-

MOULDING: PPS+30%GF UL94V-0

CONTACT CLIP: BeCu (C17200)

SLEEVE: BRASS CuZn36Pb3 (C36000)

FINISH:-

SELECTIVE GOLD

ELECTRICAL:-

CURRENT RATING: 1A

DIELECTRIC STRENGTH: 1000V RMS MIN.

CONTACT RESISTANCE: 10 mΩ MAX.

MECHANICAL:-

DURABILITY: 100 CYCLES MIN.

MATING PIN: Ø0.40 TO Ø0.56

ENVIRONMENTAL:-

TEMPERATURE RANGE: -40°C TO +105°C

NOTES: ALL DIMENSIONS AND NOTES
MARKED * ARE CRITICAL AND
MUST BE CHECKED IN ACCORDANCE
WITH QUALITY DOC. QI-02A

Allan Allan	2 1	29.03.10 01.02.10	A273 -
NAME	ISS.	DATE	C/NOTE
APPROVED: <i>Paul</i>			
CHECKED: <i>Paul</i>			
DRAWN:			
CUSTOMER REF.:			
ASSEMBLY DRG:			

HARWIN

HARWIN USA
TEL: 603 893 5376
FAX: 603 893 5396
mis@harwin.com

HARWIN Europe (UK)
TEL: 023 9231 4545
FAX: 023 9231 4590
mis@harwin.co.uk

HARWIN Asia
TEL: +65 6 779 4909
FAX: +65 6 779 3868
mis@harwin.com.sg

THIS DRAWING AND ANY
INFORMATION OR DESCRIPTIVE
MATTER SET OUT HEREON ARE
CONFIDENTIAL AND COPYRIGHT
PROPERTY OF THE HARWIN
GROUP AND MUST NOT BE
DISCLOSED, LOANED, COPIED
OR USED FOR MANUFACTURING,
TENDERING OR FOR ANY
OTHER PURPOSE WITHOUT
THEIR WRITTEN PERMISSION.

TOLERANCES
X. = ±1mm
X.X = ±0.40mm
X.XX = ±0.25mm
X.XXX = ±0.15mm
ANGLES = ±5°
UNLESS STATED

MATERIAL:
SEE NOTES
FINISH: SEE NOTES
S/AREA: mm²

TITLE:
2.54MM IC SOCKET 180°
DRAWING NUMBER:
D01-E011842

SHT
1
OF
1