

PLEASE CHECK WWW.MOLEX.COM FOR LATEST PART INFORMATION

Part Number: [0476452000](#)
Status: **Active**
Overview: slimline serial ata odd connectors
Description: 1.00mm(.039"), 1.27mm (.050") Pitch Slimline Serial ATA Header for Optical Disk Drive, Vertical, DIP Type, Gold (Au) Flash Plating, with Beveled Metal Pins, Lead-free

Documents:

[Drawing \(PDF\)](#) [RoHS Certificate of Compliance \(PDF\)](#)
[Product Specification PS-47628-001 \(PDF\)](#)

Agency Certification

CSA LR 19980
 UL E29179

General

Product Family PCB Headers
 Series [47645](#)
 Application Board-to-Board
 Comments Through Hole Type
 Overview [slimline serial ata odd connectors](#)
 Product Name Serial ATA, Slimline Serial ATA

Physical

Breakaway No
 Circuits (Loaded) 13
 Circuits (maximum) 13
 Durability (mating cycles max) 500
 First Mate / Last Break Yes
 Flammability 94V-0
 Glow-Wire Compliant No
 Guide to Mating Part Yes
 Keying to Mating Part Yes
 Lock to Mating Part No
 Material - Metal Copper Alloy
 Material - Plating Mating Gold
 Material - Plating Termination Tin
 Material - Resin High Temperature Thermoplastic
 Number of Rows 1
 Orientation Vertical
 PCB Locator No
 PCB Retention Yes
 PCB Thickness Recommended (in) 0.050 In
 PCB Thickness Recommended (mm) 1.20 mm
 Packaging Type Embossed Tape on Reel
 Pitch - Mating Interface (in) 0.039 In, 0.050 In
 Pitch - Mating Interface (mm) 1.00 mm, 1.27 mm
 Pitch - Term. Interface (in) 0.039 In, 0.050 In
 Pitch - Term. Interface (mm) 1.00 mm, 1.27 mm
 Plating min: Mating (µin) 2
 Plating min: Mating (µm) 0.05
 Plating min: Termination (µin) 39
 Plating min: Termination (µm) 1
 Polarized to Mating Part Yes
 Polarized to PCB Yes
 Stackable No
 Temperature Range - Operating -35°C to +85°C

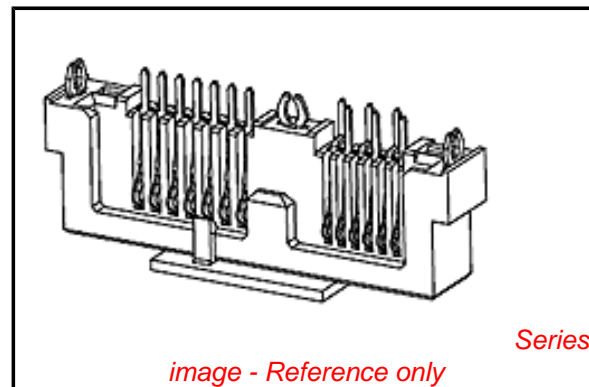

image - Reference only

EU RoHS

ELV and RoHS Compliant
REACH SVHC
 Not Reviewed
Halogen-Free Status

China RoHS



Not Halogen-Free

Need more information on product environmental compliance?

Email productcompliance@molex.com
 For a multiple part number RoHS Certificate of Compliance, [click here](#)

Please visit the [Contact Us](#) section for any non-product compliance questions.

Search Parts in this Series
[47645Series](#)

Termination Interface: Style

Through Hole

Electrical

Current - Maximum per Contact

1.5A

Voltage - Maximum

15V DC

Material Info

Reference - Drawing Numbers

Packaging Specification

PK-47645-012

Product Specification

PS-47628-001

Sales Drawing

SD-47645-200

This document was generated on 05/26/2010

PLEASE CHECK WWW.MOLEX.COM FOR LATEST PART INFORMATION

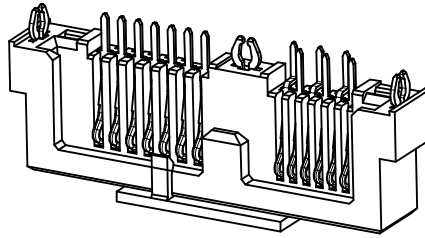
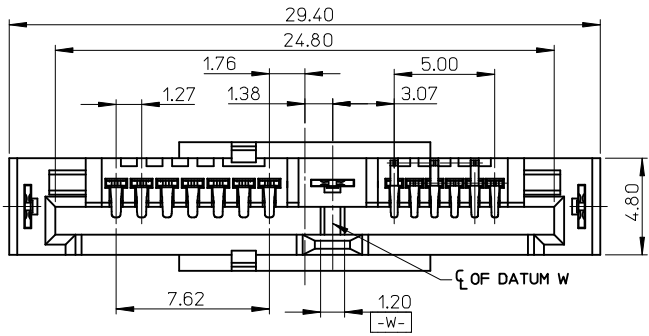

NOTES :

1.MATERIAL :

HOUSING : HIGH TEMPERATURE THERMOPLASTIC, UL94V-0, BLACK
 TERMINAL : COPPER ALLOY
 FORKLOCK : COPPER ALLOY

2.PLATING :

TERMINAL :
 CONTACT AREA : GOLD PLATING SPEC REFER TO CHART.
 SOLDER AREA : MATTE TIN PLATING 1 MICRONS MIN.
 UNDERPLATING : NICKEL PLATING 1.25 MICRONS MIN.
 FORKLOCK :
 MATTE TIN PLATING 1 MICROMETER MIN. OVER NICKEL PLATING 1 MICROMETER MIN.

3.PACKAGE SPEC: PK-47645-012.

4.PRODUCT SPEC: PS-47628-001.

5.THE PRODUCT COMPLIANT TO RoHS DIRECTIVES 2002/95/EC AND ELV 2000/53/EC.

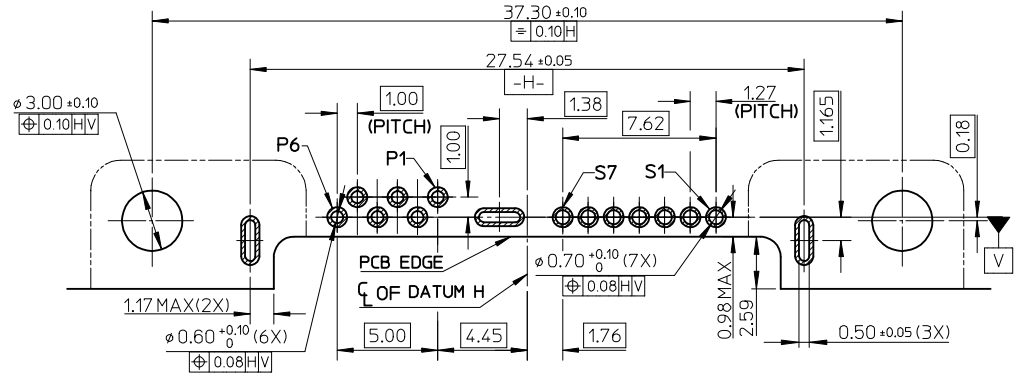
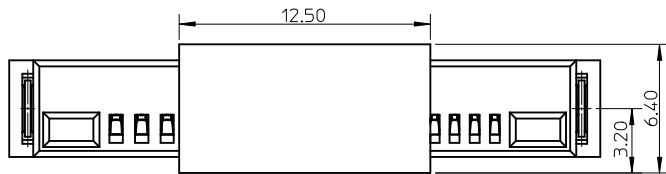
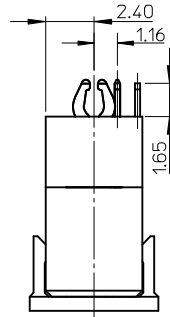
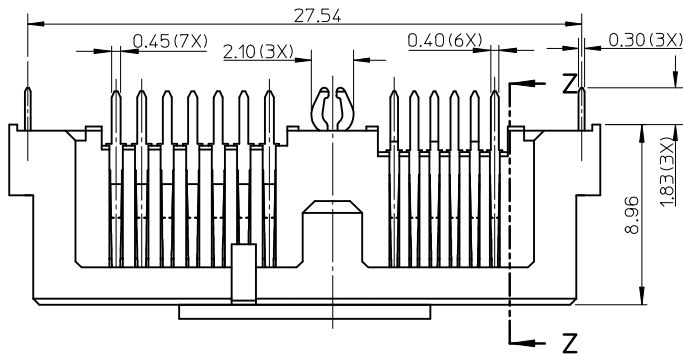

RECOMMENDED PCB LAYOUT (COMPONENT SIDE)

PCB THICKNESS = 1.2MM ± 0.05MM

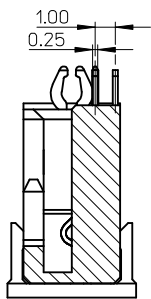

SECTION Z-Z

P/N	CONTACT GOLD PLATING SPEC
47645-2000	Au FLASH
47645-2100	0.38 MICRONS MIN
47645-2200	0.76 MICRONS MIN

REVISED	EC NO: SH2010-0070	QUALITY SYMBOLS	GENERAL TOLERANCES (UNLESS SPECIFIED)
	DRWNG:LLI		mm INCH
	CHKD:XJ.SONG		4 PLACES ± --- ± ---
	APPR:RZHANG		3 PLACES ± --- ± ---
REV			2 PLACES ± 0.15 ± ---
			1 PLACE ± 0.25 ± ---
			ANGULAR ± 3 °
			DRAFT WHERE APPLICABLE MUST REMAIN WITHIN DIMENSIONS

GENERAL TOLERANCES (UNLESS SPECIFIED)	DIMENSION STYLE	SCALE	DESIGN UNITS	THIRD ANGLE PROJECTION
mm INCH	MM ONLY	4:1	METRIC	
4 PLACES ± --- ± ---	DRAWN BY			
3 PLACES ± --- ± ---	DATE			
2 PLACES ± 0.15 ± ---	DIXON LI			
1 PLACE ± 0.25 ± ---	DATE			
ANGULAR ± 3 °	2008/01/15			
DRAFT WHERE APPLICABLE MUST REMAIN WITHIN DIMENSIONS	CHECKED BY			
	JOHNSON TIAN			
	DATE			
	2008/01/15			
	APPROVED BY			
	HARVEY WANG			
	DATE			
	2008/01/15			
	MATERIAL NO.			
	SEE CHART			

TITLE	HEADER OF 2 PIECES SLIMLINE SATA VERTICAL, DIP TYPE
MATERIAL NO.	SD-47645-200
DOCUMENT NO.	
SHEET NO.	1 OF 1

MOLEX	MOLEX INCORPORATED
THIS DRAWING CONTAINS INFORMATION THAT IS PROPRIETARY TO MOLEX INCORPORATED AND SHOULD NOT BE USED WITHOUT WRITTEN PERMISSION	