

MATERIAL AND FINISH:

Insulator: Nylon 66, black, UL-94V-2 rated

Contacts: Copper Alloy, Tin plated

MECHANICAL SPECIFICATIONS:

Insertion force: 5KG max.

Withdrawal force: 1.5KG min.

Life test: 5,000 cycles min. of insertion and withdrawal.

ELECTRICAL SPECIFICATIONS:

Rated current: 15A

Rated voltage: 125VAC



Insulation resistance: 1000 Mohm min. @ 500VDC

Dielectric withstanding voltage:

1500VAC for one minute

ENVIRONMENTAL:

Operating temperature: -45°C ~ +80°C

RoHS COMPLIANT

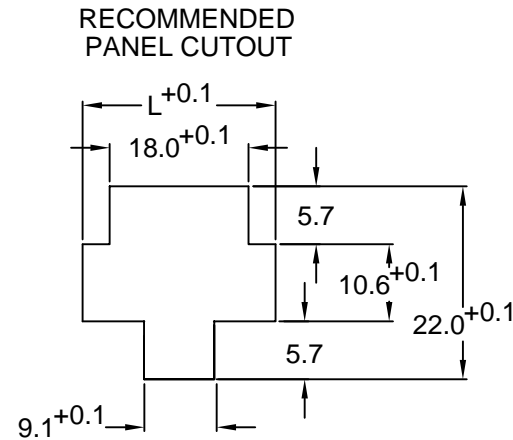
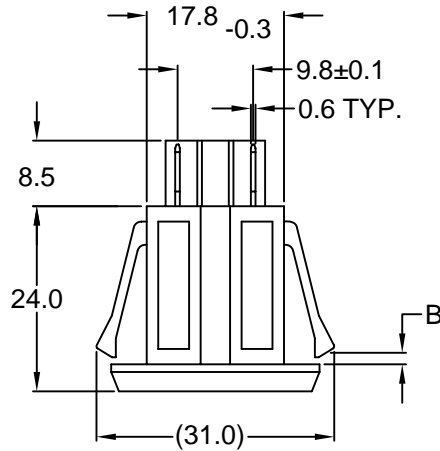

PANEL THICKNESS PD-15-1	L
0.8	24.0
1.0	24.0
1.2	24.5
1.6	24.5
2.0	25
2.5	25
PANEL THICKNESS PD-15-12	L
2.5	25.0
3.0	25.5
3.5	28.5

P/N	B
PD-15-1	1.5
PD-15-12	3.0

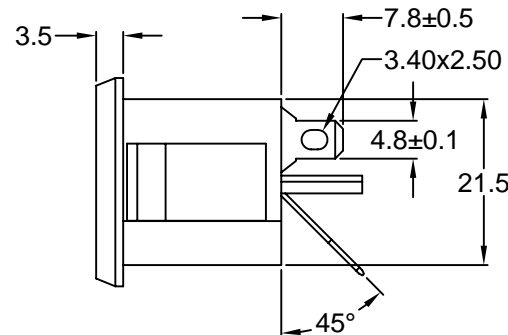
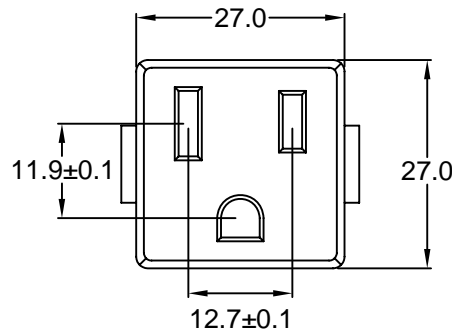

REV	DATE	CHANGE	CHNG		CHK		APPR	
			PB	SS	QD	TD	PB	SS
A	12/22/99	REVISED DRAWING	PB	SS	QD	TD	PB	PB
B	10/31/01	REVISED / UPDATED	PB	SS	QD	TD	PB	PB
C	1/17/03	ADD OTYING TEMP.	PB	SS	QD	TD	PB	PB
D	8/27/03	CHNG. PANEL THICKNESS CUTOUT	PB	SS	QD	TD	PB	PB
E	5/14/08	ADD PANEL CUTOUT DIM. 5.7	PB	SS	QD	TD	PB	PB

TOLERANCE UNLESS OTHERWISE SPECIFIED	
X	± 1
X.X	± 0.4
X.XX	± 0.20

DRAWN BY: SLS	DATE: 8/12/98
CHECK BY: JD	DATE: 8/12/98
APPR BY: SLS	DATE: 2/18/99

Power Dynamics, Inc.
 Phone: 973 560-0019 Whippany, New Jersey Fax: 973 560-0076

PART: NORTH AMERICAN NEMA 5-15R; SINGLE SOCKET, QC CONNECT TERMINAL

PD-15-1X

ALL DIMENSIONS FOR REFERENCE ONLY
 DIMENSIONS ARE IN MILLIMETERS

SHEET 1 of 1
 REV: E