

MATERIALS AND FINISHES:

BODY STAINLESS STEEL
PASSIVATED

CENTER CONTACT BERYLLIUM COPPER
PLATED GOLD

INSULATOR TEFLON

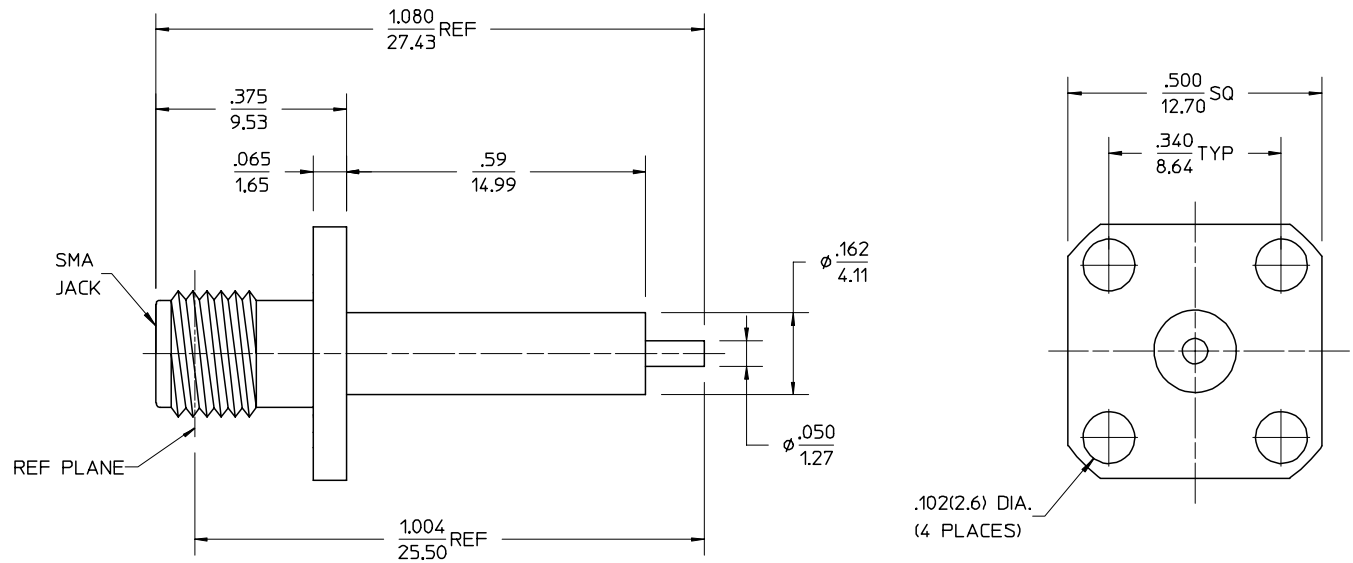

PART # 73251-0410

MIL-STD-348, FIGURE 310-2	INTERFACE
PS-89675-2820	ELECTRO/MECH PERFORMANCE
SPECIFICATION	DESCRIPTION

CHG: 58 WAS .590	EC NO. URF-1710 DRWN: JDW 04/11/03 CHK: SSS 04/11/03 APPR: GMH 04/11/03 CHG: NEW RELEASE	EC NO. URF-1699 DRWN: TEF 04/01/03 CHK: SSS 04/01/03 APPR: JW 04/01/03	REV 1 WAS A SINCE EC NO 0013 WAS CANCELLED REMOVED MIL SPECS FROM MATERIAL AND FINISHES TEF 03/19/02	EC NO. RF-0013 DRWN: EDC 12/10/97 CHK: DHG 01/09/98 APPR: GMH 01/09/98	DESCRIPTION
A1	A	2	1	REV	

UNLESS OTHERWISE SPECIFIED DIMS ARE INCHES AND ANGLES ARE DEGREES.

1. √ 63 ALL OVER.
2. NO CHATTER OR NON-UNIFORM SURFACE FINISH ALLOWED.
3. PARTS TO BE FREE OF BURRS & SHARP EDGES .005 MAX BREAK.
4. EXTERNAL THREADS TO BE ROLLED OR SINGLE POINT.
5. DIAMETERS TO BE CONCENTRIC WITHIN .003 TIR.

QUALITY SYMBOLS
MAJOR
CRITICAL

GENERAL TOLERANCES: (UNLESS SPECIFIED)	SCALE	DESIGN UNITS
4 PLACES * ± .0005	INCH	<input checked="" type="checkbox"/> INCH
3 PLACES * ± .005	mm	<input type="checkbox"/> mm
2 PLACES * ± .01		
1 PLACE * ± .1		
ANGULAR: ± 1/2°		

DRAWN BY & DATE	EDC 12/10/97
CHECKED BY & DATE	DHG 01/09/98
APPROVED BY & DATE	GMH 01/09/98
CAD FILENAME	

TITLE:	SMA JACK, RECEPTACLE, 4 HOLE FLANGE MOUNT, EXTENDED DIELECTRIC POST SMA-SDJR/F
MATERIAL NO.	SEE NOTE
DRAWING NO.	SD-73251-041
SHEET NO.	1 of 1