

Customer Information Sheet

DRAWING No.: F05-400XX45R

SHEET 3 OF 4

IF IN DOUBT - ASK

©

NOT TO SCALE

THIRD ANGLE PROJECTION

ALL DIMENSIONS IN mm

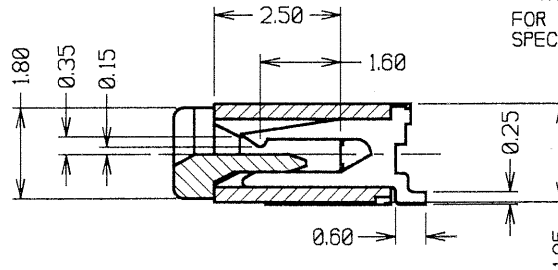
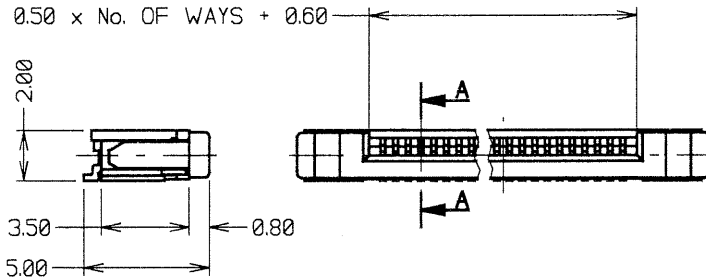
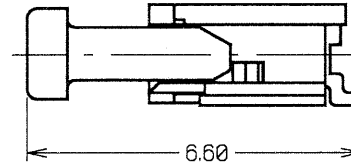
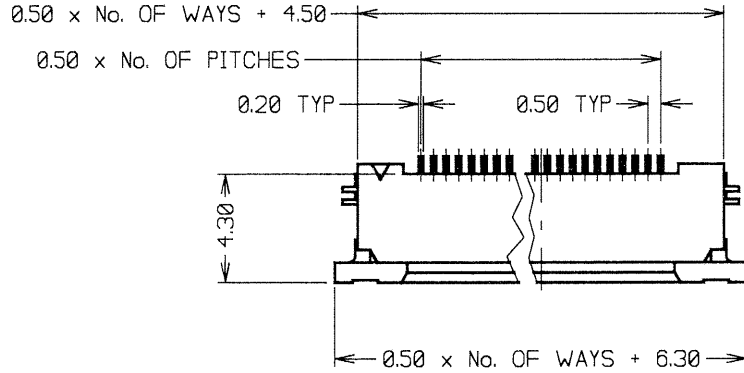

SECTION A-A

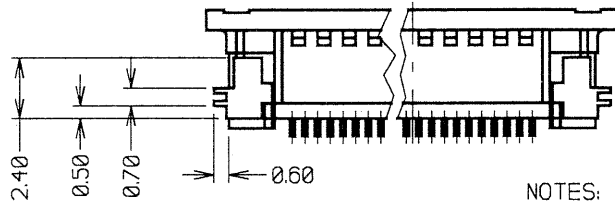

- NOTES:
1. ALL TOLERANCES TO BE ± 0.30 UNLESS OTHERWISE STATED.
 2. FOR REELING DETAILS SEE SHEET 4.

SPECIFICATIONS:

MATERIAL:

MOULDINGS = 40% GLASS-FILLED PPS (UL94V-0)
 CONTACTS = HIGH PERFORMANCE COPPER ALLOY
 RETAINER = PHOSPHOR BRONZE

FINISH:

CONTACTS = 0.05-0.1 μ GOLD OVER 1.27 μ NICKEL
 RETAINER = 2.0-6.0 μ 100% TIN OVER 1.27 μ NICKEL

ELECTRICAL:

CURRENT RATING = 0.4A AC/DC
 VOLTAGE RATING = 50V AC/DC
 CONTACT RESISTANCE = 40 MILLIOHMS MAX
 DIELECTRIC WITHSTANDING = 500V AC
 INSULATION RESISTANCE = 500 MEGOHMS MIN

MECHANICAL:

RETENTION OF FPC = 0.25N x No. OF WAYS MIN
 CONTACT RETENTION FORCE = 1.5N MIN
 HOLD DOWN RETENTION FORCE = 3N MIN
 DURABILITY = 30 CYCLES

ENVIRONMENTAL:

TEMPERATURE RANGE = -25°C TO +85°C

PACKING:

TAPE & REEL

FOR COMPLETE SPECIFICATION, SEE COMPONENT SPECIFICATION C030XX (LATEST ISSUE).

| | | | |
|------------------------------|------|----------|--------|
| JMB | 6 | 19.06.06 | 9273 |
| NAME | ISS. | DATE | C/NOTE |
| APPROVED: <i>[Signature]</i> | | | |
| CHECKED: <i>[Signature]</i> | | | |
| DRAWN: W. J. BOURNE | | | |
| CUSTOMER REF.: | | | |
| ASSEMBLY DRG: | | | |

ORDER CODE:
F05-400XX45R

No. OF WAYS:
 06, 08, 10, 12, 14, 16,
 18, 20, 24, 26 & 30

HARWIN

HARWIN USA
 TEL: 603 893 5376
 FAX: 603 893 5396
 mis@harwin.com

HARWIN Europe (UK)
 TEL: 023 9231 4545
 FAX: 023 9231 4590
 mis@harwin.co.uk

HARWIN Asia
 TEL: +65 6 779 4909
 FAX: +65 6 779 3868
 mis@harwin.com.sg

THIS DRAWING AND ANY INFORMATION OR DESCRIPTIVE MATTER SET OUT HEREON ARE CONFIDENTIAL AND COPYRIGHT PROPERTY OF THE HARWIN GROUP AND MUST NOT BE DISCLOSED, LOANED, COPIED, OR USED FOR MANUFACTURING, TENDERING OR FOR ANY OTHER PURPOSE WITHOUT THEIR WRITTEN PERMISSION.

TOLERANCES
 X. = ± 1.0 mm
 X.X = ± 0.25 mm
 X.XX = ± 0.10 mm
 X.XXX = ± 0.01 mm
 ANGLES = $\pm 5^\circ$
 UNLESS STATED

MATERIAL:
 SEE ABOVE
FINISH: SEE ABOVE
S/AREA: mm²

TITLE:
 0.5mm PITCH FPC CONNECTOR
 TOP CONTACT (TAPE & REEL)
DRAWING NUMBER:
F05-400XX45R

SHT
 3
 OF
 4

Customer Information Sheet

DRAWING No: F05-400XX45R

SHEET 4 OF 4

IF IN DOUBT - ASK

©

NOT TO SCALE

THIRD ANGLE PROJECTION

ALL DIMENSIONS IN mm

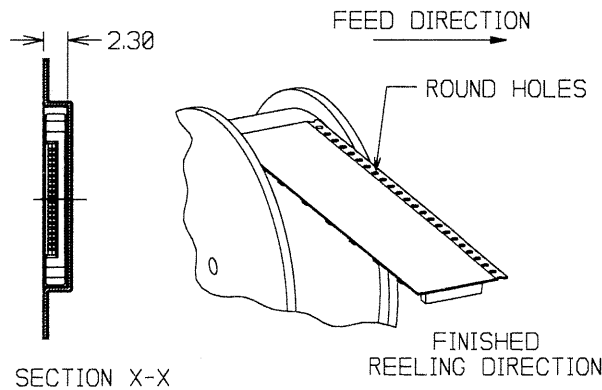
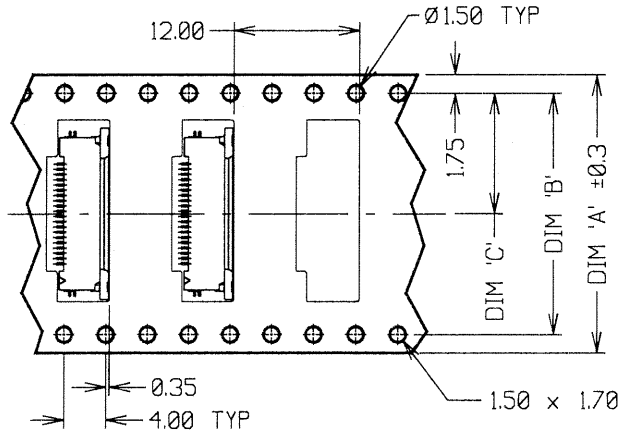

| PART No: | DIM 'A' | DIM 'B' | DIM 'C' |
|--------------|---------|---------|---------|
| F05-4000645R | 16.0 | | 7.5 |
| F05-4000845R | 16.0 | | 7.5 |
| F05-4001045R | 24.0 | | 11.5 |
| F05-4001245R | 24.0 | | 11.5 |
| F05-4001445R | 24.0 | | 11.5 |
| F05-4001645R | 24.0 | | 11.5 |
| F05-4001845R | 24.0 | | 11.5 |
| F05-4002045R | 24.0 | | 11.5 |
| F05-4002445R | 24.0 | | 11.5 |
| F05-4002645R | 32.0 | 28.4 | 14.2 |
| F05-4003045R | 32.0 | 28.4 | 14.2 |

ORDER CODE:
F05-400XX45R

No. OF WAYS
06, 08, 10, 12, 14, 16,
18, 20, 24, 26 & 30

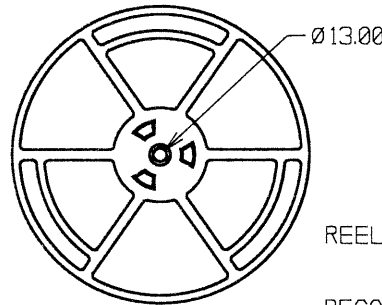
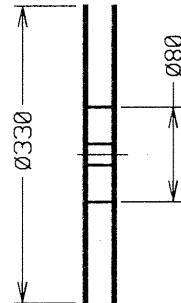

- NOTES:
1. FOR CONNECTOR DIMENSIONS SEE SHEET 3.
 2. QUANTITY OF COMPONENTS PER REEL = 2000.
 3. TAPE & REELING TO BE IN ACCORDANCE WITH ELECTRONIC INDUSTRIES ASSOCIATION EIA-481.

RECOMMENDED F.P.C. LAYOUT
REINFORCED BOARD

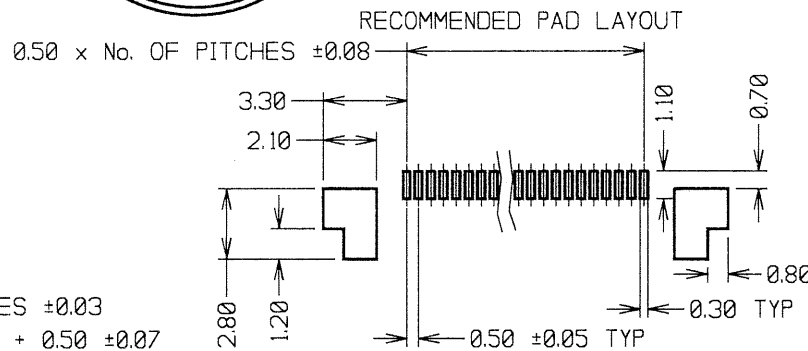
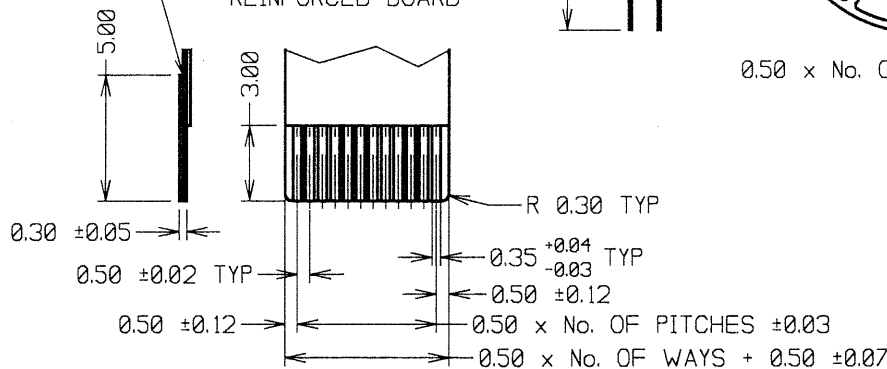

| | | | |
|----------------|------|--------------|--------|
| JMB | 6 | 19.06.06 | 9273 |
| NAME | ISS. | DATE | C/NOTE |
| APPROVED: | | | |
| CHECKED: | | | |
| DRAWN: | | W. J. BOURNE | |
| CUSTOMER REF.: | | | |
| ASSEMBLY DRG.: | | | |

HARWIN

| | | |
|--|--|--|
| HARWIN USA TEL: 603 893 5376 FAX: 603 893 5396 mis@harwin.com | HARWIN Europe (UK) TEL: 023 9231 4545 FAX: 023 9231 4590 mis@harwin.co.uk | HARWIN Asia TEL: +65 6 779 4909 FAX: +65 6 779 3868 mis@harwin.com.sg |
|--|--|--|

THIS DRAWING AND ANY INFORMATION OR DESCRIPTIVE MATTER SET OUT HEREON ARE CONFIDENTIAL AND COPYRIGHT PROPERTY OF THE HARWIN GROUP AND MUST NOT BE DISCLOSED, LOANED, COPIED OR USED FOR MANUFACTURING, TENDERING OR FOR ANY OTHER PURPOSE WITHOUT THEIR WRITTEN PERMISSION.

TOLERANCES
X. = ±1mm
X.X = ±0.25mm
X.XX = ±0.10mm
X.XXX = ±0.01mm
ANGLES = ±5°
UNLESS STATED

MATERIAL:
SEE SHEET 3
FINISH: SEE SHEET 3
S/AREA: mm²

TITLE:
0.5mm PITCH FPC CONNECTOR
TOP CONTACT (TAPE & REEL)
DRAWING NUMBER:
F05-400XX45R

SHT
4
OF
4