



TAI-SAW TECHNOLOGY CO., LTD.

No. 3, Industrial 2nd Rd., Ping-Chen Industrial District,
Taoyuan, 324, Taiwan, R.O.C.

TEL: 886-3-4690038 FAX: 886-3-4697532

E-mail: tstsales@mail.taisaw.com Web: www.taisaw.com

Approval Sheet For Product Specification

Issued Date:

Product Name: SAW Filter 862.5 MHz SMD 5X5 mm

TST Parts No.: TA0694A

Customer Parts No.: _____

Company: _____
Division: _____
Approved by : _____
Date: _____

Checked by: _____ Asin Lin

Approval by: _____ Francis Chen

Date: _____ 2007/9/05



TAI-SAW TECHNOLOGY CO., LTD.

No. 3, Industrial 2nd Rd., Ping-Chen Industrial District,
Taoyuan, 324, Taiwan, R.O.C.

TEL: 886-3-4690038 FAX: 886-3-4697532

E-mail: tstsales@mail.taisaw.com Web: www.taisaw.com

SAW Filter 862.5 MHz

MODEL NO.: TA0694A

REV. NO.: 2

A. MAXIMUM RATING:

1. Input Power Level: 10 dB_m
2. DC voltage: 0 V
3. Operating Temperature: -45°C to +90°C
4. Storage Temperature: -45°C to +90°C

RoHS Compliant
Lead free
Lead-free soldering

B. ELECTRICAL CHARACTERISTICS:

Item	Min.	Typ.	Max.	Note
Center frequency F_c (MHz)	-	862.5	-	1
Minimum I.L. (862.25~862.75 MHz) (dB) IL_{min}	-	3.2	4.5	
Pass band (relative to IL_{min}) 862~863 MHz (dB)	-	1.5	3.0	1
Pass bandwidth (relative to IL_{min}) BW_3 (KHz)	1000	1700	-	
Attenuation:(relative to IL_{min}) (dB)				
10~700 MHz (dB)	50	55	-	1
700~830 MHz (dB)	40	45	-	
830~850 MHz (dB)	25	37	-	
856.5~859.5 MHz (dB)	20	28	-	
865.5~868.5 MHz (dB)	15	20	-	
869~894 MHz (dB)	22	25	-	
894~960 MHz (dB)	35	40	-	
Impedance at F_c ; Input $Z_{IN}=R_{IN}/C_{IN}$ Output $Z_{OUT}=R_{OUT}/C_{OUT}$	113Ω // 3.7 pF 113Ω // 3.7 pF			

C. MEASUREMENT CIRCUIT:

HP Network analyzer

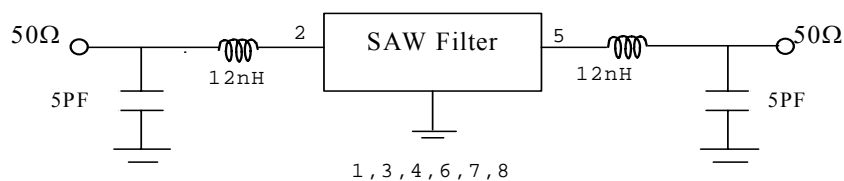

D. Frequency Characteristics :

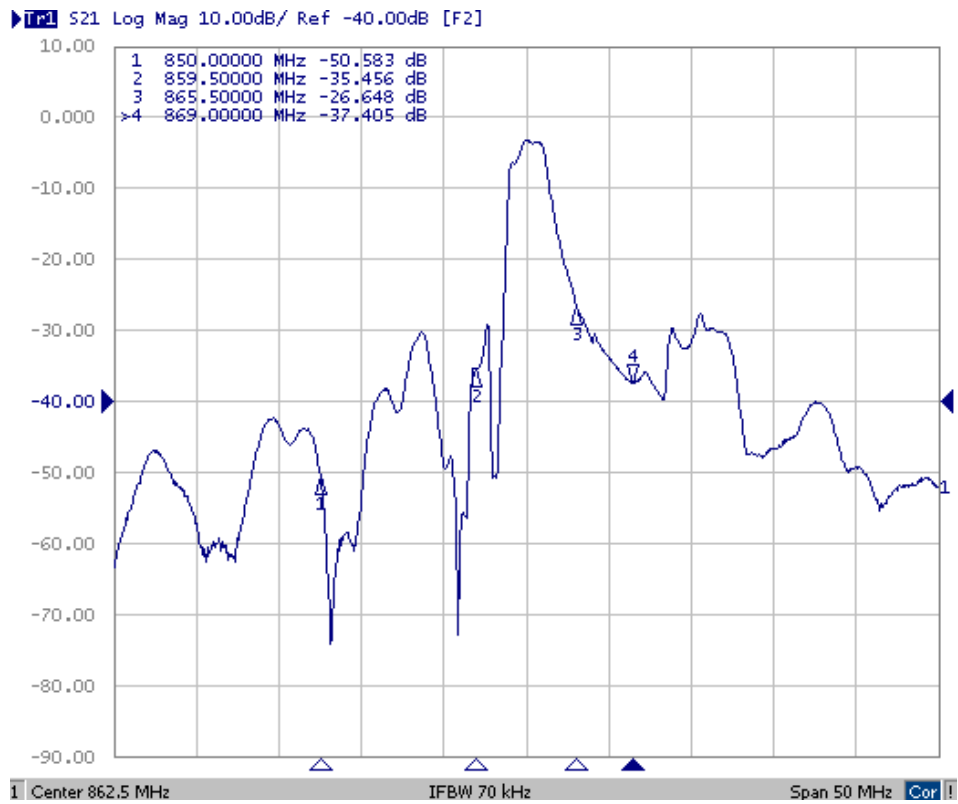
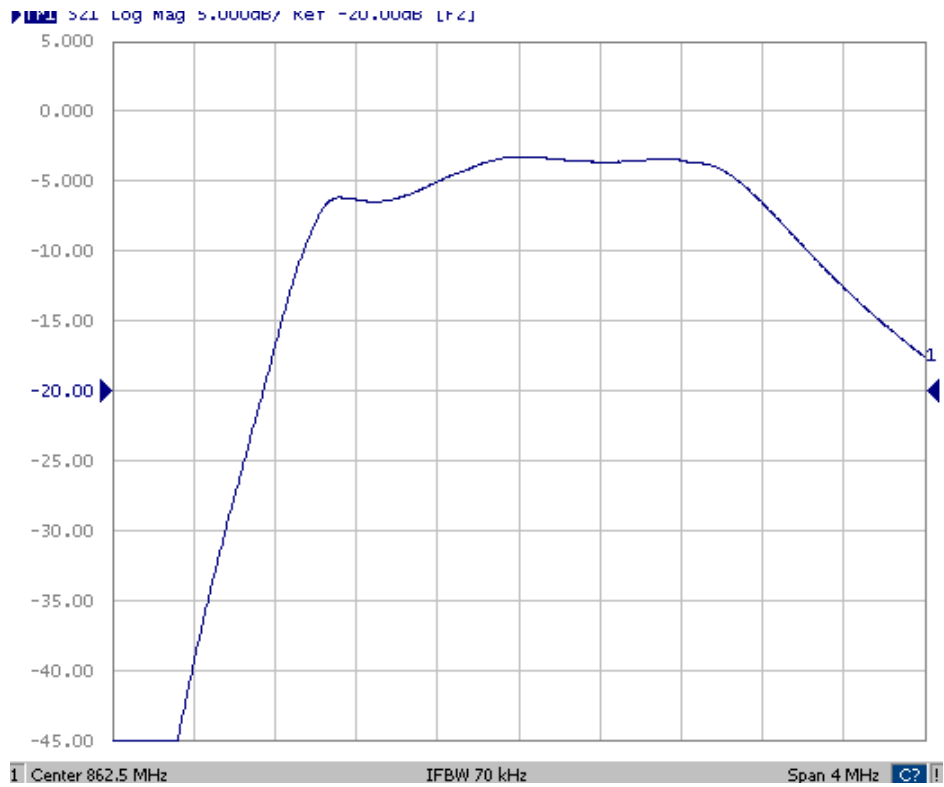

E.OUTLINE DRAWING:

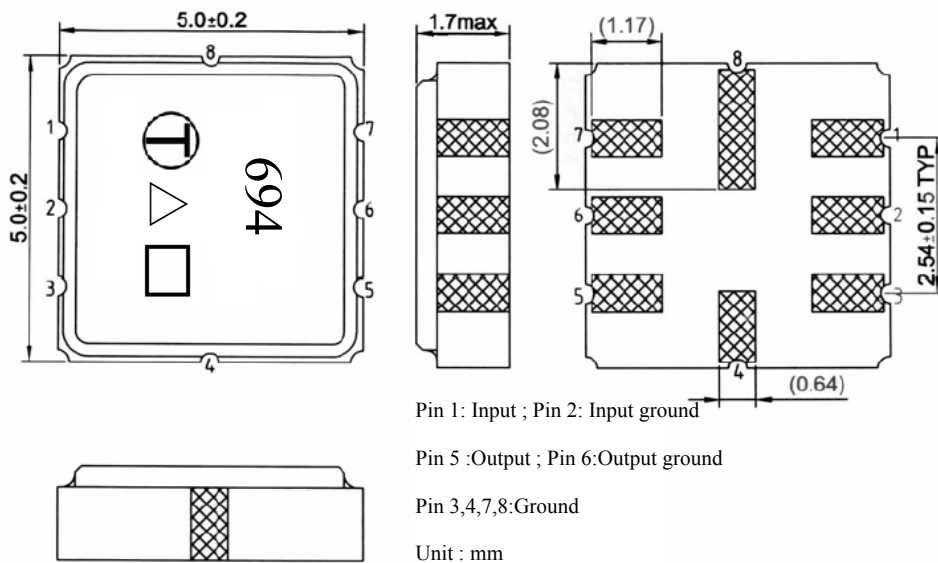

Pin 1: Input ; Pin 2: Input ground
 Pin 5 :Output ; Pin 6:Output ground
 Pin 3,4,7,8:Ground
 Unit : mm

- Date code: Provided by planer each year
- △ Product Year Code

Year	2005 2009	2006 2010	2007 2011	2008 2012
Product Code	A	a	<u>A</u>	<u>a</u>

F.PCB FOOTPRINT:

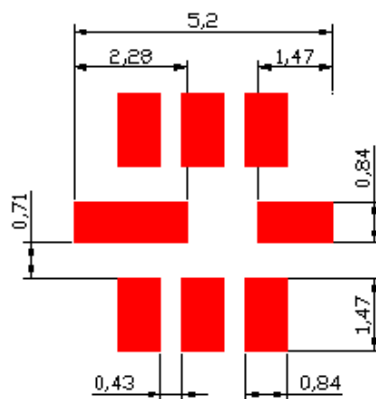

G. PACKING:

1. REEL DIMENSION

7"=1000

13"=3000

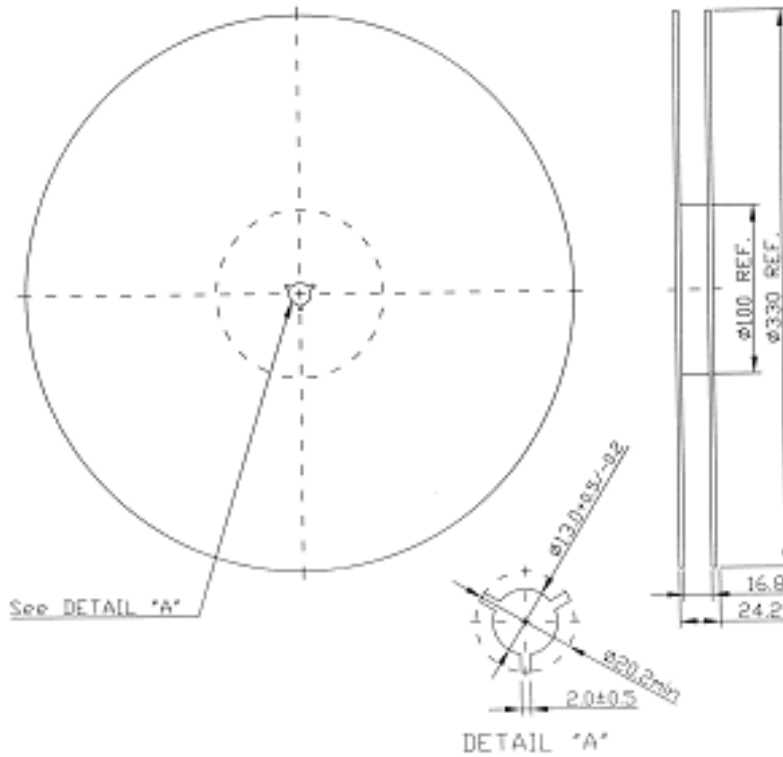

2. TAPE DIMENSION

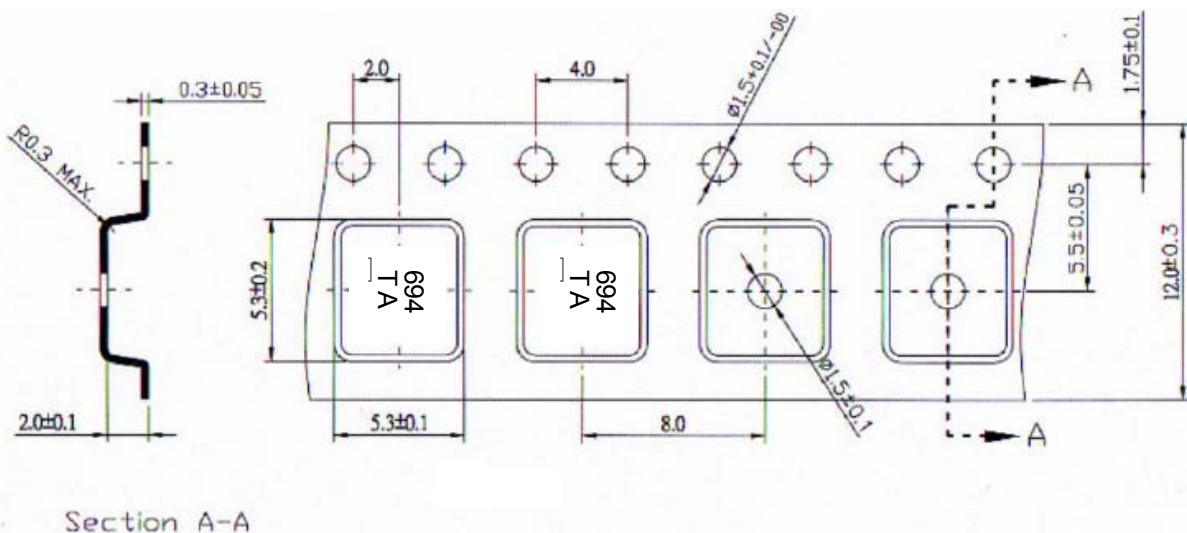

Direction of Feed

H.RECOMMENDED REFLOW PROFILE:

