

PART NO. 1201-25-9

REVISIONS	
ISSUE	CHANGES
C	ER 8354 RMS 05/29/08
D	ER 34758 COL 09/06/11

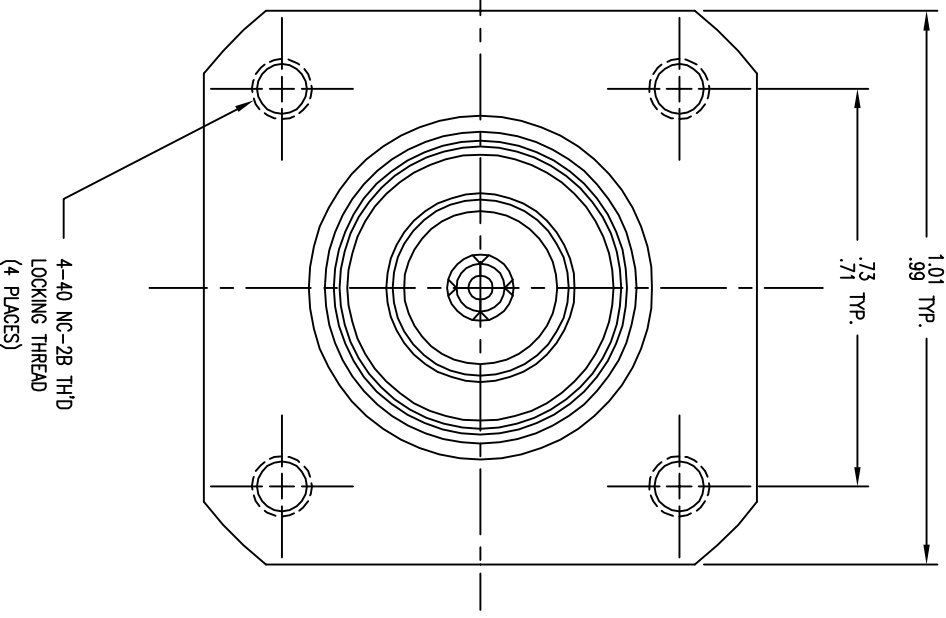
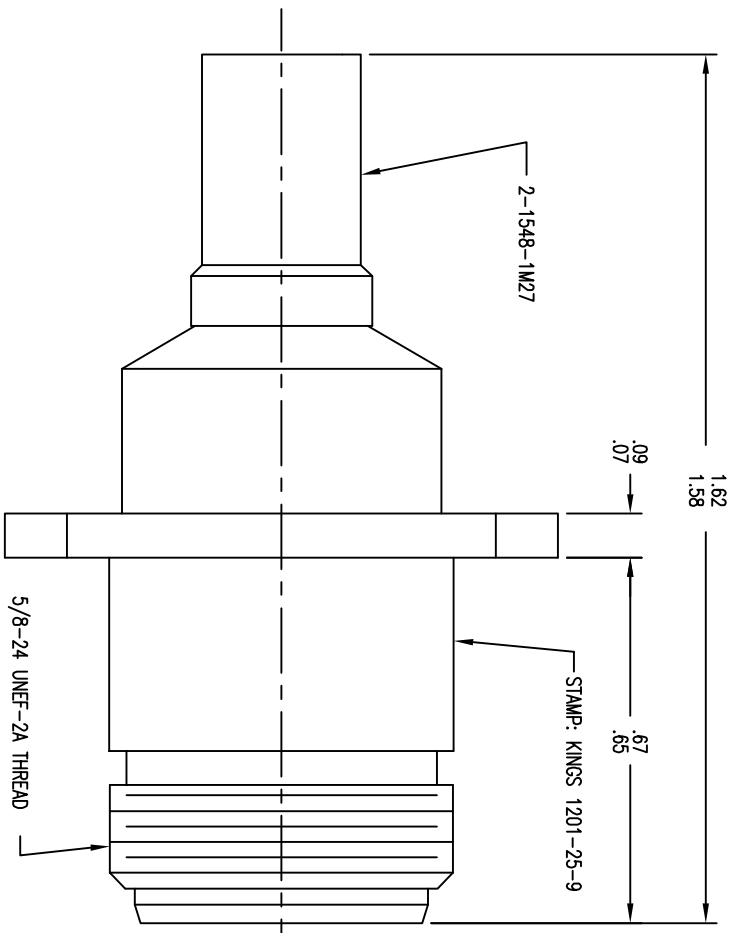

NOTES:

- FOR USE WITH BOEING BMS13-65 OG & ADAMS RUSSELL FC20Z CABLES.
- FOR CABLING INSTRUCTIONS SEE 3-546-2.
- FOR CRIMPING USE DIE KTH-2231.
- INTERFACE PER MIL-STD-348, FIG. 304-2.
- FOR USE WITH .22 MAX PANEL.
- CENTER CONTACT (1-534-98MA9) SUPPLIED UNASSEMBLED.
- MARK PACKAGE: KINGS 1201-25-9
- MATERIALS:
 XX XX (DATE/LOCATION CODE)
 INSULATOR: TEFLON, ASTM-D-1710
 K-GRIP SLEEVE: COM. BRONZE, ASTM-B135
 CENTER CONTACT: BER. COP., ASTM-B196
 ALL OTHER PARTS: BRASS, ASTM-B16

- FINISHES:
 CENTER CONTACTS: .000050 MIN GOLD PER ASTM B488 OVER, .000050 MIN NICKEL PER AMS-QQ-N-290(RoHS)
 ALL OTHER METAL PARTS: .000050 MIN NICKEL PLATE PER AMS-QQ-N-290 OVER, .000050 MIN COPPER PER ASTM B734(RoHS)
- ELECTRICAL CHARACTERISTICS:
 NOMINAL IMPEDANCE: 50 OHMS
 VOLTAGE RATING: 1000 VRMS
 FREQUENCY RANGE: DC TO 11 GHz
 INSERTION LOSS: DC TO 2.0 GHz, 0.045 dB MAX
 2.0 TO 4.2 GHz, 0.105 dB MAX
 4.2 TO 5.0 GHz, 0.185 dB MAX
- WEIGHT: 36.9 GRAMS (0.086 POUNDS)

UNLESS OTHERWISE SPECIFIED

- ALL DIMENSIONS IN INCHES [MILLIMETERS].
 - TOLERANCES:
 .XXX ±.004
 .XX ±.010
 .XX ±.10 [.XX ±.25]
 FRACTIONS: X/Y ±.010 [.25]
 ANGLES: ±1'
- ★ CRITICAL DIMENSIONS

CUSTOMER SALES DRAWING

THIS DRAWING, THE DESIGNS AND IDEAS EMBODIED IN THE DEVICE TO WHICH IT RELATES, AND THE METHOD OF PRODUCING THE DEVICE, ARE THE PROPERTY OF WINCHESTER ELECTRONICS CORPORATION AND SHALL NOT BE EMPLOYED, COPIED, OR DISCLOSED TO ANYONE IN ANY MANNER WITHOUT THE CONSENT OF WINCHESTER ELECTRONICS CORPORATION.

SCALE 4:1

APPROX SURFACE AREA

USED ON

CAGE CODE: 91836

JACK, PANEL, N

DRAWN KH	DATE 04/27/94
DESIGN JT	DATE 04/28/94
APPR.	DATE

WINCHESTER
 Winchester Electronics
 Road North Industrial
 Wellingford, CT 06492

1201-25-9

SIZE B