



RoHS Compliant

Features

- Crystal unit for Consumer Products
- Small and low profile (8.0×4.5×1.8mm)
- Ceramic package
- Reflow compatible

Applications

- Digital Electronics
- Consumer Products
- Car audio and accessories

How to Order

CX8045GB 07200 □□ □ □ □ □ □
 ① ② ③ ④ ⑤ ⑥ ⑦

- ① Series ② Frequency
 ③ Load Capacitance ④ Frequency Stability

H0	12 pF	Std.	H	±20×10 ⁻⁶	Std.
----	-------	------	---	----------------------	------

- ⑤ Operating Temp. Range ⑥ Frequency Temp. Stability

EQ	-10 to +70°C	±30×10 ⁻⁶	Std.	to 40000kHz
ET	-10 to +70°C	±100×10 ⁻⁶	Std.	from 40001kHz

- ⑦ Individual Specification

Packaging (Tape & Reel 3000/ 1000 pcs./ reel)

Specifications

Item	Symbol	Specification	Units	Remarks
Frequency Range	f _{nom}	4000 to 48000	kHz	
Overtone Order	OT	Fundamental	—	
Load Capacitance	CL	8 12	pF	
Frequency Stability	f _{tol}	±20	×10 ⁻⁶	25°C±3°C
Motional Series Resistance	R1	Table 1	ohm	
Drive Level	DL	Table 2	μW	
Operating Temp. Range	T _{use}	-10 to +70	°C	
Storage Temp. Range	T _{stg}	-40 to +85	°C	
Frequency Temp. Characteristics	f _{tem}	±30 (4000 to 40000kHz) ±100 (40001 to 48000kHz)	×10 ⁻⁶	Freq. deviation from the value at 25°C

• Please contact us for other specifications.

Typical Frequencies and Part Numbers

Frequency (kHz)	Part Number
7200.000	CX8045GB07200H0HEQZ1
14318.180	CX8045GB14318H0HEQZ1
16000.000	CX8045GB16000H0HEQZ1
16384.000	CX8045GB16384H0HEQZ1
16934.400	CX8045GB16934H0HEQZ1
19660.800	CX8045GB19660H0HEQZ1
20000.000	CX8045GB20000H0HEQZ1
21477.720	CX8045GB21477H0HEQZ1
24000.000	CX8045GB24000H0HEQZ1
24576.000	CX8045GB24576H0HEQZ1
27000.000	CX8045GB27000H0HEQZ1
28636.360	CX8045GB28636H0HEQZ1
30000.000	CX8045GB30000H0HEQZ1
32000.000	CX8045GB32000H0HEQZ1
36000.000	CX8045GB36000H0HEQZ1
40000.000	CX8045GB40000H0HEQZ1

Table1 Motional Series Resistance

Frequency Range	Motional Series Resistance
4000 to 7199kHz	300Ω max.
7200 to 9999kHz	200Ω max.
10000 to 11999kHz	150Ω max.
12000 to 48000kHz	100Ω max.

Table2 Level of Drive

Frequency Range	Level of Drive
4000 to 15999kHz	10μW (500μW max.)
16000 to 24999kHz	10μW (300μW max.)
25000 to 48000kHz	10μW (100μW max.)

Dimensions

(Unit: mm)

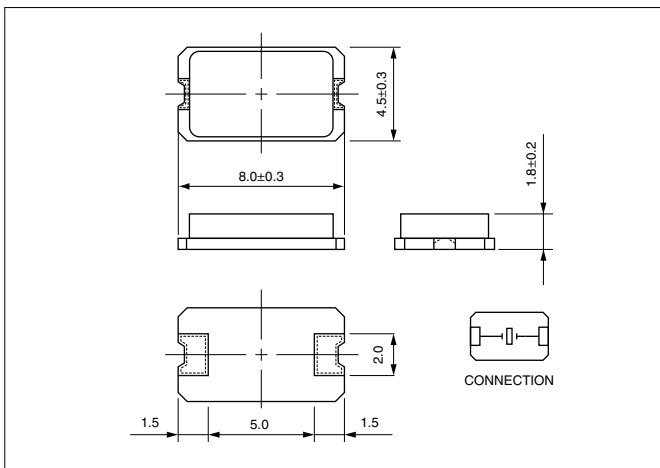

Recommended Land Pattern

(Unit: mm)

