

**PLEASE CHECK WWW.MOLEX.COM FOR LATEST PART INFORMATION**

**Part Number:** [0008500114](#)  
**Status:** **Active**  
**Overview:** [kk](#)  
**Description:** KK® Crimp Terminal, 22-30 AWG, Bag, Hot Tin (Sn) Dip, Nickel (Ni) Under Plating

**Documents:**

[Drawing \(PDF\)](#) [RoHS Certificate of Compliance \(PDF\)](#)  
[Product Specification PS-10-07 \(PDF\)](#)

**General**

Product Family	Crimp Terminals
Series	<a href="#">2759</a>
Crimp Quality Equipment	Yes
MolexKits	Yes
Overview	<a href="#">kk</a>
Product Name	KK®

**Physical**

Gender	Female
Material - Metal	Brass
Material - Plating Mating	Tin
Material - Plating Termination	Tin
Packaging Type	Bag
Plating min: Mating (µin)	100
Plating min: Mating (µm)	2.50
Plating min: Termination (µin)	100
Plating min: Termination (µm)	2.50
Termination Interface: Style	Crimp or Compression
Wire Insulation Diameter	1.57mm (.062") max.
Wire Size AWG	22, 24, 26, 28, 30
Wire Size mm²	N/A

**Material Info**

Old Part Number	2759-(P909)L
-----------------	--------------

**Reference - Drawing Numbers**

Packaging Specification	PK-2759-001
Product Specification	PS-10-07
Sales Drawing	SD-2759

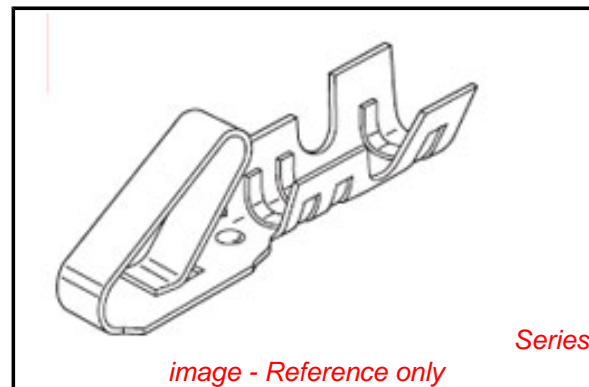

*image - Reference only*

**EU RoHS**

**ELV and RoHS  
Compliant**  
**REACH SVHC  
Contains SVHC: No**  
**Halogen-Free  
Status**

**China RoHS**



**Need more information on product  
environmental compliance?**

Email [productcompliance@molex.com](mailto:productcompliance@molex.com)  
 For a multiple part number RoHS Certificate of Compliance, [click here](#)

Please visit the [Contact Us](#) section for any non-product compliance questions.

**Search Parts in this Series**

[2759Series](#)

**Use With**

2695 , 5051 , 6745 , 41895

**Application Tooling | FAQ**

*Tooling specifications and manuals are found by selecting the products below. Crimp Height Specifications are then contained in the Application Tooling Specification document.*

**Global**

Description	Product #
Extraction Tool	<a href="#">0011030022</a>
Insertion Tool	<a href="#">0638120000</a>
Hand Crimp Tool	<a href="#">0638118200</a>

**Japan**

Description	Product #
Hand Extraction Tool	<a href="#">0011260059</a>

**PLEASE CHECK [WWW.MOLEX.COM](http://WWW.MOLEX.COM) FOR LATEST PART INFORMATION**

CARRIER VIEW

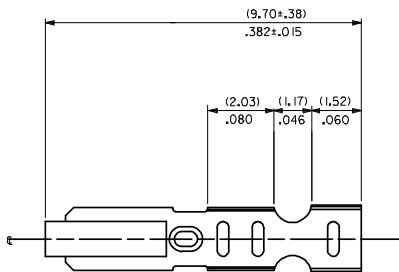
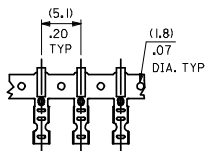

- NOTES
- MATERIAL  
(0.203±0.010)/.008D±.0004 THICK BRASS
  - FINISH  
102 - OVERALL TIN: (0.00508)/.000200 MIN. TIN OVER  
(0.00254)/.000100 MIN. COPPER  
122 - OVERALL TIN: (0.00381)/.000150 MIN. TIN OVER  
(0.00076)/.000030 MIN. NICKEL  
P909 - OVERALL HOT TIN DIP (0.00254)/.000100 MIN.  
550 - SELECT GOLD (0.00038)/.000015 MIN.  
OVERALL GOLD FLASH: (0.00005)/.000002 MIN.  
OVERALL NICKEL UNDERPLATE: (0.00076)/.000030 MIN.  
555- SELECT GOLD (0.00038)/.000015 MIN.  
OVERALL NICKEL UNDERPLATE: (0.00076)/.000030  
558 - SELECT GOLD: (0.00076)/.000030 MIN.  
OVERALL GOLD FLASH: (0.00005)/.000002 MIN.  
OVERALL NICKEL UNDERPLATE: (0.00127)/.000050 MIN.  
\*THE PRIMARY SHIPPING CARTON WILL BE LABELED "COMPLIANT TO RoHS  
DIRECTIVE 2002/95/EC AND ELV ANNEX II OF DIRECTIVE 2000/53/EC."  
CARTONS WITHOUT THIS LABEL MAY CONTAIN PRODUCT WITH TIN-LEAD PLATING.
  - PRODUCT SPEC: PS-10-07
  - PACKAGING SPECIFICATION: NONE
  - CRIMP IS FOR 22-30 GA WIRE WITH (1.57)/.062 DIA INSULATION MAX.
  - INSERTION FORCE OF TERMINAL INTO (2.54)/.100 CENTERLINE CONNECTOR IS 2.5 LBS. MAX
  - TERMINALS WILL RETAIN 8 LBS PULL FOR 1 MIN. IN A (2.54)/.100 CENTERLINE HOUSING.
  - DIMENSIONS GIVEN ACROSS CENTERLINES ARE SYMMETRICAL ABOUT THOSE CENTERLINES  
WITHIN HALF THE TOTAL TOLERANCE.
  - CODE LETTER PRECEDING PART NO. DESIGNATES MANUFACTURING LOCATION.  
I=IRELAND
  - THIS PART CONFORMS TO CLASS B REQUIREMENTS OF COSMETIC SPECIFICATION PS-45499-002.

SELECT GOLD LOCATION

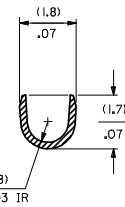
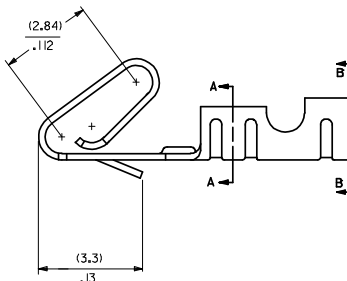
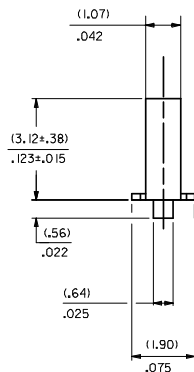
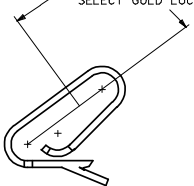

SECTION A-A  
BACKGROUND OMITTED

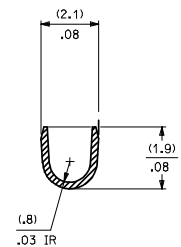

SECTION B-B  
BACKGROUND OMITTED

CRIMP DETAIL

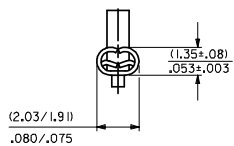

CRIMPED TERMINAL 2759-IP90)LC IS USED WITHOUT WIRE AND IS INSERTED INTO HOUSING TO PROVIDE TENSION WHEN ASSEMBLED TO HEADERS DURING SHIPMENT.

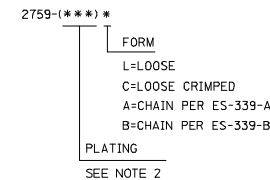
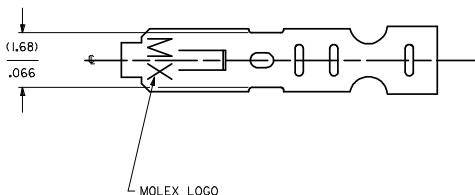

SH REV 1 AS3 2 AS4	UPDATE DIMS DEC NO: UCP/2008-2190 2008/03/17 DR: DRW: NADERR 2008/03/18 CHK: KOL: SCHMIDT 2008/03/18 APPR: F: SMITH 2008/03/24	QUALITY SYMBOLS	GENERAL TOLERANCES (UNLESS SPECIFIED)	DIMENSION STYLE	SCALE	DESIGN UNITS	THIRD ANGLE PROJECTION
		=0 ∇=0	mm INCH 4 PLACES ± --- ± --- 3 PLACES ± --- ± .010 2 PLACES ± 0.25 ± .014 1 PLACE ± 0.36 ± --- ANGULAR ± 1/2°	MM/IN DRAWN BY DATE SAMIEC 07/28/87 CHECKED BY DATE PATEL 07/28/87 APPROVED BY DATE LENZ 07/28/87	---	INCH	TITLE CRIMP TERMINAL 22-30 GA WIRE
		DRAFT WHERE APPLICABLE MUST REMAIN WITHIN DIMENSIONS	MATERIAL NO. SEE CHART	DOCUMENT NO. SD-2759	SHEET NO. 1 OF 2		

2759-***)*													
PART NO.	ENG. NO.	PART NO.	ENG. NO.	PART NO.	ENG. NO.	PART NO.	ENG. NO.	PART NO.	ENG. NO.	PART NO.	ENG. NO.	PART NO.	ENG. NO.
08-55-0101	2759-(555)B												
08-55-0102	2759-(555)L												
08-55-0126	2759-(555)A												
08-56-0109	2759-(550)B												
08-56-0110	2759-(550)L												
08-50-0113	2759-(P909)B												
08-50-0114	2759-(P909)L												
08-50-0124	2759-(P909)C												
08-51-0108	2759-(122)B												
	2759-(122)L												
I 08-50-0274	2759-(P909)B												
I 08-50-0275	2759-(P909)L												
I 08-50-0273	2759-(P909)A												
08-55-0130	2759-(558)B												
08-55-0131	2759-(558)L												
08-50-0160	2759-(102)L												
08-50-0159	2759-(102)												

<b>REMOVE *999 PARTS</b> EC NO: UCP2008-0722 DRAWN BY: 2007/08/02 CHKD: JRELL 2007/08/02 APPROV: SMITH 2007/08/03 AS4 REV DESCRIPTION	QUALITY SYMBOLS	GENERAL TOLERANCES (UNLESS SPECIFIED)	DIMENSION STYLE	SCALE	DESIGN UNITS	THIRD ANGLE PROJECTION												
	$\nabla=0$ $\nabla=0$	<table border="1"> <tr><th>mm</th><th>INCH</th></tr> <tr><td>4 PLACES ± --- ± ---</td><td></td></tr> <tr><td>3 PLACES ± --- ± ---</td><td></td></tr> <tr><td>2 PLACES ± --- ± ---</td><td></td></tr> <tr><td>1 PLACE ± --- ± ---</td><td></td></tr> <tr><td>ANGULAR ±1/2°</td><td></td></tr> </table>	mm	INCH	4 PLACES ± --- ± ---		3 PLACES ± --- ± ---		2 PLACES ± --- ± ---		1 PLACE ± --- ± ---		ANGULAR ±1/2°		MM/IN	---	INCH	
	mm	INCH																
	4 PLACES ± --- ± ---																	
3 PLACES ± --- ± ---																		
2 PLACES ± --- ± ---																		
1 PLACE ± --- ± ---																		
ANGULAR ±1/2°																		
		<table border="1"> <tr><td>DRAWN BY</td><td>DATE</td></tr> <tr><td>SAMIEC</td><td>07/28/87</td></tr> <tr><td>CHECKED BY</td><td>DATE</td></tr> <tr><td>PATEL</td><td>07/28/87</td></tr> <tr><td>APPROVED BY</td><td>DATE</td></tr> <tr><td>LENZ</td><td>07/28/87</td></tr> </table>	DRAWN BY	DATE	SAMIEC	07/28/87	CHECKED BY	DATE	PATEL	07/28/87	APPROVED BY	DATE	LENZ	07/28/87	TITLE	<b>CRIMP TERMINAL</b> <b>22-30 GA WIRE</b>		
DRAWN BY	DATE																	
SAMIEC	07/28/87																	
CHECKED BY	DATE																	
PATEL	07/28/87																	
APPROVED BY	DATE																	
LENZ	07/28/87																	
		DRAFT WHERE APPLICABLE MUST REMAIN WITHIN DIMENSIONS	MATERIAL NO. <b>SEE CHART</b>	DOCUMENT NO. <b>SD-2759</b>	<b>MOLEX INCORPORATED</b>													
			SIZE <b>D</b>	THIS DRAWING CONTAINS INFORMATION THAT IS PROPRIETARY TO MOLEX INCORPORATED AND SHOULD NOT BE USED WITHOUT WRITTEN PERMISSION														