

DASH NO. M CODE MADE FROM

GSD

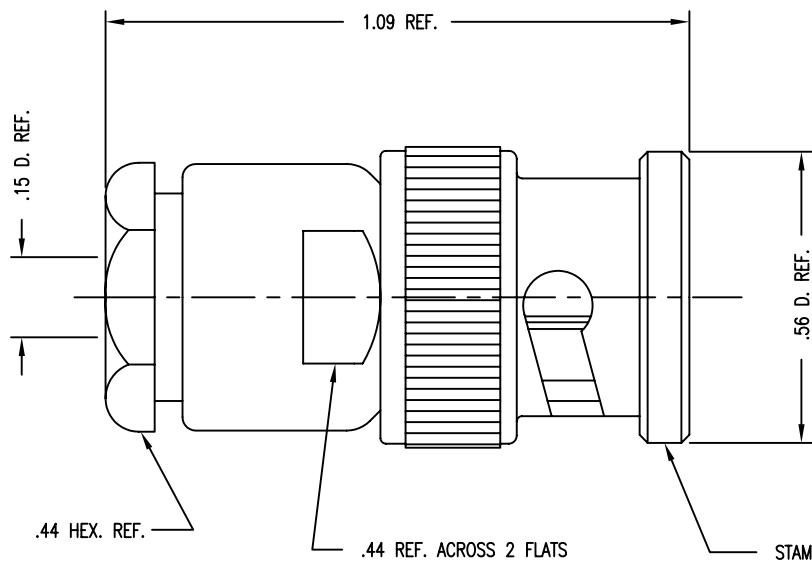

NOTES:

1. FOR USE WITH RG-174, 179, 187, 188, 316/U AND BACIO-60875 CABLE.
2. FOR CRIMPING USE DIE SIZE 24.
3. FOR CABLING INSTRUCTIONS SEE CP-225A .3.
4. MATERIALS:
 - INSULATORS-TEFLON, L-P-403
 - GASKETS-SILICONE RUBBER, ZZ-R-765
 - K-GRIP SLEEVE-COMMERCIAL BRONZE, ALLOY 220
 - CENTER CONTACT } BER. COP., QQ-C-530
 - SPRING WASHER } BER. COP., QQ-C-530
 - OUTER CONTACT }
 - ALL OTHER METAL PARTS-BRASS, QQ-B-626
5. FINISHES:
 - ALL METAL PARTS-SILVER PLATE PER QQ-S-365
6. ELECTRICAL CHARACTERISTICS:
 - NOMINAL IMPEDANCE-50 OHMS
 - FREQUENCY RANGE-DC TO 4 GHZ
 - WORKING VOLTAGE-500 VRMS

KC-59-239

REVISIONS

ISSUE	CHANGES
4	CN 26414 C AJ 18 SEP 84

SCALE 4:1

APPROX SURFACE AREA

USED ON

REF:

BNC POLARIZED PLUG

DRAWN KH DATE 06/25/90

DESIGN MJB DATE 06/27/90

APPR. DATE

KINGS
ELECTRONICS CO., INC.
TUCKAHOE, NEW YORK 10707

GSD

KC-59-239