

Common Mode Chokes - Series 40

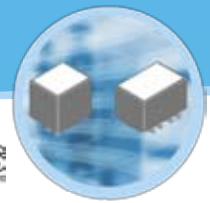

- Both Thru-Hole (B) & Surface Mount (R) Versions Available
- Broadband Filtering At High Currents
- Up to 20 Amps Operating Capability
- Low DCR

Part Number	TYPICAL IMPEDANCE (Ω)				Typical Peak Impedance (Ω)	Typical Peak Impedance Frequency (MHz)	DCR MAX (Ω)	Rated I MAX (continuous) mA
	Z @ 25 MHz	Z @ 100 MHz	Z @ 500 MHz	Z @ 1 GHz				
CM3440Z171B-10	116	170	189	202	202	1000	0.0010	20,000
CM3440Z171R-10	116	170	189	202	202	1000	0.0010	20,000
CM5740Z171B-10	116	170	189	202	202	1000	0.0010	20,000
CM5740Z171R-10	116	170	189	202	202	1000	0.0010	20,000

Part Number	Fig #	Installation Orientation	# of Chokes	A mm (inches)	B mm (inches)	C mm (inches)
CM3440Z171B-10	1	Thru-Hole	1	8.51 (0.335)	10.03 (0.395)	9.32 (0.367)
CM3440Z171R-10	2	Surface Mount	1	8.51 (0.335)	10.03 (0.395)	9.32 (0.367)
CM5740Z171B-10	3	Thru-Hole	2	14.48 (0.570)	10.03 (0.395)	9.32 (0.367)
CM5740Z171R-10	4	Surface Mount	2	14.48 (0.570)	10.03 (0.395)	9.32 (0.367)

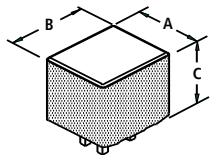

Figure #1
Thru-Hole

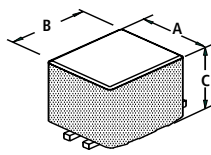

Figure #2
Surface Mount

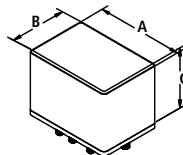

Figure #3
Two Chokes / Thru-Hole

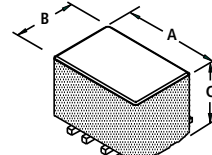

Figure #4
Two Chokes / Surface Mount

