

# SERIES

## SDS680R



### Surface Mount Shielded Power Choke

DASH NUMBER*	INDUCTANCE (μH) C 100 kHz	TOLERANCE	SRF (MHz) REF. ONLY	DC RESISTANCE MAXIMUM (OHMS)	CURRENT RATING MAXIMUM (mA)
--------------	------------------------------	-----------	---------------------	---------------------------------	--------------------------------

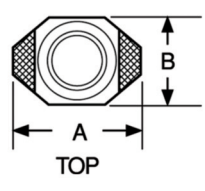
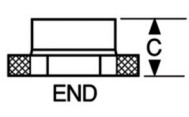
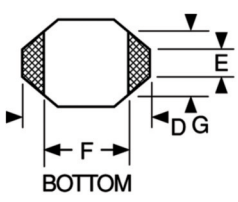

Actual Size

#### Physical Parameters

	Inches	Millimeters
A	0.260 Max.	6.60 Max.
B	0.175 Max.	4.45 Max.
C	0.115 Max.	2.92 Max.
D	0.040 ±0.010	1.02 ±0.25
E	0.050 Max.	1.27 Max.
F	0.170 ±0.015	4.32 ±0.38
G	0.120 Ref.	3.05 Ref.
H	0.055 Ref.	1.40 Ref.
I	0.140 Ref.	3.56 Ref.
J	0.160 Ref.	4.06 Ref.

**Current rating at 25°C Ambient**  
40°C Max. Rise

**Operating Temperature Range**  
-40°C to +85°C

**Weight Maximum**  
0.20 grams

**Marking** For values lower than 10 H the R indicates a decimal point and the remaining digits indicate the inductance in H. For values 10 H and above, the first two digits indicate the inductance in H and the third digit indicates the number of trailing zeros where a zero indicates that there are no trailing zeros.

Example: SDS680R-102M (1.0 μH)  
1R0

Example: SDS680R-106M (10,000 μH)  
103

#### Packaging

Tape & Reel (16mm): 13" reel  
2000 pieces max.

SERIES SDS680 FERRITE CORE & SLEEVE					
-102M	1.0	±20%	250	0.040	3000
-152M	1.5	±20%	125	0.045	2800
-222M	2.2	±20%	120	0.050	1800
-332M	3.3	±20%	120	0.055	1600
-472M	4.7	±20%	105	0.060	1400
-682M	6.8	±20%	50	0.065	1200
-103M	10	±20%	38	0.075	1000
-153M	15	±20%	33	0.090	800
-223M	22	±20%	25	0.110	700
-333M	33	±20%	20	0.190	600
-473M	47	±20%	20	0.230	500
-683M	68	±20%	15	0.290	400
-104M	100	±20%	10	0.480	300
-154M	150	±20%	9	0.590	260
-224M	220	±20%	6	0.770	220
-334M	330	±20%	5	1.40	200
-474M	470	±20%	4	1.80	190
-684M	680	±20%	3	2.20	180
-105M	1000	±20%	2	3.40	150
-155M	1500	±20%	2	4.20	120
-225M	2200	±20%	2	8.50	100
-335M	3300	±20%	1	11.0	80
-475M	4700	±20%	1	13.9	60
-685M	6800	±20%	1	25.0	40
-106M	10000	±20%	0.8	32.8	20

\*Complete part # must include series # PLUS the dash #  
For surface finish information, refer to [www.delevanfinishes.com](http://www.delevanfinishes.com)

