

Type: M-7LG

Product Description

- 7.8 × 7.8mm Max.(L × W), 12.5mm Max. Height.
- In addition to the reference versions of parameters shown here, custom designs are available to meet your exact requirements

Feature

- High inductance variable shielded type.
- RoHS Compliance

Dimensions (mm)

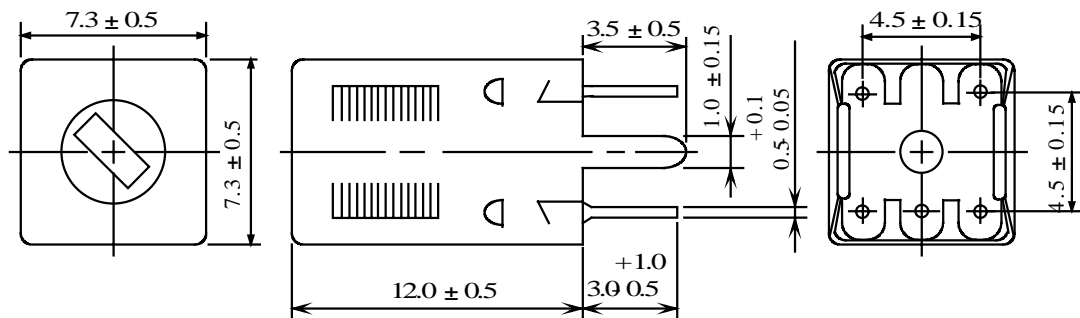

- * Dimension does not include solder used on coil.
- * Pin pitch should be measured at the root of terminal.

Connection (Bottom View)

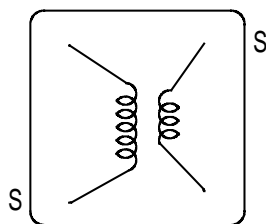

“ S ” is winding start.

Specification (Part No.S0080074)

Item	(1 - 3)	Measuring Conditions
Tuning Capacity(Ext,)	2200 p F $\pm 6\%$	57kHz
Unloaded Q	75 Min.	57kHz
Loaded Q	35 \pm 20% Within	57kHz
External resistance 4.7 K is connected between (4-6) when measuring loaded Q .		