



Copyright FCI.

A

B

C

D

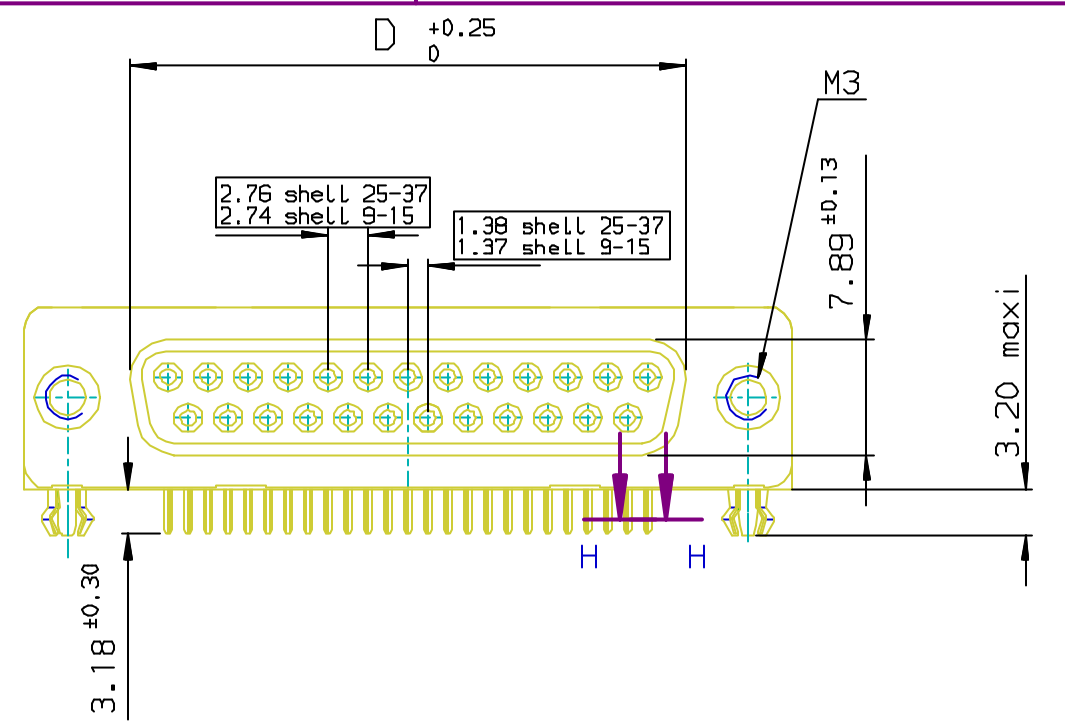
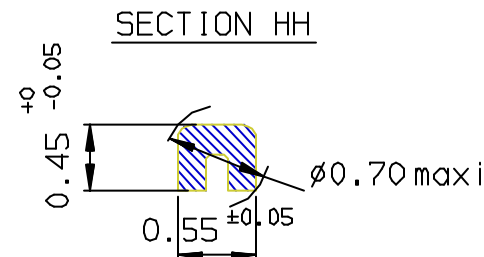
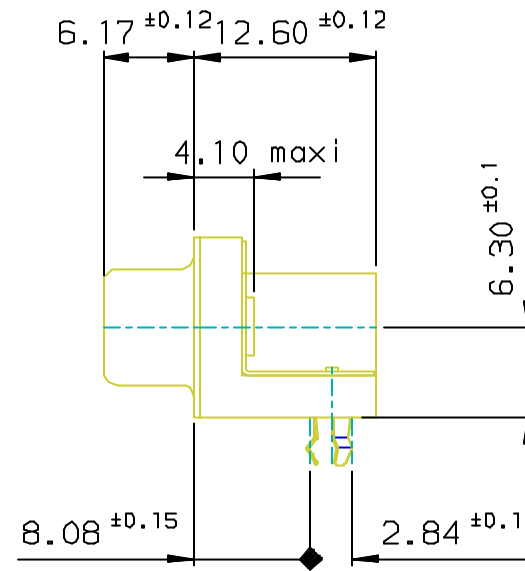
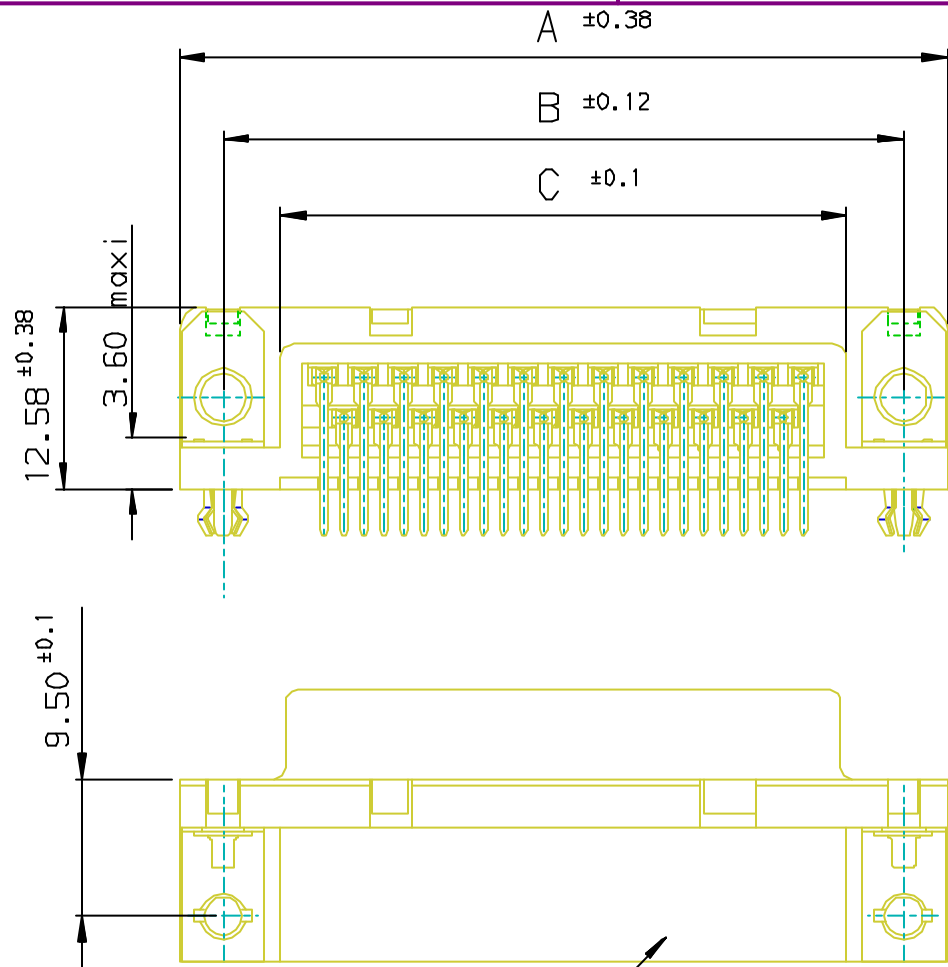

PC card drilling dimensions (after plating)
(thickness 1.60±0.20mm)

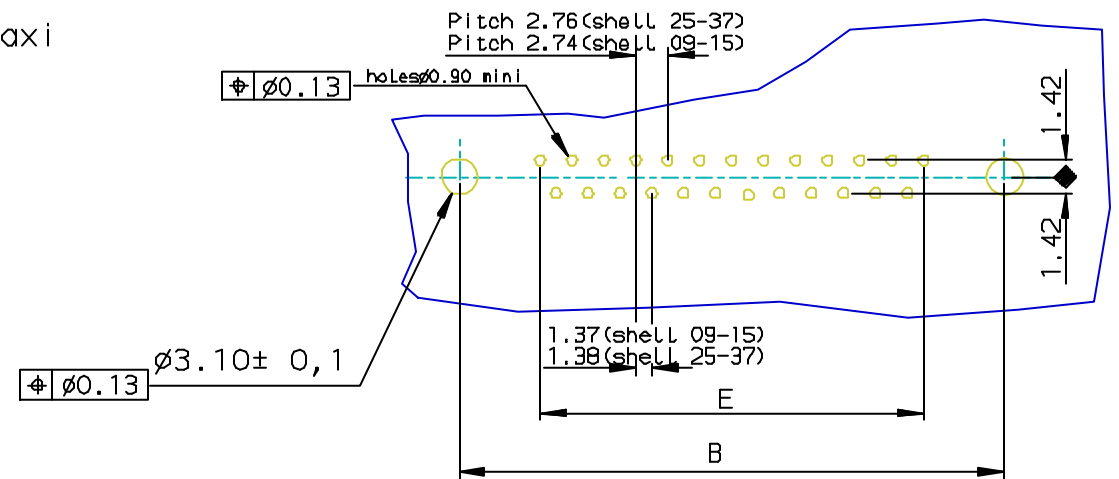

Part Number & Date Code Printing

SHELL	A±0.38	B±0.12	C±0.10	D±0.25	E±0.07	PART NUMBER	PART NUMBER
09	30.81	24.99	16.96	16.21	10.96	D09S33E4GL00**	D09S33E6GL00**
15	39.14	33.32	25.18	24.54	19.18	D15S33E4GL00**	D15S33E6GL00**
25	53.03	47.04	39.12	38.25	33.12	D25S33E4GL00**	D25S33E6GL00**
37	69.32	63.50	55.68	54.71	49.68	D37S33E4GL00**	D37S33E6GL00**
						Gold flash	0,76 µ gold

LF FOR LEAD FREE

REQUIREMENTS

Technical characteristics:

Shell: steel tin/Zinc Cr3 plated
 Insulators: self-extinguishing thermoplastic, ULclass94V0
 Contacts: phosphor bronze, gold (for thickness see table)
 over 2 µ mini nickel on active area and flash to 1.5 µ maxi SnPb
 over 1µ mini nickel on termination.

Cycles ; 200 min for plating 4.

Cycles ; 500 min for plating 6.

Harpoon: phosphor bronze, tin plated.

Metal plate for electrical continuity: brass, tin/Zinc Cr3 plated

Nuts: brass, tin/Zinc Cr3 plated

Electrical characteristics:

max. current rating: 5A

Test voltage: 1000V

Rated voltage: 300V

Contact resistance: ≤15mΩ

Shell resistance: ≤5mΩ

Insulation resistance: ≥5000MΩ

Climatic characteristics:

Operating temperature range: -55°C +125°C

Dimensions:

in accordance with MIL-C-24308

FOR ROHS DETAILS REFER DWG.N0:C018646-0000

European Views

rev	ecn no	dr	date
C	105-0124	JS	2005/07/27
D	106-0074	SK	2006/06/08
-	-	-	-
-	-	-	-
-	-	-	-
-	-	-	-

www.fciconnect.com		surface ISO 1302 ✓	tolerance std ISO 406 ISO 1101	projection mm
TOLERANCES UNLESS OTHERWISE SPECIFIED				
Dr	JOHN SLEEBA	1994/09/09	ANGULAR	0.X ±0.1
Eng	GEORGE VJ	1994/09/09	LINEAR	0.XX ±0.1
Chr	GEORGE VJ	2005/07/27	0.XX* ±1*	0.XXX ±0.1
Appr	KVSD	2005/07/27	Product family	D-SUB Spec ref -
FCI		title SOCKET CONNECT.DELTA D RIGHT ANGLED WITH SCREWLOCK, HARPOON & METAL PLATE.		Rev. D
catalog no		DELTA-D		dwg no C01-8646-0318
		CUSTOMER		sheet 1 of 1

REV F - 2006-04-17