

SWITCH FUNCTION	
POS. 1	POS. 2
ON	(ON)
3-1, 4-6	3-2, 4-5

(ON) = MOMENTARY

NOTES:

1. ALL DIMENSIONS IN mm [INCHES]
2. GENERAL TOLERANCE: x.x= ±0.4
x.xx=±.25
3. TERM. NOS. FOR REF. ONLY
4. RATING: 0.1A; 30V
5. CONTACT RESISTANCE: 100 MILLI-OHMS MAX.
6. TIMING: NON-SHORTING
7. TRAVEL: FULL 2.5mm
- ▲8. OPERATING FORCE: 180 ± 50gf
9. ELECTRICAL LIFE: 10,000 CYCLES MAKE AND BREAK
CYCLES AT FULL LOAD
10. ▲DENOTE CRITICAL PARAMETER

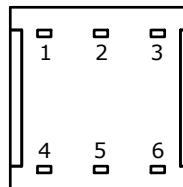
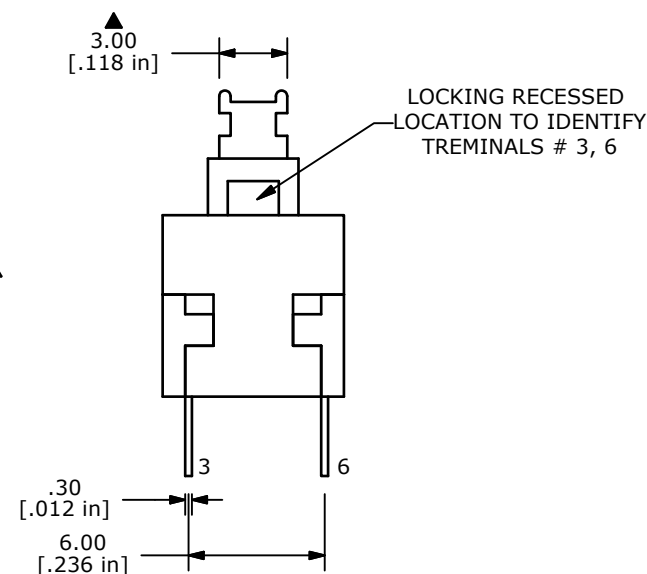
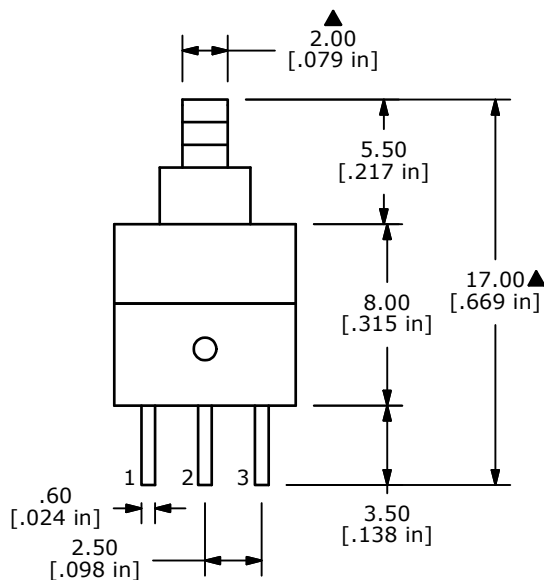

D	19713	CORRECTED SWITCH FUNC. TERMINALS	2/24/11	BGL
C	19639	DRAWING UPDATE	2/1/11	BGL
REV	PCR NO	DESCRIPTION	DATE	BY

TITLE TL2285OA				
SCALE	DATE	DR	DWG	REV
3:1	1/31/2011	BGL	P010450	D

THE INFORMATION CONTAINED IN THIS DOCUMENT IS PROPRIETARY TO E-SWITCH AND IS NOT TO BE COPIED OR TRANSFERRED