



# TAI-SAW TECHNOLOGY CO., LTD.

No. 3, Industrial 2nd Rd., Ping-Chen Industrial District,  
Taoyuan, 324, Taiwan, R.O.C.

TEL: 886-3-4690038 FAX: 886-3-4697532

E-mail: [tstsales@mail.taisaw.com](mailto:tstsales@mail.taisaw.com) Web: [www.taisaw.com](http://www.taisaw.com)

## Approval Sheet For Product Specification

Issued Date: February, 15, 2008

Product Name: SAW Filter 283.5MHz SMD 5X7 mm

TST Parts No.: :TB0613A

Customer Parts No.: \_\_\_\_\_

Company: _____
Division: _____
Approved by : _____
Date: _____

Checked by: Paul Ni

Approval by: Francis Chen

Date: 2008/2/15



# TAI-SAW TECHNOLOGY CO., LTD.

No. 3, Industrial 2nd Rd., Ping-Chen Industrial District,  
Taoyuan, 324, Taiwan, R.O.C.

TEL: 886-3-4690038 FAX: 886-3-4697532

E-mail: [tstsales@mail.taisaw.com](mailto:tstsales@mail.taisaw.com) Web: [www.taisaw.com](http://www.taisaw.com)

## SAW Filter 283.5 MHz

MODEL NO.: TB0613A

REV. NO.:1

### A. MAXIMUM RATING:

1. Input Power Level: 10 dB<sub>m</sub>
2. DC voltage: 5 V
3. Operating Temperature: : -20°C to +60°C
4. Storage Temperature: -40°C to +85°C

RoHS Compliant  
Lead free  
Lead-free soldering

### B. ELECTRICAL CHARACTERISTICS:

Item	Unit	Min.	Typ.	Max.
Center frequency <b>F<sub>c</sub></b>	MHz	-	283.5	-
Minimum Insertion Loss, ( <b>F<sub>c</sub>±50KHz</b> ) <b>IL</b>	dB	-	4.2	6.5
Passband Ripple ( <b>F<sub>c</sub>±50KHz</b> )	dB	-	0.6	2.0
Group delay ripple ( <b>F<sub>c</sub>±50KHz</b> ), <b>GD</b>	μs	-	0.9	3.0
<b>Attenuation</b> (Reference level from 0 dB)				
<b>F<sub>c</sub> – 25</b> to <b>F<sub>c</sub> – 1.6</b> MHz	dB	50	65.0	-
<b>F<sub>c</sub> – 1.6</b> to <b>F<sub>c</sub> – 0.6</b> MHz	dB	28	64.7	-
<b>F<sub>c</sub> + 0.6</b> to <b>F<sub>c</sub> + 1.6</b> MHz	dB	28	63.7	-
<b>F<sub>c</sub> + 1.6</b> to <b>F<sub>c</sub> + 25</b> MHz	dB	50	63.0	-

### C. MEASUREMENT CIRCUIT:

50 Ohm Test circuit (single-ended / single-ended)

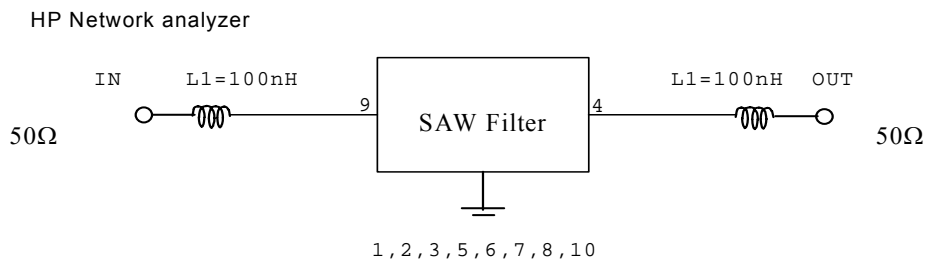

**D.OUTLINE DRAWING:**

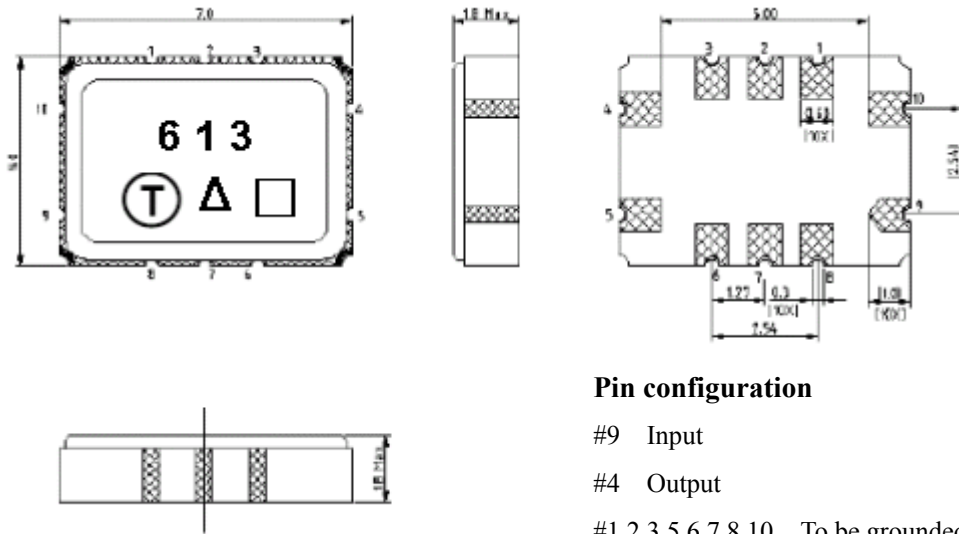

**Pin configuration**

- #9 Input
- #4 Output
- #1,2,3,5,6,7,8,10 To be grounded
- Δ Year Code
- Date code
- Unit mm

Δ Product Year Code

Year	2001 2005	2002 2006	2003 2007	2004 2008
Product Code	B	b	<u>B</u>	<u>b</u>

**E. PCB Footprint:**

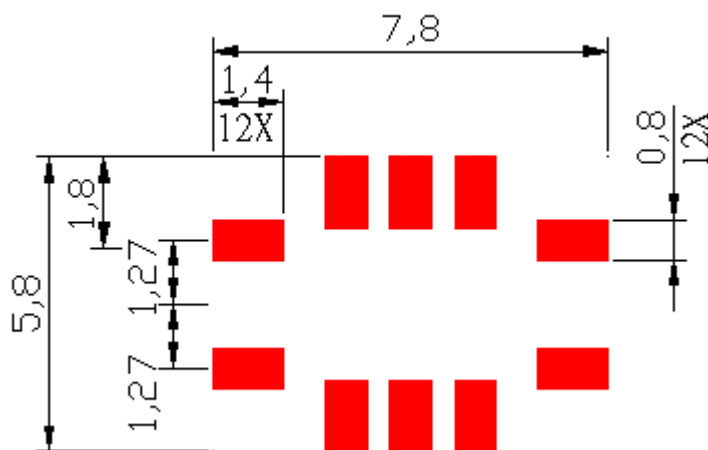

## F. Frequency Characteristics :

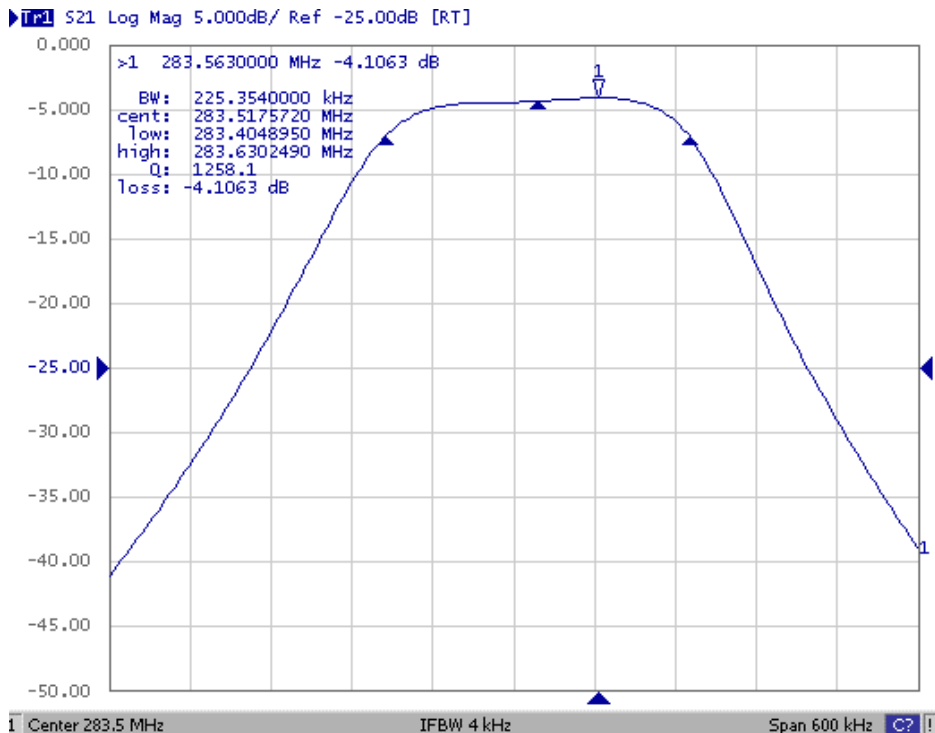
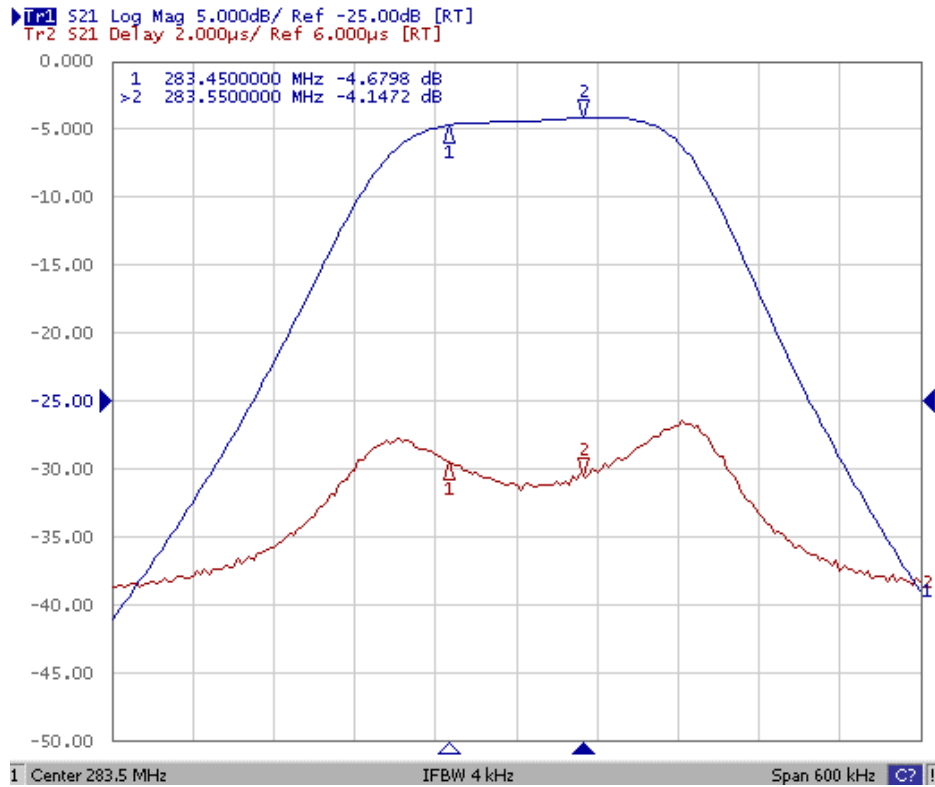

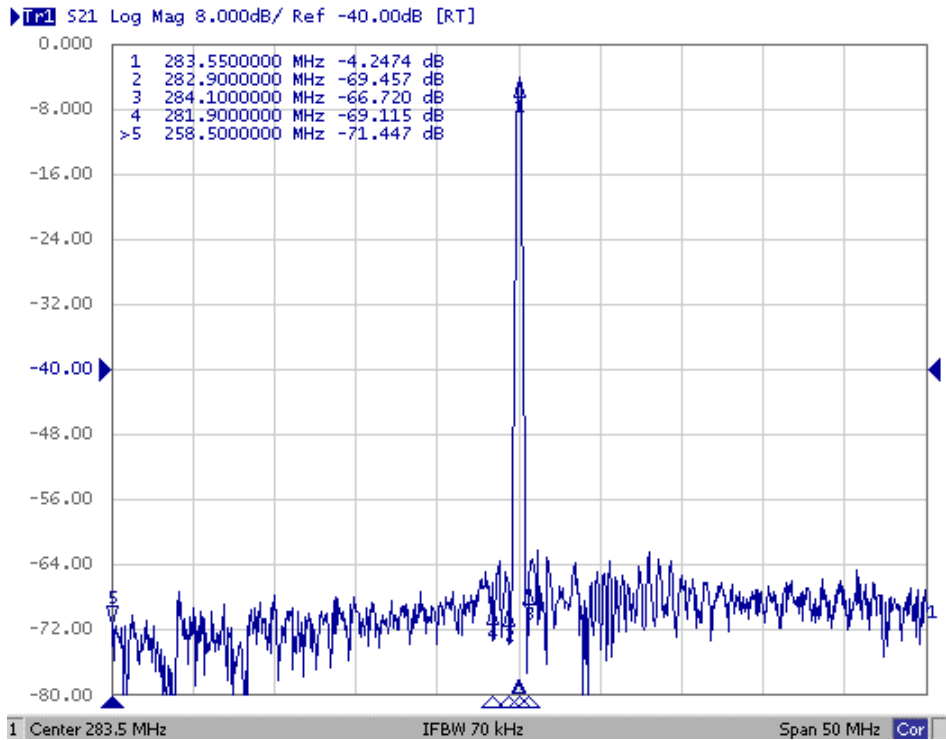
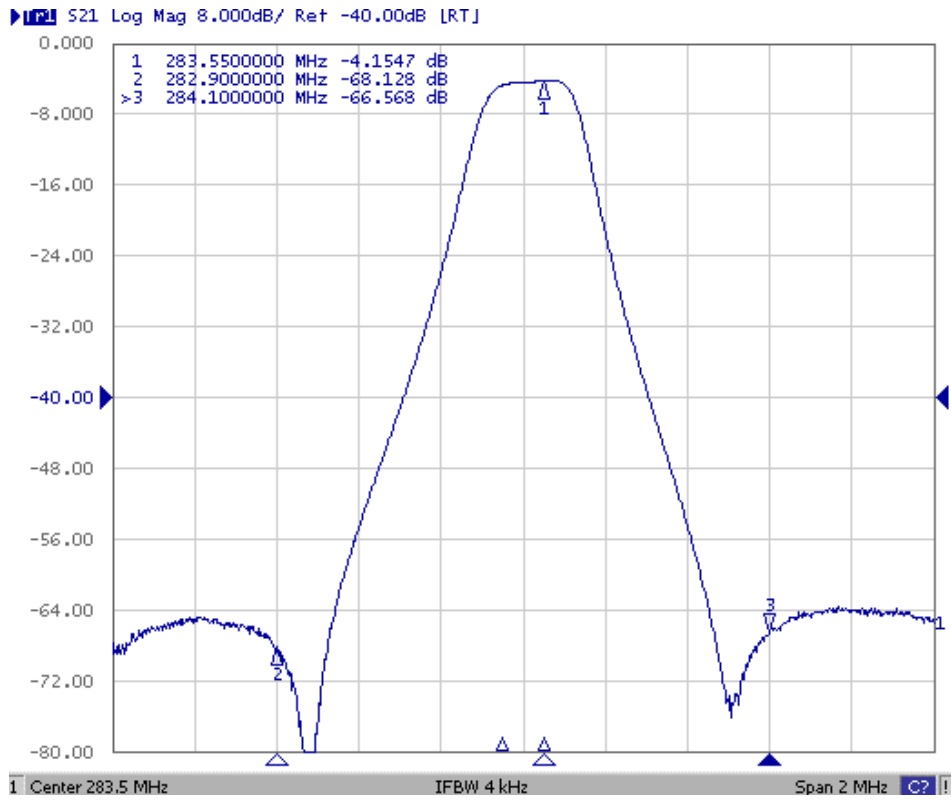

**G. PACKING:**  
**1. REEL DIMENSION**

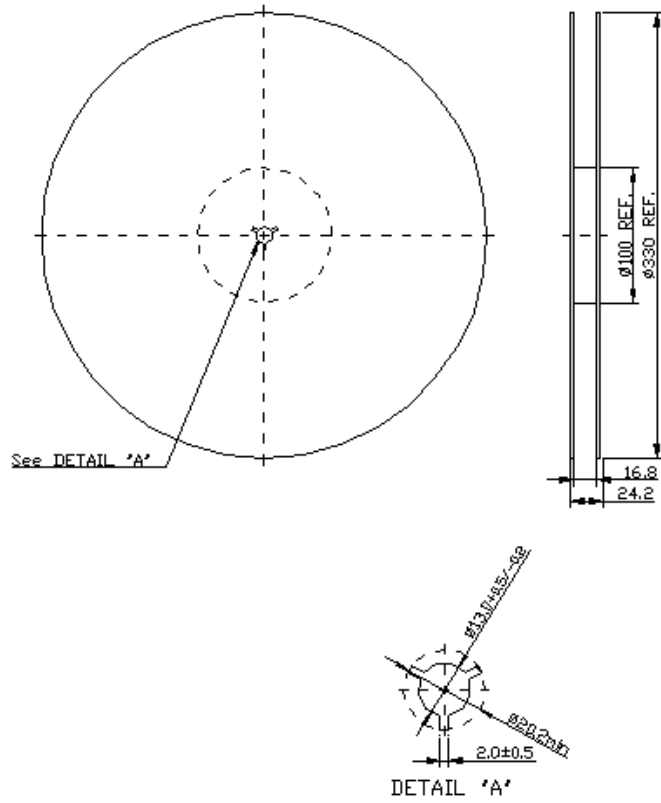

**2. TAPE DIMENSION**

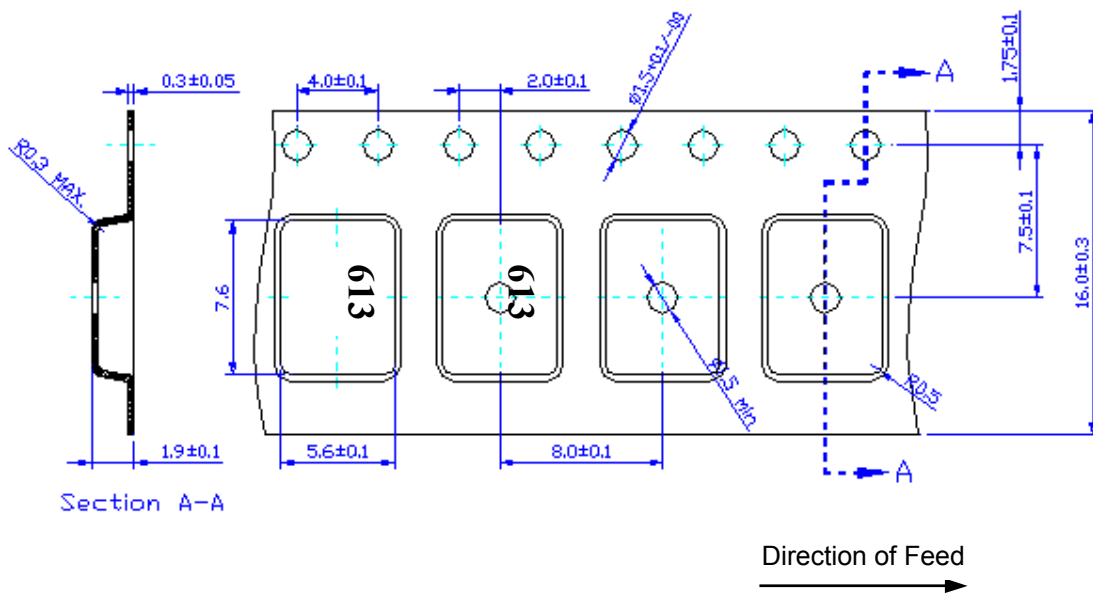

H.RECOMMENDED REFLOW PROFILE:

