

MATERIAL NUMBER	ENGINEERING NUMBER	WIRE RANGE	"L" MAX	"A" MIN	"B" MAX	MATERIAL	MATERIAL THICKNESS	TEMPERATURE RATING
192030165	A-T-302	22-18 (0.3-1.0mm <sup>2</sup> )	.330 / (8.4)	.060 / (1.5)	.130 / (3.3)	COPPER	.032 / (0.8)	650F (342C)
192030172	B-T-304	16-14 (1.2-2.0mm <sup>2</sup> )	.330 / (8.4)	.091 / (2.3)	.160 / (4.1)	COPPER	.032 / (0.8)	650F (342C)
192030169	C-T-303	12-10 (3.0-6.0mm <sup>2</sup> )	.330 / (8.4)	.130 / (3.3)	.225 / (5.7)	COPPER	.040 / (1.0)	650F (342C)

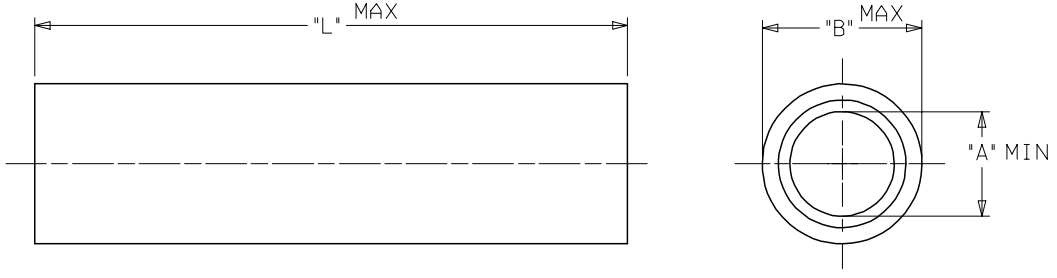

NOTES:  
 1. PLATING: ELECTRO-NICKEL.  
 2. ALL DIMENSIONS IN INCHES/(MM).  
 3. RoHS COMPLIANT

RELEASE FOR PROD  
 EC NO: ETC2007-0146  
 DRW: JLOMASTRO 2006/10/11  
 CHKD: JMACNEIL 2006/10/11  
 APPR: JMACNEIL 2006/10/12

REV	DESCRIPTION
A	

QUALITY SYMBOLS	GENERAL TOLERANCES (UNLESS SPECIFIED)
= 0	4 PLACES ± --- ± ---
= 0	3 PLACES ± --- ± .010
	2 PLACES ± 0.25 ± .01
	1 PLACE ± 0.3 ± ---
	ANGULAR ±1/2°

DIMENSION STYLE IN/MM	
DRAWN BY	DATE
JLOMASTRO	10/02/06
CHECKED BY	DATE
JMACNEIL	10/02/06
APPROVED BY	DATE
RDEROSS	10/04/06

SCALE	DESIGN UNITS	THIRD ANGLE PROJECTION
	INCH	
TITLE		
PARALLEL SPLICE VERSAKRIMP TEMP TERMS		
MATERIAL NO. SEE CHART		
DOCUMENT NO. SD-19203-042		SHEET NO. 1 OF 1
THIS DRAWING CONTAINS INFORMATION THAT IS PROPRIETARY TO MOLEX INCORPORATED AND SHOULD NOT BE USED WITHOUT WRITTEN PERMISSION		