

# SMT Power Inductor (MOLDING TYPE)

## MPT730M1 Type

### Features

- RoHS compliant.
- Low profile , high current SMD type.
- Magnetically shielded, suitable for high density mounting.
- High energy storage and low DCR.
- Ideal for power source circuits, DC-DC converter, DC-AC inverters inductor applications.

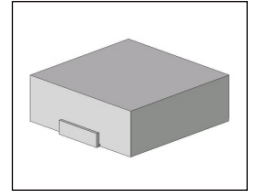

### Mechanical Dimension:

#### RECOMMENDED PAD PATTERNS

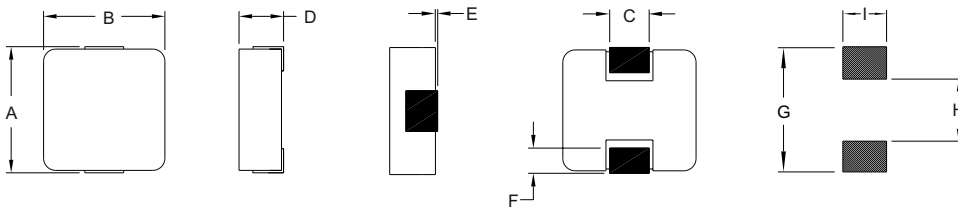

UNIT : mm/inch  
 A = 7.30 / 0.287 Max.  
 B = 6.80 / 0.268 Max.  
 C = 3.00±0.30 / 0.118±0.012  
 D = 3.00 / 0.118 Max.  
 E = 0~0.15 / 0~0.006  
 F = 1.60±0.30 / 0.063±0.012  
 G = 8.40 / 0.331  
 H = 3.70 / 0.146  
 I = 3.50 / 0.138

### Electrical Characteristics: 25°C: 100KHz, 0.25V

PART NO.	L0 ( $\mu$ H)	DCR (m $\Omega$ ) TYP.	DCR (m $\Omega$ ) MAX.	Isat <sup>2</sup> (Adc)	Ir <sup>3</sup> (Adc)
MPT730 - R10M1	0.10	1.5	1.7	60.0	32.5
MPT730 - R20M1	0.20	2.4	3.0	41.0	24.0
MPT730 - R22M1	0.22	2.5	2.8	40.0	23.0
MPT730 - R33M1	0.33	3.5	3.9	30.0	20.0
MPT730 - R47M1	0.47	4.0	4.2	26.0	17.5
MPT730 - R68M1	0.68	5.0	5.5	25.0	15.5
MPT730 - R82M1	0.82	6.7	8.0	24.0	13.0
MPT730 - 1R0M1	1.00	9.0	10.0	22.0	11.0
MPT730 - 1R2M1	1.20	10.0	12.0	20.0	10.0
MPT730 - 1R5M1	1.50	14.0	15.0	18.0	9.0
MPT730 - 2R2M1	2.20	18.0	20.0	14.0	8.0
MPT730 - 2R5M1	2.50	20.0	22.0	14.0	7.0
MPT730 - 3R3M1	3.30	28.0	30.0	13.5	6.0
MPT730 - 4R7M1	4.70	37.0	40.0	10.0	5.5
MPT730 - 6R8M1	6.80	54.0	60.0	8.0	4.5

1. All test data is referenced to 25°C ambient.
2. Isat is the DC current which cause the inductance drop 30% typical of its nominal inductance without current.
3. Ir is the DC current which cause the surface temperature of the part increase less than 40°C.
4. Operating temperature range : -55°C to 125°C.



DELTA ELECTRONICS, INC.

(TAOYUAN PLANT CPBG) 252, SAN YING ROAD, KUEISAN INDUSTRIAL ZONE, TAOYUAN SHIEN, 333, TAIWAN, R.O.C.

TEL: 886-3-3591968; FAX: 886-3-3591991

<http://www.deltawww.com>