

SMT Power Inductor (MOLDING TYPE)

MPT718H1 Type

Features

- RoHS compliant.
- Low profile , high current SMD type.
- Magnetically shielded, suitable for high density mounting.
- High energy storage and low DCR.
- Ideal for power source circuits, DC-DC converter, DC-AC inverters inductor applications.

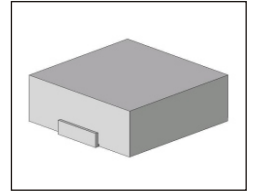

Mechanical Dimension:

RECOMMENDED PAD PATTERNS

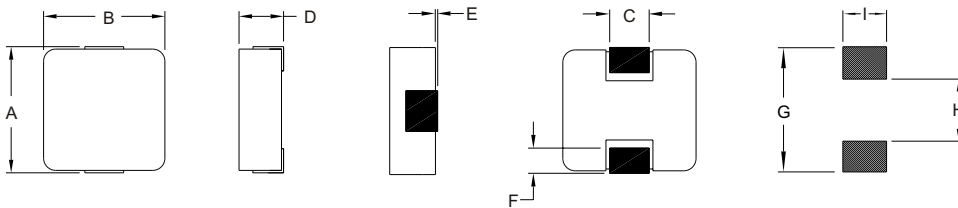

UNIT : mm/inch
 A = 7.40 / 0.291 Max.
 B = 6.80 / 0.268 Max.
 C = 3.00±0.30 / 0.118±0.012
 D = 1.80 / 0.071 Max.
 E = 0~0.15 / 0~0.006
 F = 1.60±0.30 / 0.063±0.012
 G = 8.40 / 0.331
 H = 3.70 / 0.146
 I = 3.50 / 0.138

Electrical Characteristics: 25°C: 100KHz, 0.25V

PART NO.	L0 (μ H)	DCR (m Ω) TYP.	DCR (m Ω) MAX.	Isat ² (Adc)	I _r ³ (Adc)
MPT718-R10H1	0.10	2.0	2.5	45.0	18.0
MPT718-R47H1	0.47	7.3	8.4	18.0	11.0
MPT718-R68H1	0.68	10.8	12.7	17.0	9.0
MPT718-1R0H1	1.00	14.5	17.0	14.0	7.0
MPT718-2R0H1	2.00	28.0	32.0	11.0	6.0
MPT718-2R2H1	2.20	31.0	35.0	13.0	6.0
MPT718-4R7H1	4.70	68.0	70.0	5.0	3.5

1. All test data is referenced to 25°C ambient.
2. Isat is the DC current which cause the inductance drop 30% typical of its nominal inductance without current.
3. Ir is the DC current which cause the surface temperature of the part increase less than 40°C.
4. Operating temperature range : -55°C to 125°C.



DELTA ELECTRONICS, INC.

(TAOYUAN PLANT CPBG) 252, SAN YING ROAD, KUEISAN INDUSTRIAL ZONE, TAOYUAN SHIEN, 333, TAIWAN, R.O.C.

TEL: 886-3-3591968; FAX: 886-3-3591991

<http://www.deltawww.com>