



TAI-SAW TECHNOLOGY CO., LTD.

No. 3, Industrial 2nd Rd., Ping-Chen Industrial District,
Taoyuan, 324, Taiwan, R.O.C.

TEL: 886-3-4690038 FAX: 886-3-4697532

E-mail: tstsales@mail.taisaw.com Web: www.taisaw.com

Approval Sheet For Product Specification

Issued Date:

Product Name: Differential SAW Filter 1120 MHz

TST Parts No.:TA0267A

Customer Parts No.:_____

Company: _____
Division: _____
Approved by : _____
Date: _____

Checked by: _____ Andy Lee

Approval by: _____ Francis Chen

Date: _____ 2002/3/7



TAI-SAW TECHNOLOGY CO., LTD.

No. 3, Industrial 2nd Rd., Ping-Chen Industrial District,
Taoyuan, 324, Taiwan, R.O.C.

TEL: 886-3-4690038 FAX: 886-3-4697532

E-mail: tstsales@mail.taisaw.com Web: www.taisaw.com

Differential SAW Filter 1120 MHz SMD 3X3mm

MODEL NO.: TA0267A

REV. NO.1

A. MAXIMUM RATING:

1. Operating Temperature: -10°C ~ +85°C
2. Storage Temperature: -40°C ~ +85°C

RoHS Compliant
Lead free
Lead-free soldering

B. Characteristics :

1. Balanced to Balanced operation
2. Terminating source impedance : $Z_s = 200 \Omega // 50 \text{ nH}$
3. Terminating load impedance : $Z_L = 200 \Omega // 30 \text{ nH}$

Characteristics	Value			Note
	Min.	Typ.	Max.	
Center frequency F_c MHz	-	1120	-	-
Insertion loss(1104~1136 MHz) I.L. dB	-	3.9	4.5	-
Ripple (1104~1136MHz) dB	-	0.8	1.5	-
PassBand Return Loss Differential	9	11		
Attenuation:(Reference level from 0 dB)				
1)1017<F<1048 MHz dB	50	55	-	-
2)1191<F<1222 MHz dB	43	46	-	-
3) 0<F<1017 MHz dB	50	55	-	-
4) $F_c-72<F<F_c-56$ MHz dB	40	60		
5) $F_c-56<F<F_c-50$ MHz dB	10	49	-	-
6) $F_c+46<F<F_c+56$ MHz dB	10	32	-	-
7) $F_c+56<F<F_c+70$ MHz dB	25	40	-	-
8) $F_c+70<F<F_c+2000$ MHz dB	40	56	-	-
9) 2000<F<3000 MHz dB	40	60	-	-
Group delay ripple(p-p) (1104~1136MHz) nS	-	9	15	

C. Frequency Characteristics :

1. Sdd21 Response

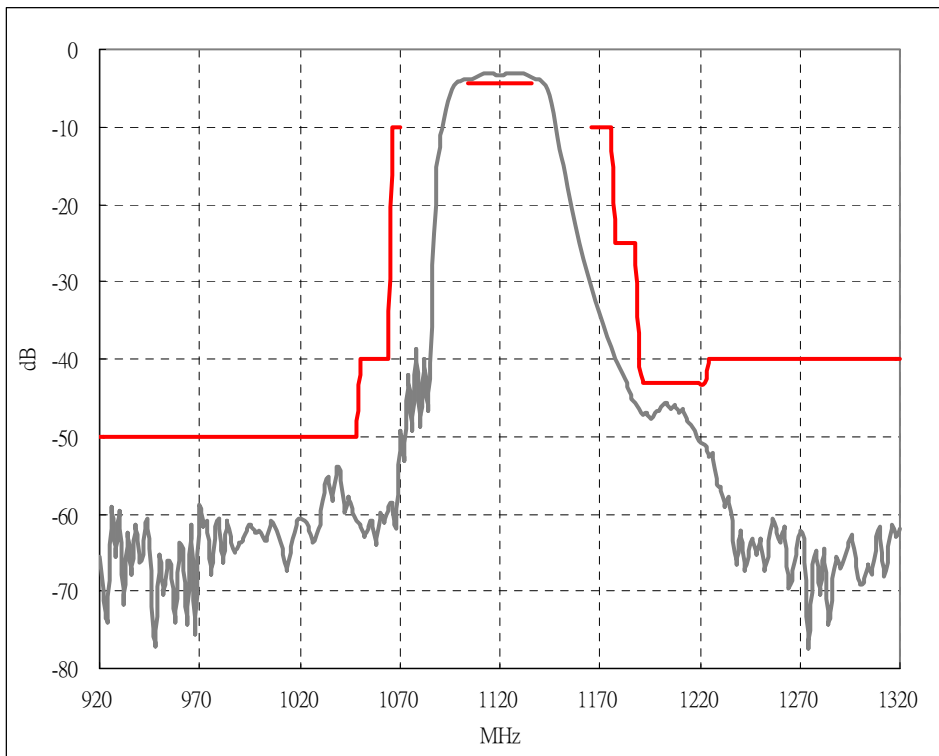

2. Sdd21 Response (Passband)

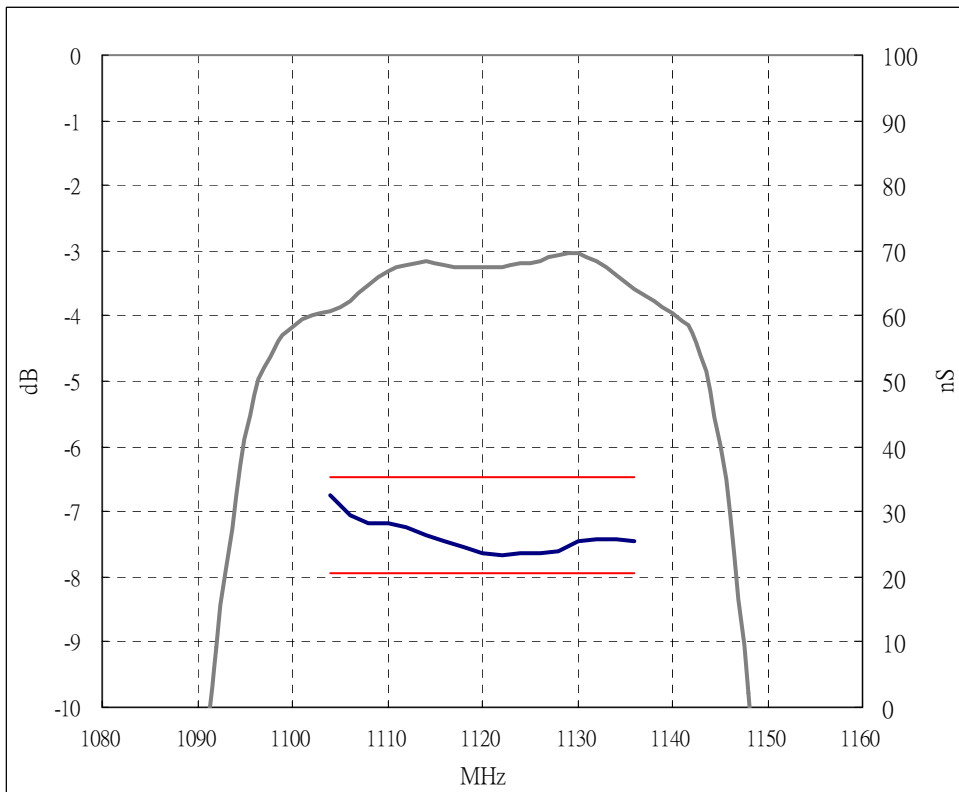

3. Sdd21 Response (wide band)

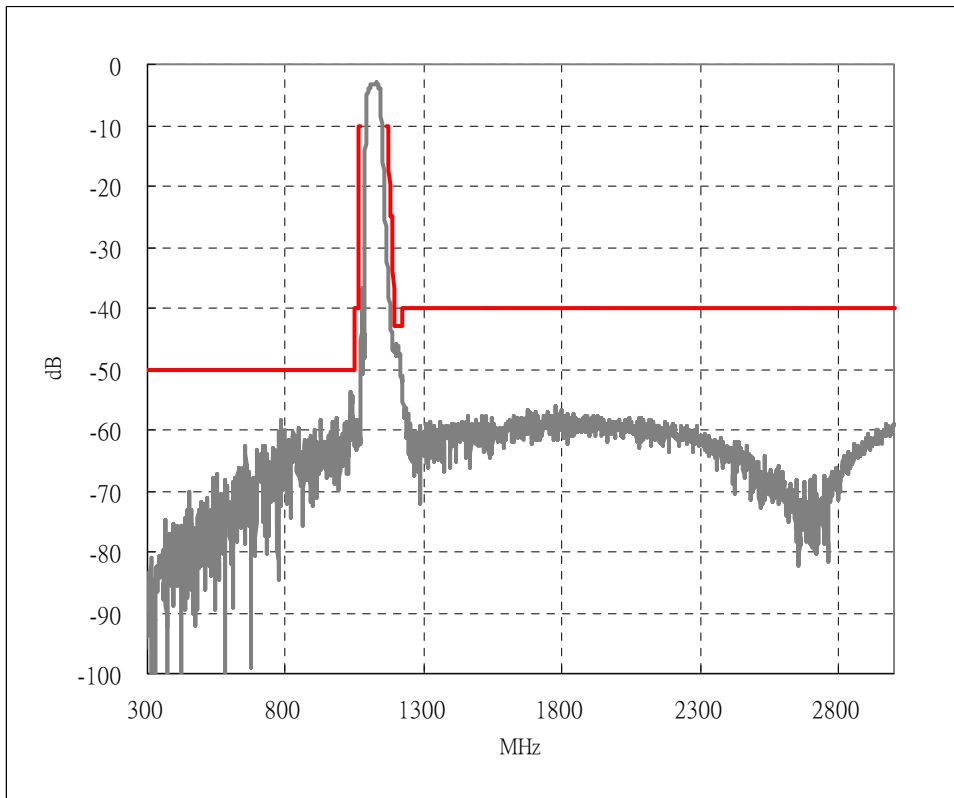

3. Return Loss

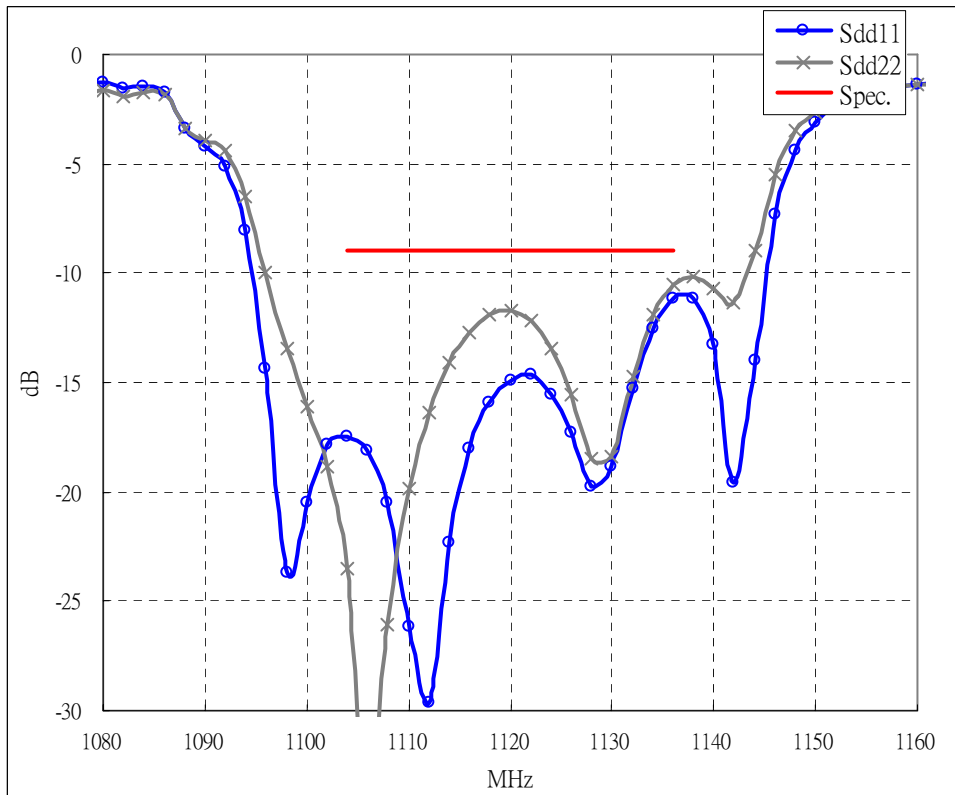

D. Measurement Circuit:

1. Balanced input 200 ohm and Balanced output 200 ohm

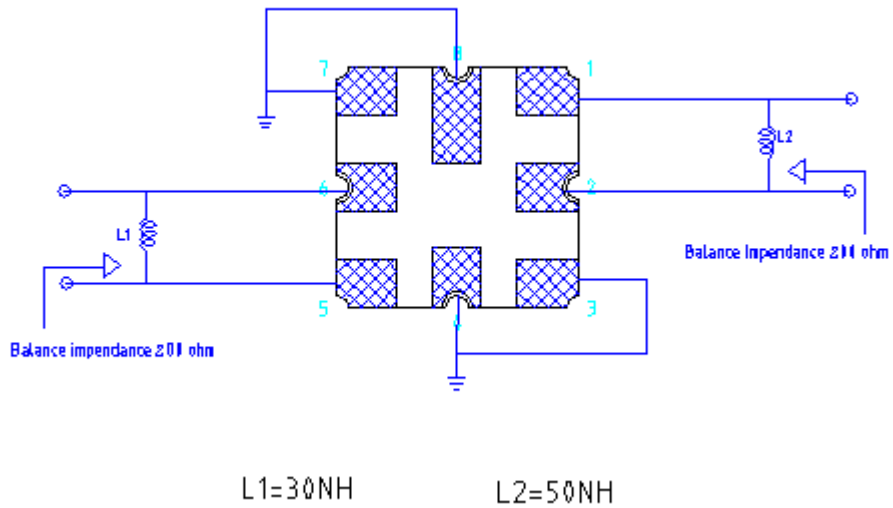

E. Outline Drawing:

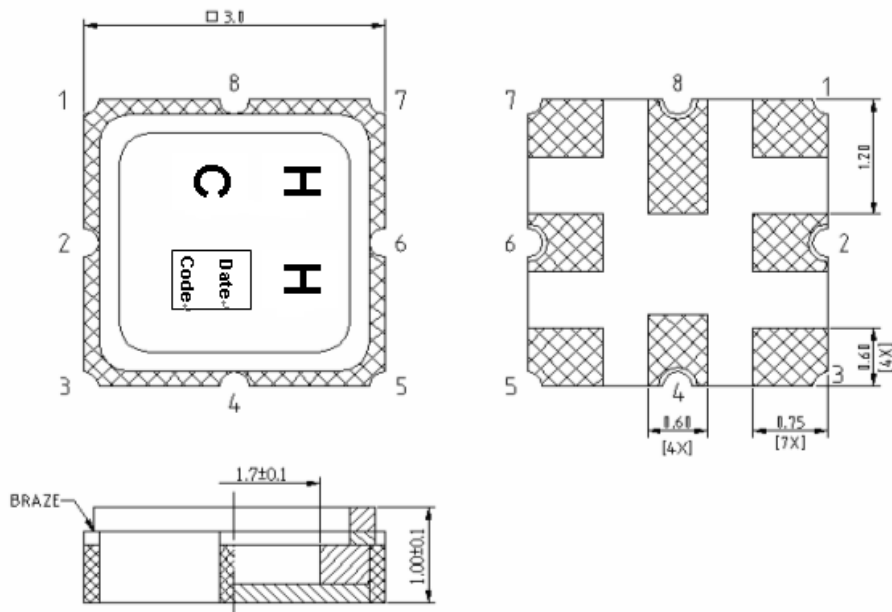

Pin 1, 2 : Differential Input
 Pin 5, 6 : Differential Output
 Pin 3,4,7,8 : Ground

F. PACKING:

1. REEL DIMENSION

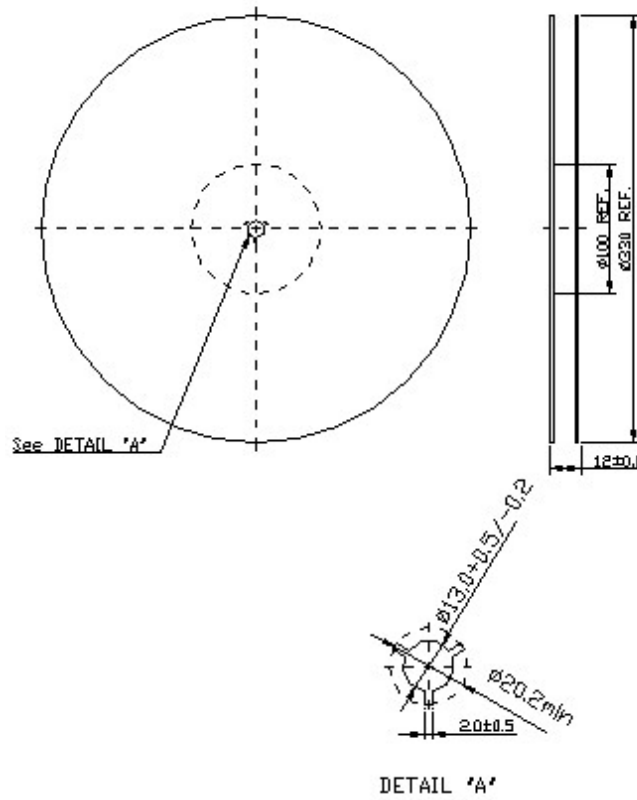

2. TAPE DIMENSION

