

FOR BOARD-TO-CABLE CONNECTION

240 SERIES (GENERAL-PURPOSE TYPE)

■ FEATURES

- 1.27 mm (0.050 in.) pitch contact arrangement in two rows enables high-density mounting.
- Connectors with 20 to 96 contacts are available for various purposes.
- Discrete-wire (AWG #28, #30) I/O cables can be assembled by I/O. Metal covers completely protect sockets from dirt.
- Bellows contacts insure stable contact preventing pins from bending. The bellows contacts also have excellent stability with repeated insertion and extraction.
- Tails are spaced in a four-row staggered arrangement (2.54 mm × 1.905 mm) (0.100 in. × 0.075 in.) for easy PC board design.
- Insulation is UL-approved (94V-0) and is flameable.
- An FCN-230 EMI cover and dust cap can be used together.

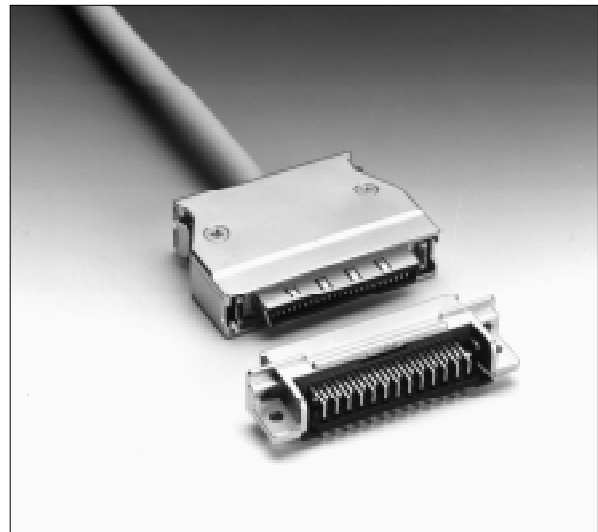

■ SPECIFICATIONS

Item	Specifications
Operating temperature range	-55°C to +105°C
Current rating	DC 1 A
Voltage rating	AC 240 V
Contact resistance	35 mΩ max. (DC 6 V, 0.1A)
Insulation resistance	1000 MΩ min. (DC 500 V)
Dielectric withstand voltage	AC 750 V for 1 minute
Insertion force (kg)	4.5 kg max. (20 pins)
Withdrawal force (kg)	0.6 kg min. (20 pins)
Applicable PC board	1.6 mm (0.063 in.) thick
Applicable wire (standard)	IDC: AWG #28 and #30 stranded wires with ϕ 0.5 to 0.88 mm (0.020 to 0.035 in.) insulation diameter. Soldering: AWG #26 max. (reference) (The applicable wires depend on the number of contacts. See the descriptions of IDC sockets and metal covers.)

■ MATERIALS

Item	Materials	
Insulation	Polyester (UL94V-0)	
Conductor	Copper alloy	
Plating	Contact	Gold plating
	Internal	Palladium plating

240 Series (General-Purpose Type)

■ ORDERING CODE

FCN-24 5 P 050-G / E

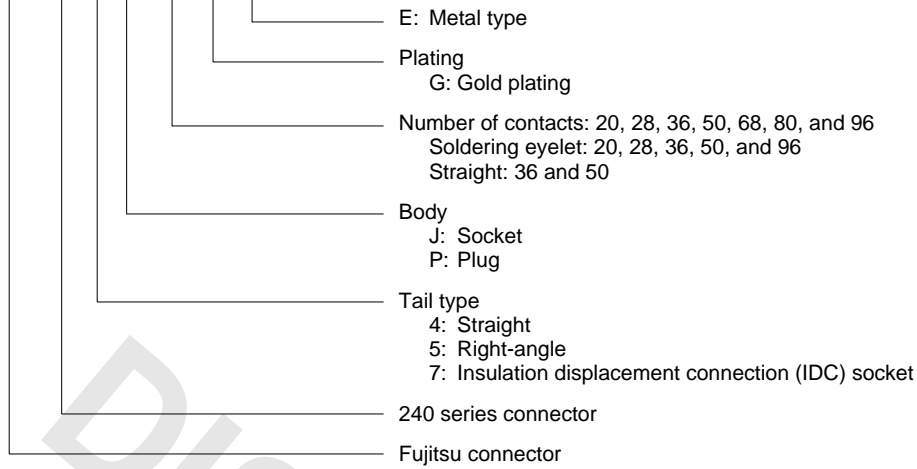

■ APPLICATIONS

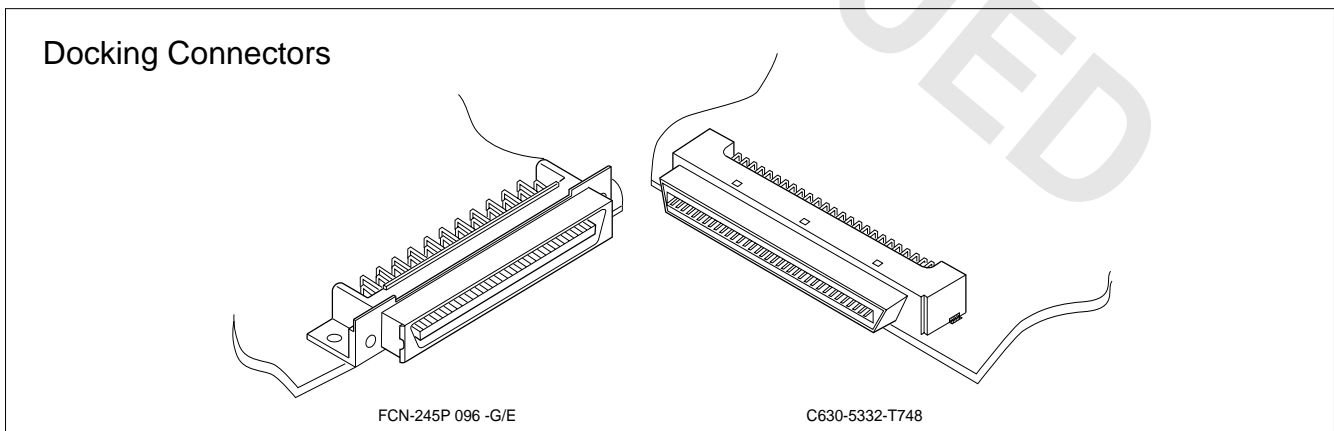
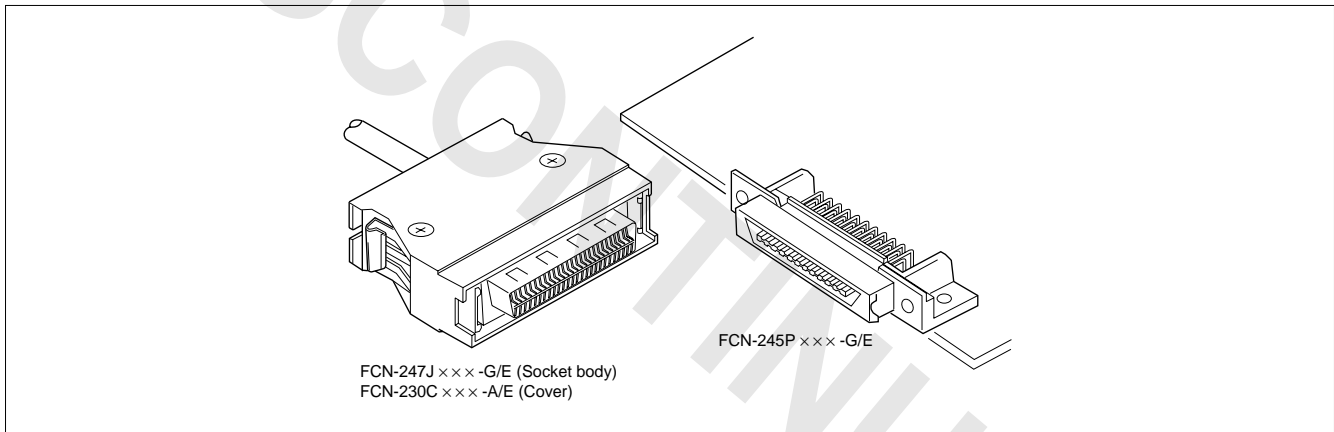

240 Series (General-Purpose Type)

RIGHT-ANGLE PLUG

■ DIMENSIONS

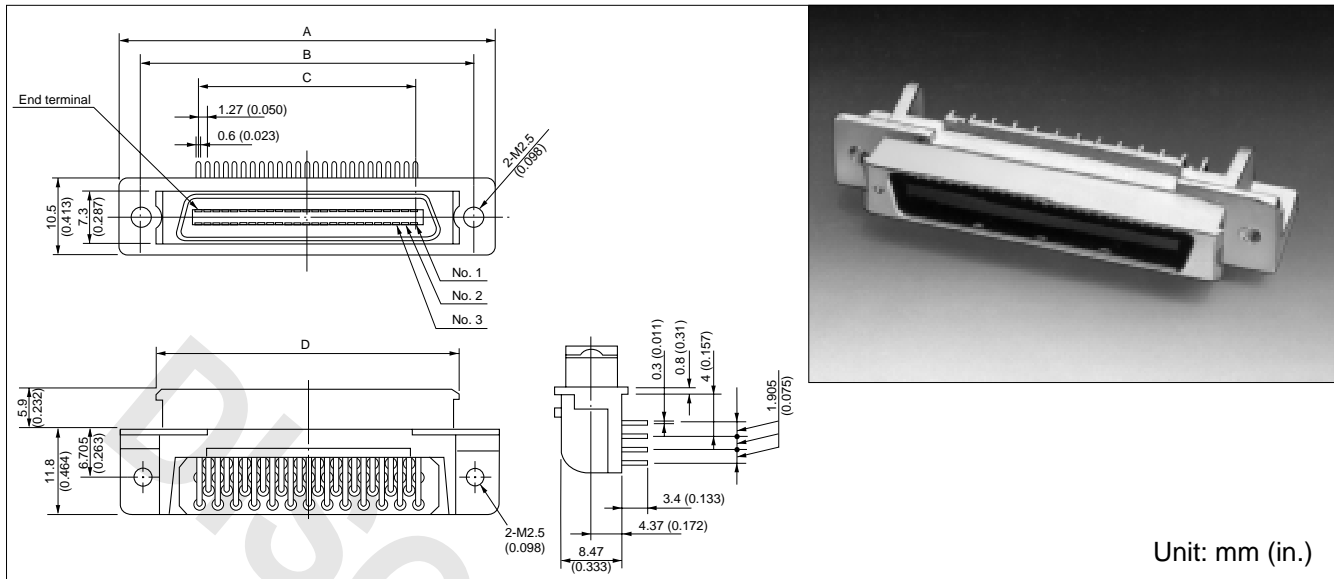

■ MOUNTING HOLE LAYOUT

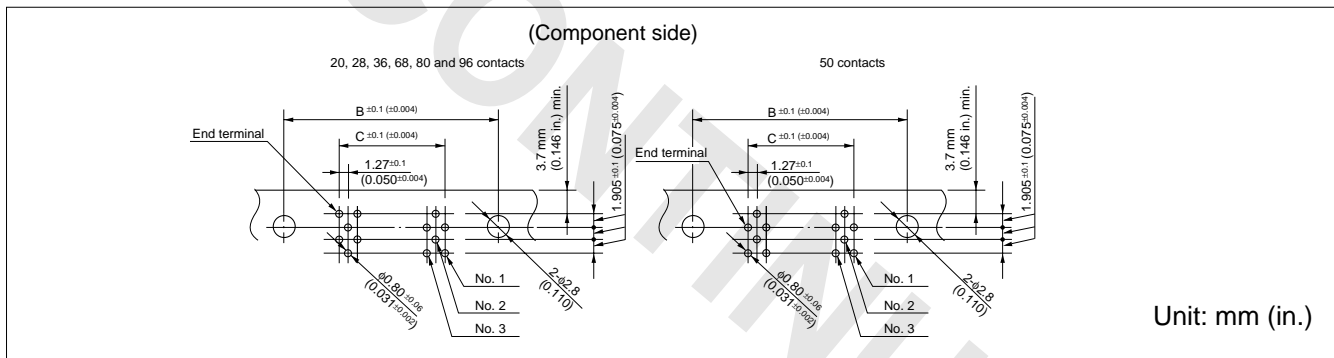

■ PANEL INHIBITED AREAS

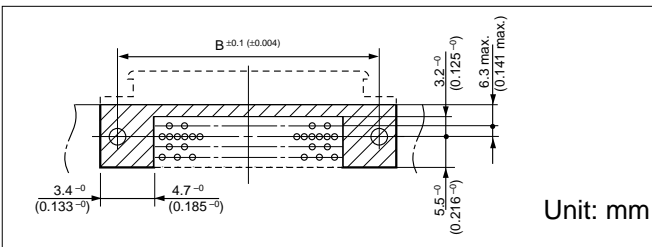

■ RECOMMENDED PANEL DIMENSIONS

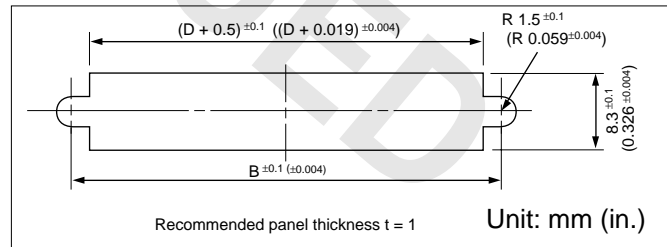

■ PART NUMBERS AND DIMENSIONS

Number of contacts	Part number	Dimensions: mm (in.)			
		A	B	C	D
20	FCN-245P020-G/E	33.40 (1.314)	27.40 (1.078)	11.43 (0.450)	23.30 (0.917)
28	FCN-245P028-G/E	38.48 (1.514)	32.48 (1.278)	16.51 (0.650)	28.38 (1.117)
36	FCN-245P036-G/E	43.56 (1.714)	37.56 (1.478)	21.59 (0.850)	33.46 (1.317)
50	FCN-245P050-G/E	52.45 (2.064)	46.45 (1.828)	30.48 (1.200)	42.35 (1.667)
68	FCN-245P068-G/E	63.88 (2.514)	57.88 (2.278)	41.91 (1.650)	53.78 (2.117)
80	FCN-245P080-G/E	71.50 (2.814)	65.50 (2.578)	49.53 (1.950)	61.40 (2.417)
96	FCN-245P096-G/E	81.66 (3.214)	75.66 (2.978)	59.69 (2.350)	71.56 (2.817)

This series includes connectors that will accept a panel thickness of 1.3 mm (0.051 in.). Specify a part number by replacing -G/E at the end with -G/D. Example: FCN-245D050-G/D*

240 Series (General-Purpose Type)

Fujitsu Components International Headquarter Offices

Japan

Fujitsu Component Limited
Gotanda-Chuo Building
3-5, Higashigotanda 2-chome, Shinagawa-ku
Tokyo 141, Japan
Tel: (81-3) 5449-7010
Fax: (81-3) 5449-2626
Email: promothq@ft.ed.fujitsu.com
Web: www.fcl.fujitsu.com

North and South America

Fujitsu Components America, Inc.
250 E. Caribbean Drive
Sunnyvale, CA 94089 U.S.A.
Tel: (1-408) 745-4900
Fax: (1-408) 745-4970
Email: marcom@fcai.fujitsu.com
Web: www.fcai.fujitsu.com

Europe

Fujitsu Components Europe B.V.
Diamantlaan 25
2132 WV Hoofddorp
Netherlands
Tel: (31-23) 5560910
Fax: (31-23) 5560950
Email: info.marketing@fceu.fujitsu.com
Web: www.fceu.fujitsu.com

Asia Pacific

Fujitsu Components Asia Ltd.
102E Pasir Panjang Road
#04-01 Citilink Warehouse Complex
Singapore 118529
Tel: (65) 6375-8560
Fax: (65) 6273-3021
Email: fcal@fcal.fujitsu.com
www.fcal.fujitsu.com

© 2001 Fujitsu Components America, Inc. All company and product names are trademarks or registered trademarks of their respective owners. Rev. 09/2002.