

DO NOT SCALE FROM THIS PRINT

STYLE	"A"	"B"	"C"
01BJ1	2.50 [.098]	3.50 [.138]	5.50 [.217]
02SJ1	3.50 [.138]	1.10 [.043]	6.00 [.236]
02RP1	1.30 [.051]	1.80 [.071]	5.00 [.197]
02SP1	3.00 [.118]	0.70 [.028]	6.50 [.256]
03SP1	2.10 [.083]	1.90 [.075]	2.50 [.098]
03RP1	1.30 [.051]	2.00 [.079]	4.80 [.189]

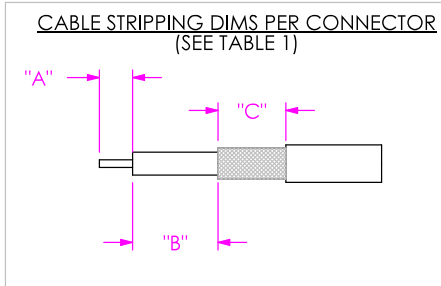

NOTES:

- ⊕ REPRESENTS A CRITICAL DIMENSION.
- CABLE CUT LENGTH = OAL - SUBTRACTOR FOR END 1 - SUBTRACTOR FOR END 2. (SEE TABLE 2 FOR SUBTRACTORS)
- RECOMMENDED CRIMPED DIMENSION FOR FERRULES IS 3.25 [.128] UNLESS SPECIFIED
- ⊕ ASSEMBLY TO BE 100% TESTED FOR OPENS & SHORTS.
- ⊕ ASSEMBLY TO BE 100% HI-POT TESTED AT 50V.
- CRITICALS TO BE CHECKED IN PROCESS.
- FINISHED ASSEMBLIES TO BE PACKAGED IN INDIVIDUAL POLY ZIPPER BAGS.
- CABLE STOCKED IN INCHES, 1 INCH = 25.4 MILLIMETERS.
- TO BE MEASURED FROM THE HIGHEST POINT ON THE SHELL TO THE HIGHEST ON THE PIN.

STYLE	SUBTRACTOR
01BJ1	9.96 [.392]
02SJ1	6.38 [.251]
02RP1	1.99 [.078]
02SP1	7.38 [.287]
03SP1	4.49 [.177]
03RP1	1.46 [.057]

LENGTH	TOLERANCE
0000-0050 [0-1.96]	1.0 [.040]
0050-0200 [1.96-7.87]	3.0 [.118]
0200-0500 [7.87-19.69]	5.0 [.197]
0500-1100 [19.69-43.30]	10.0 [.394]

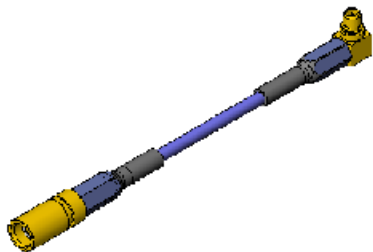

RF178-XXXXX-XXXXX-XXXX

CABLE CALL OUT
178: CCA-178

OVERALL CABLE LENGTH
MILLIMETERS OF CABLE**
0100 - 1100

** (SEE NOTE 8)

LEFT END CONNECTOR CALL OUT

- 01BJ1: SMA-J-C-H-ST-BH2
- 02SJ1: MCX-J-C-H-ST-CA2
- 02RP1: MCX-P-C-H-RA-CA2
- 02SP1: MCX-P-C-H-ST-CA2
- 03SP1: MMCX-P-C-H-ST-CA2
- 03RP1: MMCX-P-C-H-RA-CA2

RIGHT END CONNECTOR CALL OUT

- 01BJ1: SMA-J-C-H-ST-BH2
- 02SJ1: MCX-J-C-H-ST-CA2
- 02RP1: MCX-P-C-H-RA-CA2
- 02SP1: MCX-P-C-H-ST-CA2
- 03SP1: MMCX-P-C-H-ST-CA2
- 03RP1: MMCX-P-C-H-RA-CA2
- SING: SINGLE ENDED (ONE END ONLY)

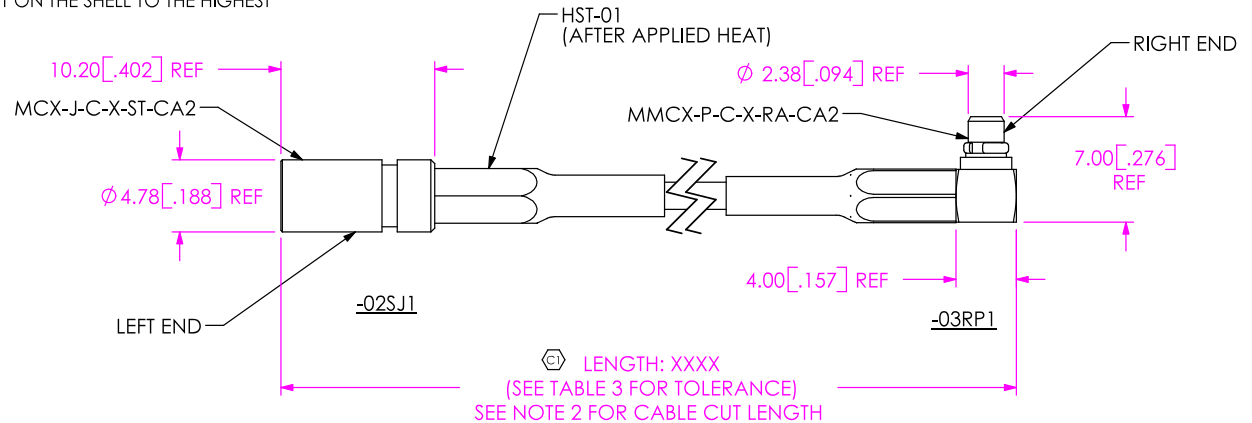

UNLESS OTHERWISE SPECIFIED, DIMENSIONS ARE IN MM.
TOLERANCES ARE:
DECIMALS ANGLES
.X: ± .3 [.01] 2°
.XX: ± .13 [.005]
.XXX: ± .051 [.0020]

PROPRIETARY NOTE
THIS DOCUMENT CONTAINS INFORMATION CONFIDENTIAL AND PROPRIETARY TO SAMTEC, INC. AND SHALL NOT BE REPRODUCED OR TRANSFERRED TO OTHER DOCUMENTS OR DISCLOSED TO OTHERS OR USED FOR ANY PURPOSE OTHER THAN THAT WHICH IT WAS OBTAINED WITHOUT THE EXPRESSED WRITTEN CONSENT OF SAMTEC, INC.

SAMTEC

520 PARK EAST BLVD, NEW ALBANY, IN 47150
* PHONE: 812.944.6733 FAX: 812.948.5047
e-Mail: INFO@SAMTEC.COM CODE: 55322

MATERIAL: DO NOT SCALE DRAWING SHEET SCALE: 2:1
INSULATOR:
CONTACT OR TERMINAL:



DESCRIPTION:
RF CABLE ASSEMBLY

DWG. NO.
RF178-XXXXX-XXXXX-XXXX

BY: TIM P. 5/6/2005 SHEET 1 OF 3

REVISION A

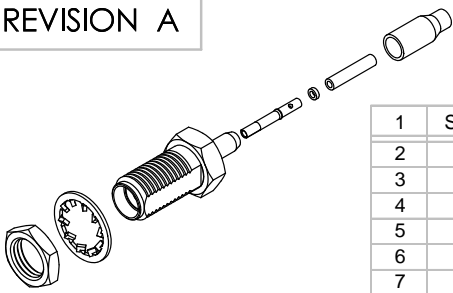

1	SUB-SMA-J-C-X-ST-BH2
2	SMA-PIN-003
3	SMA-WAS-001
4	SMA-NUT-001
5	MCX-FER-004
6	SMA-INS-001
7	SMA-FER-002

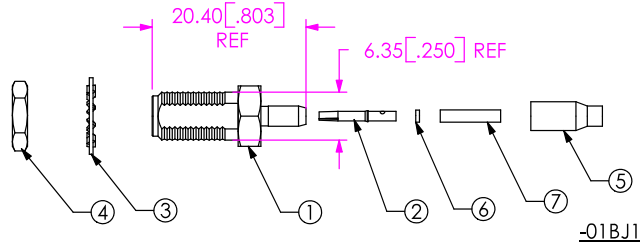

-01BJ1

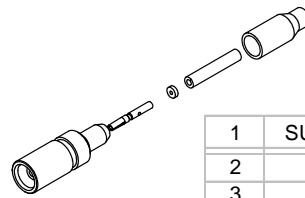

1	SUB-MCX-J-C-X-ST-CA2
2	MCX-FER-006
3	MCX-FER-004
4	MCX-PIN-004
5	MCX-INS-002
6	HST-01

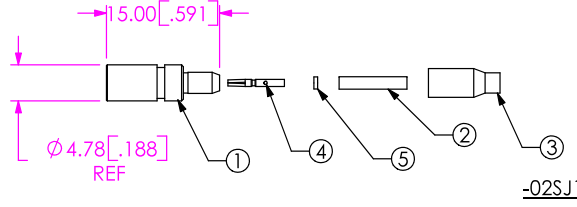

-02SJ1

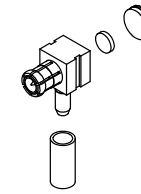

1	SUB-MCX-P-C-X-RA-CA2
2	MCX-FER-005
3	MCX-INS-001
4	MCX-CAP-002
5	HST-01

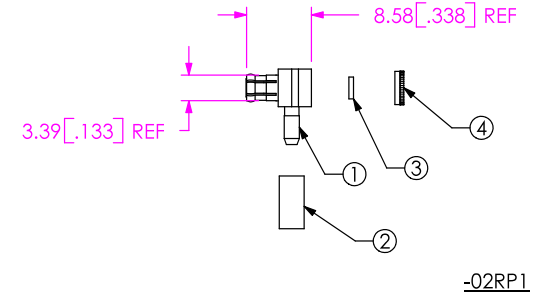

-02RP1

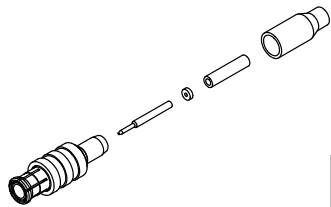

1	SUB-MCX-P-C-X-ST-CA2
2	MCX-FER-003
3	MCX-FER-004
4	MCX-INS-002
5	MCX-PIN-002
6	HST-01

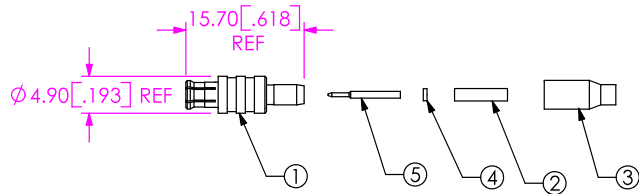

-02SP1

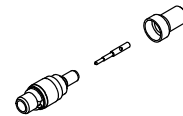

1	SUB-MMCX-P-C-X-ST-CA2
2	MMCX-FER-001
3	MMCX-PIN-002
4	HST-03

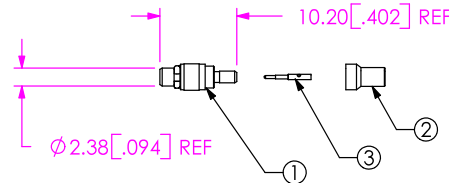

RECOMEDED CRIMP FOR -03SP1 IS 1.98 [.078]

-03SP1

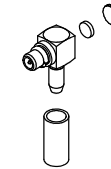

1	SUB-MMCX-P-C-X-RA-CA2
2	MMCX-INS-001
3	MMCX-CAP-001
4	MCX-FER-005
5	HST-01

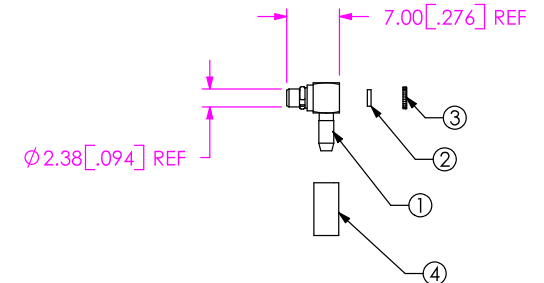

-03RP1

PROPRIETARY NOTE

THIS DOCUMENT CONTAINS INFORMATION CONFIDENTIAL AND PROPRIETARY TO SAMTEC, INC. AND SHALL NOT BE REPRODUCED OR TRANSFERRED TO OTHER DOCUMENTS OR DISCLOSED TO OTHERS OR USED FOR ANY PURPOSE OTHER THAN THAT WHICH IT WAS OBTAINED WITHOUT THE EXPRESSED WRITTEN CONSENT OF SAMTEC, INC.

DO NOT SCALE DRAWING

SHEET SCALE: 1:1

SAMTEC

520 PARK EAST BLVD, NEW ALBANY, IN 47150
 * PHONE: 812.944.6733 FAX: 812.948.5047
 e-Mail: INFO@SAMTEC.COM CODE: 55322

DESCRIPTION:
RF CABLE ASSEMBLY

DWG. NO.
RF178-XXXXX-XXXXX-XXXX

BY: TIM P. 5/6/2005 SHEET 2 OF 3

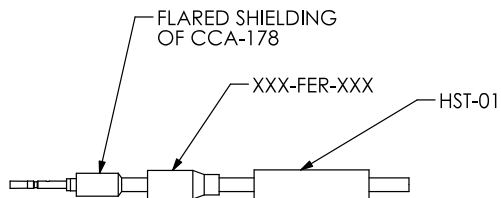

IN-PROCESS 1

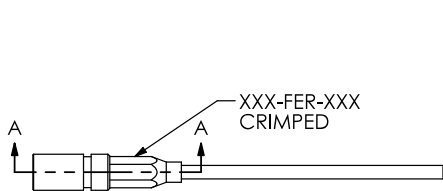
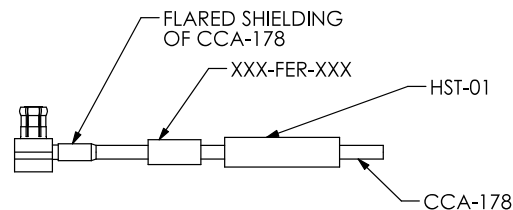

IN-PROCESS 2

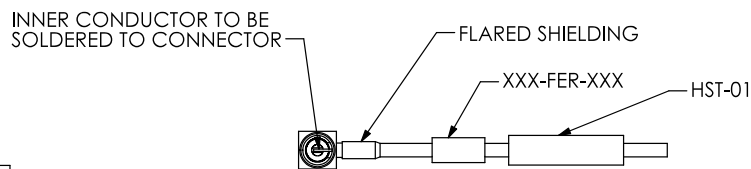

IN-PROCESS 2

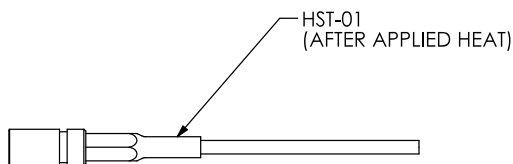

IN-PROCESS 3

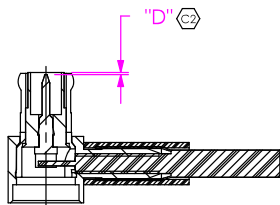
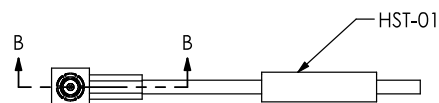

SECTION B-B
SCALE 2 : 1

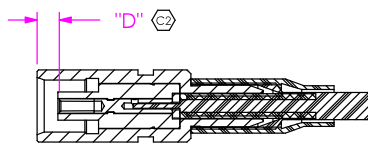

SECTION A-A
SCALE 2 : 1

F:\DWG\MISC\MKTG\RF178-XXXXX-XXXXX-MKT.SLDDRW

TABLE 4	
STYLE	"D"(SEE NOTE 9)
01SP1	.45 [.018] - .70 [.028]
01RP1	.45 [.018] - .70 [.028]
01BJ1	1.98 [.078] - 2.23 [.088]
02SJ1	1.38 [.054] - 1.63 [.064]
02RP1	0.00[.000] - .25 [.010]
02SP1	0.00[.000] - .25 [.010]
03SP1	0.00[.000] - .25 [.010]
03RP1	0.00[.000] - .25 [.010]

PROPRIETARY NOTE
THIS DOCUMENT CONTAINS INFORMATION CONFIDENTIAL AND PROPRIETARY TO SAMTEC, INC. AND SHALL NOT BE REPRODUCED OR TRANSFERRED TO OTHER DOCUMENTS OR DISCLOSED TO OTHERS OR USED FOR ANY PURPOSE OTHER THAN THAT WHICH IT WAS OBTAINED WITHOUT THE EXPRESSED WRITTEN CONSENT OF SAMTEC, INC.

DO NOT SCALE DRAWING
SHEET SCALE: 1:1

SAMTEC
520 PARK EAST BLVD, NEW ALBANY, IN 47150
* PHONE: 812.944.6733 FAX: 812.948.5047
e-Mail: INFO@SAMTEC.COM CODE: 55322

DESCRIPTION:
RF CABLE ASSEMBLY
DWG. NO.
RF178-XXXXX-XXXXX-XXXX
BY: TIM P. 5/6/2005 SHEET 3 OF 3