

SM Series — Surface Mount - General Purpose/Precision Wirewound

Features

- High temperature molded encapsulation
- Flex termination for absorbing thermal expansion
- All welded construction
- Tinned copper terminals
- Available in non-inductive styles



Electrical Specifications

Type	Power Rating (Watts) @ 70°C	Maximum Working Voltage	Resistance Temperature Coefficient	Ohmic Range and Tolerance
				.1%, .5%, 1% & 5%
SM1	1.0 W	25.0	±100 ppm/°C ± 20 ppm/°C	0.01Ω – 10Ω* 10 Ω – 1K
SM2	2.0 W	50.0	±100 ppm/°C ± 20 ppm/°C	0.01Ω – 10Ω* 10 Ω – 1K
SM2A	2.0 W	60.0	±100 ppm/°C	0.01Ω – 10Ω*
SM3	3.0 W	100.0	±100 ppm/°C ± 20 ppm/°C	0.01Ω – 10Ω* 10 Ω – 3K

* Zero ohm available on all sizes

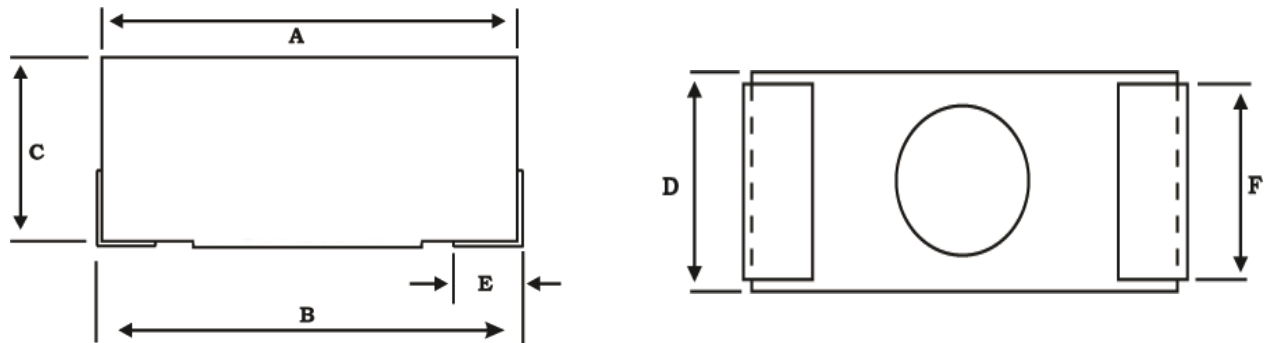

Mechanical Specifications

Type	A Body Length	B Total Length	C Body Height	D Body Width	E Termination Width	F Termination Length	Units
Tolerance	±0.015	±0.032	±0.015	±0.015	±0.015	±0.015	
	±0.4	±0.81	±0.4	±0.4	±0.4	±0.4	
SM1	.260 6.6	.280 7.1	.140 3.6	.150 3.8	.090 2.3	.100 2.5	inches mm
SM2	.410 10.4	.435 11.1	.180 4.6	.240 6.1	.100 2.5	.115 2.9	inches mm
SM2A	.475 12.1	.500 12.7	.140 3.6	.305 7.8	.110 2.8	.115 2.9	inches mm
SM3	.629 16.0	.708 18.0	.256 6.5	.276 7.0	.110 2.8	.115 2.9	inches mm

How to Order

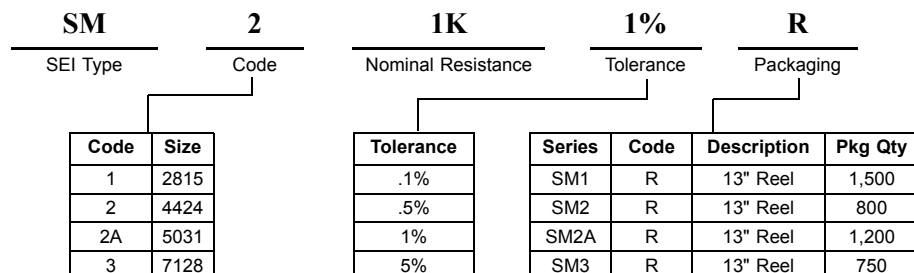

SM Series — Surface Mount - General Purpose/Precision Wirewound

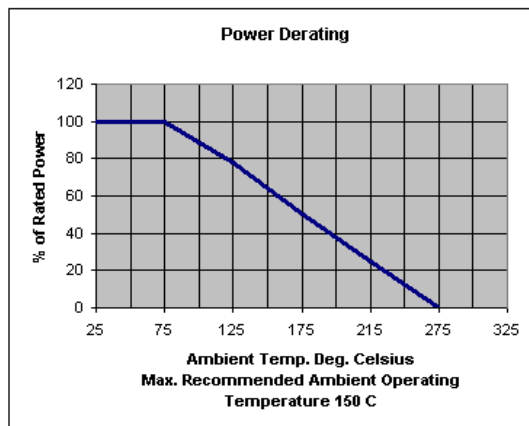

Performance Characteristics	
Test	Maximum Results
Load Life	1% Maximum
Short Time Overload	.5% Maximum
Temperature Cycling	.5% Maximum
Moisture Resistance	1% Maximum