

THIS DRAWING CONTAINS INFORMATION PROPRIETARY TO POSITRONIC AND ITS SUBSIDIARIES. POSITRONIC BELIEVES THE DATA ON THIS DRAWING TO BE RELIABLE. SINCE THE TECHNICAL INFORMATION IS GIVEN FREE OF CHARGE, THE USER EMPLOYS SUCH INFORMATION AT HIS OWN DISCRETION AND RISK. POSITRONIC ASSUMES NO RESPONSIBILITY FOR RESULTS OBTAINED OR DAMAGES INCURRED FROM USE OF SUCH INFORMATION IN WHOLE OR IN PART.

DATE	REV	REVISION RECORD	APP	DR	CK
2-23-06	NC	ECO 25554	TK	YK	TK
3-9-10	A	ECO 32213	COLE	ME	COLE

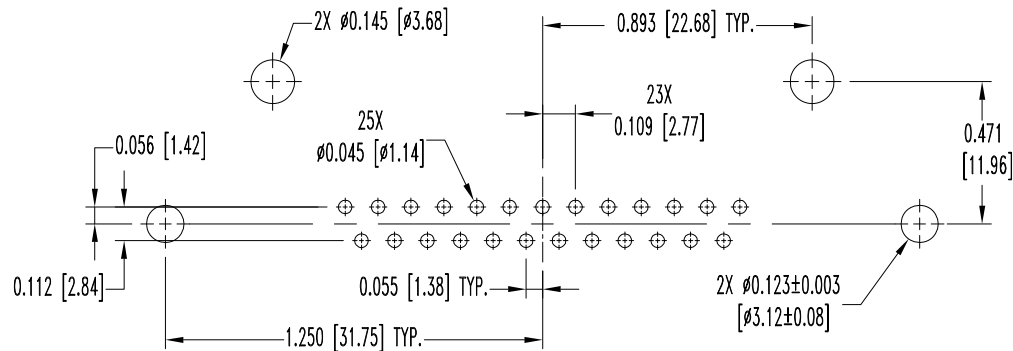
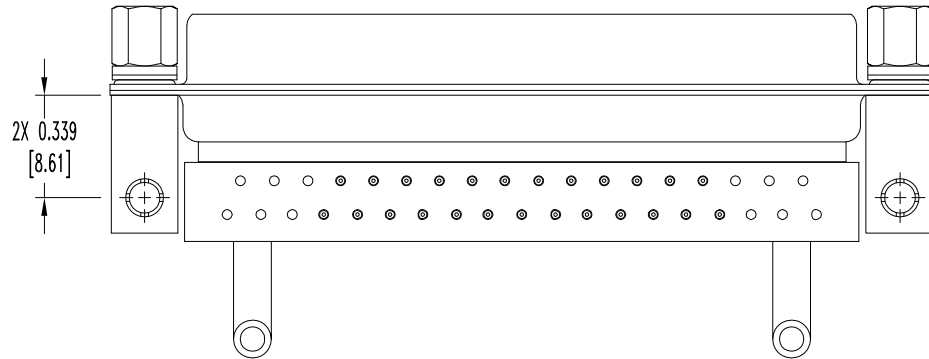
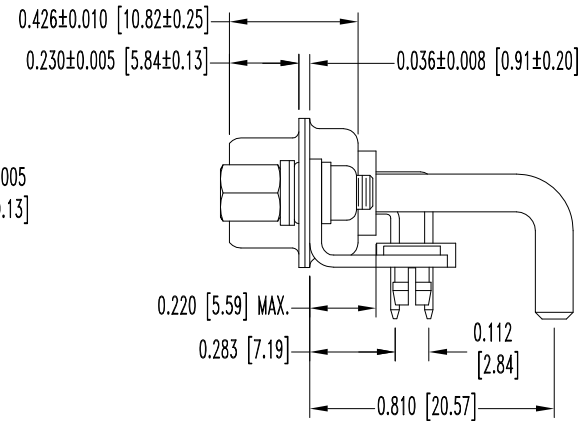
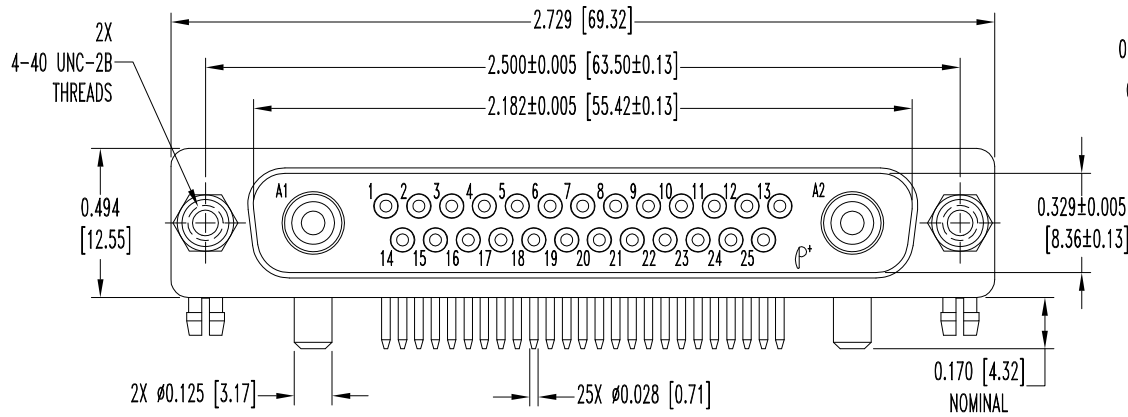

CONTACT HOLE PATTERN

NOTES:

- MATERIALS AND FINISHES:  
 INSULATOR: GLASS FILLED POLYESTER PER ASTM D5927, UL 94V-0, BLUE COLOR.  
 SIGNAL CONTACTS: PRECISION MACHINED BRASS ALLOY, WITH GOLD FLASH OVER NICKEL.  
 POWER CONTACTS: MACHINED OF HIGH CONDUCTIVITY COPPER ALLOY, WITH GOLD FLASH OVER NICKEL.  
 SHELLS: STEEL, ZINC PLATE WITH CHROMATE SEAL.  
 MOUNTING BRACKETS: BRASS, ZINC PLATE WITH CHROMATE SEAL.  
 PUSH ON FASTENERS: BERYLLIUM COPPER, TIN PLATE.  
 JACKSCREWS: STEEL, ZINC PLATE WITH CHROMATE SEAL.  
 WASHERS: BRASS, ZINC PLATE WITH CHROMATE SEAL.
- DETAILED PRODUCT, ELECTRICAL, AND MECHANICAL INFORMATION IS AVAILABLE IN THE LATEST CBD PRODUCT PUBLICATION. VISIT [CONNECTPOSITRONIC.COM/PRODUCTS/1/STANDARDENSITYCOMBO](http://CONNECTPOSITRONIC.COM/PRODUCTS/1/STANDARDENSITYCOMBO) -D/ OR [CONNECTPOSITRONIC.COM](http://CONNECTPOSITRONIC.COM)
- CONNECTORS ARE ROHS COMPLIANT PER ROHS DIRECTIVE 2002/95/EC OF 27 JAN 2003.
- DIMENSIONS ARE IN INCHES [MILLIMETERS].

 <b>POSITRONIC INDUSTRIES INC.</b> www.connectpositronic.com		FSCM 28198	
		DECIMAL TOL. ± 0.015 [0.38]	CBD SERIES
TITLE CBD27W2M57R8NT20/AA		APPROVED BY TK	
ANGULAR TOL. ± 5°	DATE 2-23-06	DRAWING NUMBER SK7087	REV. A