

DIP 2.54mm ZIF Prototype Socket

NP63 Series



32-Pin

ORDERING INFORMATION

P/N: NP63-16 03-S 4-*

- 1: Straight Handle
 - 2: Formed Handle
 - 3: 300 mil Row Space
 - 6: 600 mil Row Space
- Pin Count

CHARACTERISTICS

Insulation Resistance	1,000MΩ Min.
Breakdown Voltage	700VAC
Contact Resistance	20mΩ Max.
Rated Current	1A Per Contact
Operating Temp. Range	-10°C to +70°C
Durability	20 Cycles

MATERIAL

Insulator	High-Temperature, Thermoplastic UL94V-0 Rated
Contact	Copper Alloy
Handle	Stainless Steel

PLATING

Contact	Solder Plate
Handle	Chrome

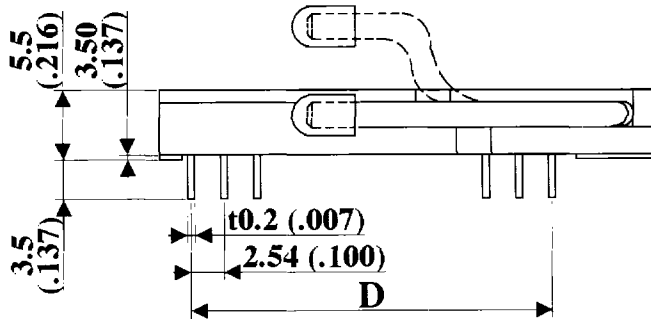
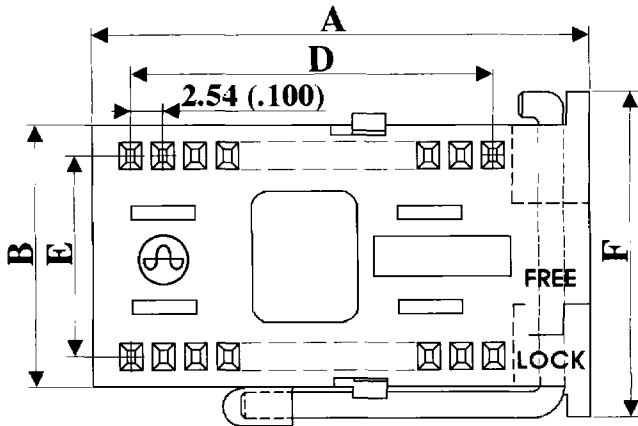

Recommended PCB Layout

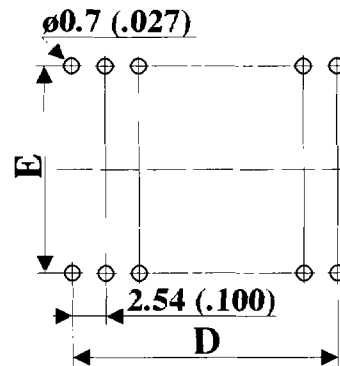

Part Number	Pin Count	A	B	D	E	F
NP63-1403-S4-1	14	27.92 (1.099)	12.60 (0.496)	15.24 (0.600)	7.62 (0.300)	17.60 (0.692)
NP63-1603-S4-1	16	27.92 (1.099)	12.60 (0.496)	17.78 (0.700)	7.62 (0.300)	17.60 (0.692)
NP63-2406-S4-1	24	38.08 (1.499)	20.22 (0.796)	27.94 (1.100)	15.24 (0.600)	25.22 (0.992)
NP63-2806-S4-1	28	43.16 (1.699)	20.22 (0.796)	33.02 (1.300)	15.24 (0.600)	25.22 (0.992)
NP63-3206-S4-1	32	48.24 (1.899)	20.22 (0.796)	38.10 (1.500)	15.24 (0.600)	25.22 (0.992)
NP63-4006-S4-1	40	58.40 (2.299)	20.22 (0.796)	48.26 (1.900)	15.24 (0.600)	25.22 (0.992)
NP63-4806-S4-1	48	68.56 (2.699)	20.22 (0.796)	58.42 (2.300)	15.24 (0.600)	25.22 (0.992)